

## 1985 KL600 PARTS DIAGRAM

CLUTCH

E1350-0114

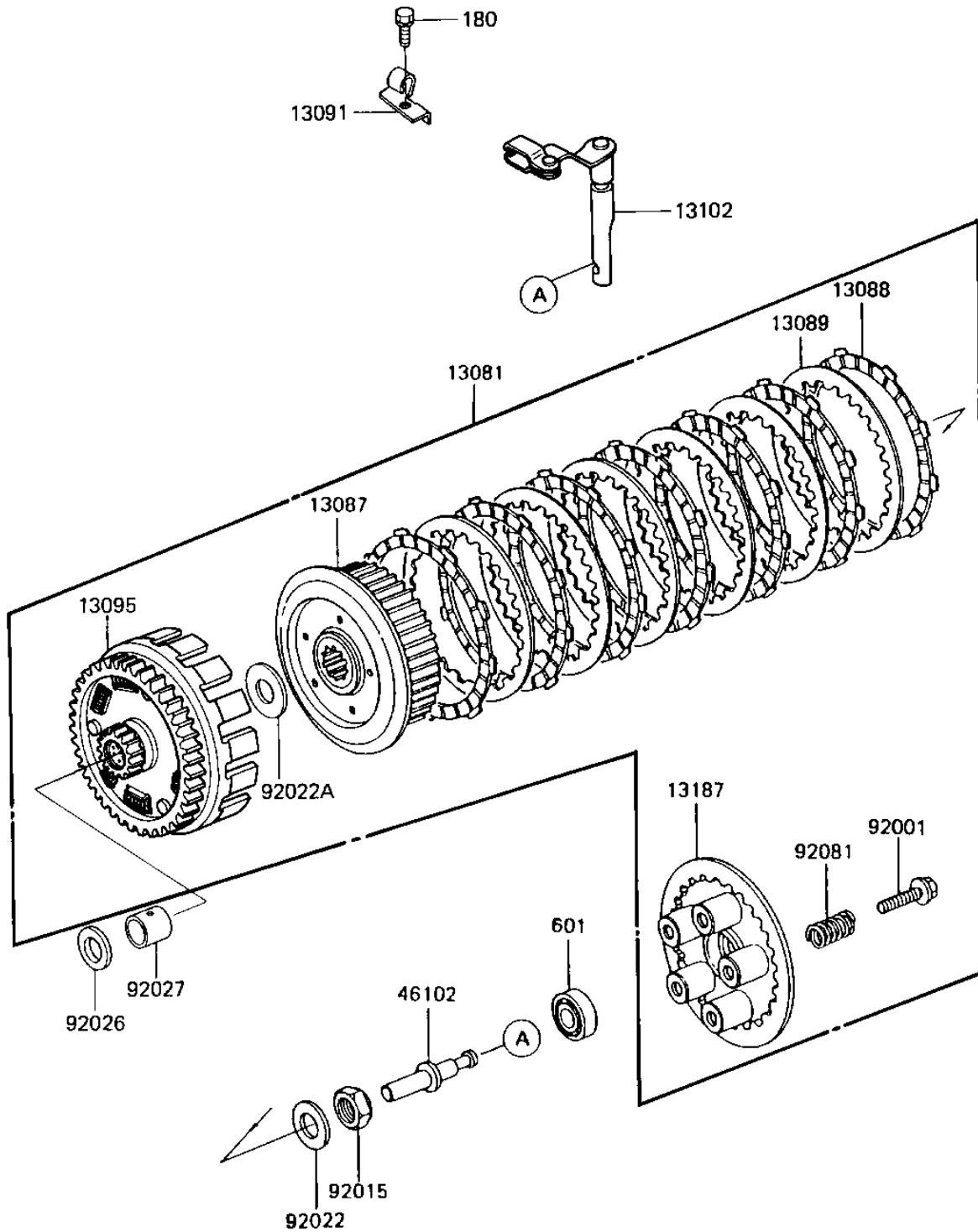

## 1985 KL600 PARTS LIST

### CLUTCH

ITEM NAME	PART NUMBER	QUANTITY
CLUTCH-ASSY (Ref # 13081)	13081-1193	1
HUB-CLUTCH (Ref # 13087)	13087-1052	1
PLATE,CLUTCH FRICTION (Ref # 13088)	13088-040	1
PLATE,CLUTCH STEEL (Ref # 13089)	13089-026	1
HOLDER,CLUTCH CABLE (Ref # 13091)	13091-1257	1
HOUSING-COMP-CLUTCH (Ref # 13095)	13095-1124	1
RELEASE-COMP-CLUTCH (Ref # 13102)	13102-1074	1
PLATE-CLUTCH OPERATIN (Ref # 13187)	13187-1012	1
ROD (Ref # 46102)	46102-1030	1
BOLT,CLUTCH SPR FITT (Ref # 92001)	92001-1066	1
NUT,20MM (Ref # 92015)	92015-1555	1
WASHER,PLAIN,2.3X20.3 (Ref # 92022)	92022-1116	1
WASHER,25.5X52.6X2 (Ref # 92022A)	92022-1476	1
SPACER,25.1X38X4 (Ref # 92026)	92026-1206	1
COLLAR,25X30X29.2 (Ref # 92027)	92027-1684	1
SPRING,CLUTCH (Ref # 92081)	92081-1864	1
BOLT-UPSET-WS (Ref # 180)	180J0612	1
BEARING-BALL (Ref # 601)	92045-1235	1