

# 1984 Police PARTS DIAGRAM

GASKET KIT

## Gasket kit

**KLT200-C 1983 & UP    KLT250-C 1983 & UP**

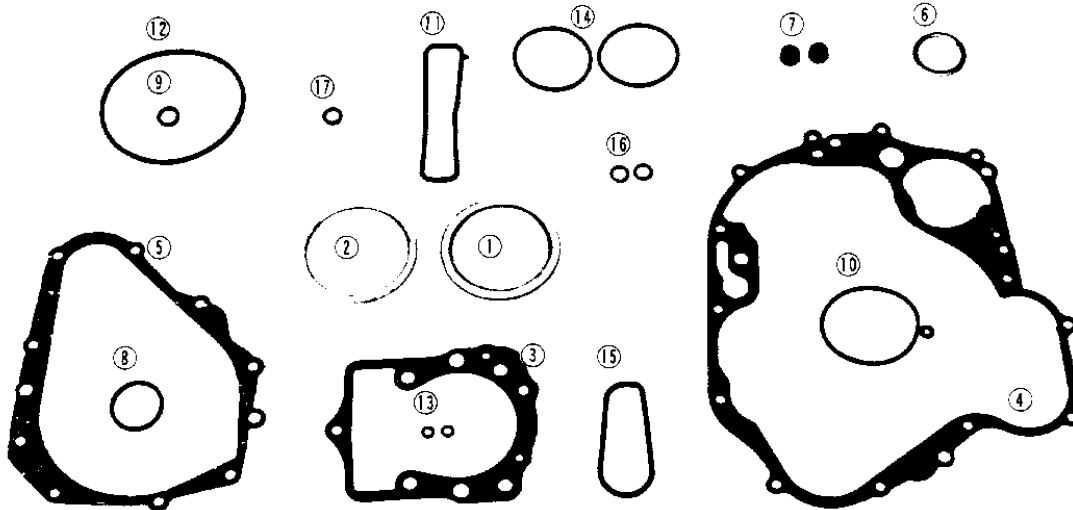

IDENT. NO.	DESCRIPTION	PART NO.	11028-1076 Complete Kit (QTY.)
1	Gasket-Head, Cylinder (KLT250-C)	11004-1002	1
2	Gasket-Head, Cylinder (KLT200-C)	11004-1004	1
3	Gasket, Cylinder Base	11009-043	1
4	Gasket, Clutch Cover	11009-1306	1
5	Gasket, Generator Cover	14045-031	1
6	Gasket, Exhaust Pipe Holder	18067-004	1
7	Seal-Oil, RV37129.5, Valve Stem	92049-016	2
8	Ring-O, 31.5 x 2.6, Oil Filler Cap	92055-049	1
9	Ring-O, Oil Filter Cover	92055-098	1
10	Ring-O, Oil Filter Cover	92055-1048	1
11	Ring-O, Chain Tunnel	92055-105	1
12	Ring-O, 99mm, Camshaft Cover	92055-107	1
13	Ring-O, 5.6mm, Generator Cap Bolt	92055-109	2
14	Ring-O, 53.5mm, Rocker Cap	92055-112	2
15	Ring-O, Generator Cap	92055-1143	1
16	Ring-O, 10mm, Cylinder Head Bolt	92055-1149	2
17	Ring-O, 8mm, Cylinder Head Oil Line	92055-1150	1
Kit includes			17 items: 21 pcs.

Note: All Part No.'s shown reflect latest P/N at printing – Feb. 1984

# 1984 Police PARTS LIST

## GASKET KIT

ITEM NAME	PART NUMBER	QUANTITY
GASKET,CYLINDER HEAD (Ref # 1)	11004-1002	1
GASKET,CYLINDER HEAD (Ref # 2)	11004-1004	1
GASKET,CYLINDER BASE (Ref # 3)	11009-043	1
GASKET,CLUTCH COVER (Ref # 4)	11009-1306	1
GASKET,L.H ENGINE COV (Ref # 5)	14045-031	1
GASKET,EXHAUST PIPE H (Ref # 6)	11009-1866	1
OIL SEAL,RV37129.5 (Ref # 7)	92049-016	2
"O" RING,31MM (Ref # 8)	92055-049	1
"O" RING (Ref # 9)	92055-098	1
"O" RING,FILTER COVER (Ref # 10)	92055-1048	1
"O" RING (Ref # 11)	92055-105	1
"O" RING,99M/M (Ref # 12)	92055-107	1
"O" RING,DYNAMO COVER (Ref # 13)	92055-109	2
"O" RING,53.5MM (Ref # 14)	92055-112	2
RING-O (Ref # 15)	92055-1143	1
RING-O,10MM (Ref # 16)	92055-1149	2
O RING,10MM (Ref # 17)	92055-1150	1