

1984 Prairie PARTS DIAGRAM

ROCKER ARMS/VALVES ('84-'85 C2/C3)

E1210-0018

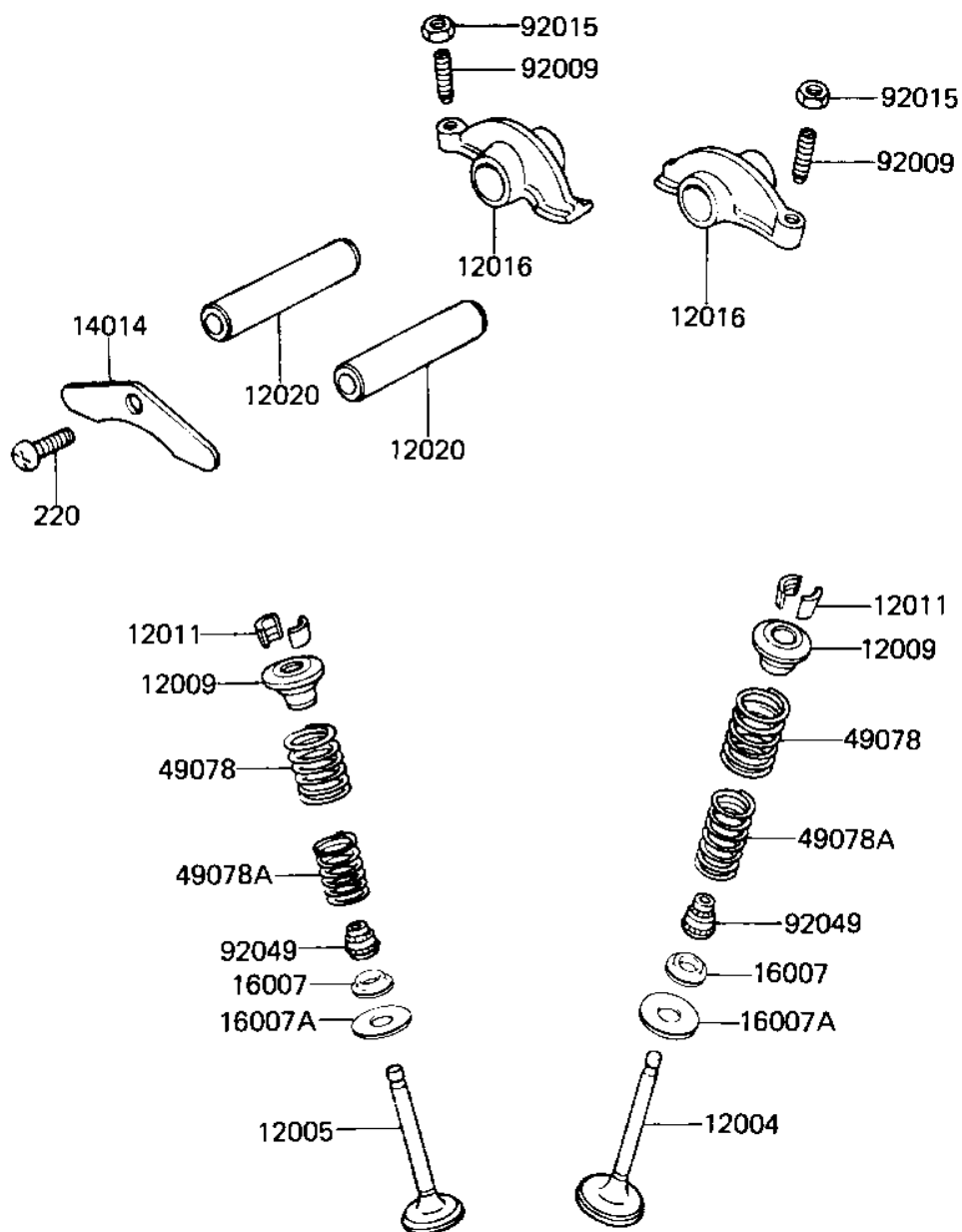

- 1
- 1
- 1
- 1
- 1
- 1
- 1
- 1
- 1
- 4
- 4
- 9
- 9
- 9

1984 Prairie PARTS LIST

ROCKER ARMS/VALVES ('84-'85 C2/C3)

ITEM NAME	PART NUMBER	QUANTITY
VALVE,INLET (Ref # 12004)	12004-1006	1
VALVE,EXHAUST (Ref # 12005)	12005-1005	1
RETAINER,VALVE SPRING (Ref # 12009)	12009-006	2
SPLIT KEEPER (Ref # 12011)	12011-004	4
ARM,ROCKER (Ref # 12016)	12016-012	2
SHAFT,ROCKER ARM (Ref # 12020)	12020-004	2
PLATE,POSITIONING (Ref # 14014)	14014-034	1
SEAT-SPRING,INNER (Ref # 16007)	16007-1045	2
SEAT-SPRING,OUTER (Ref # 16007A)	16007-1046	2
SPRING,OUTER VALVE (Ref # 49078)	12007-013	2
SPRING,INNER VALVE (Ref # 49078A)	12007-014	2
SCREW,SLOTTED,ROCKER (Ref # 92009)	92013-009	2
NUT,ROCKER ARM FITTNG (Ref # 92015)	92016-061	2
OIL SEAL,RV37129.5 (Ref # 92049)	92049-016	2
SCREW PAN HEAD 6X10 (Ref # 220)	220B0610	1