

1984 GPz PARTS DIAGRAM

THROTTLE ASSY

E1510-0014 -
-

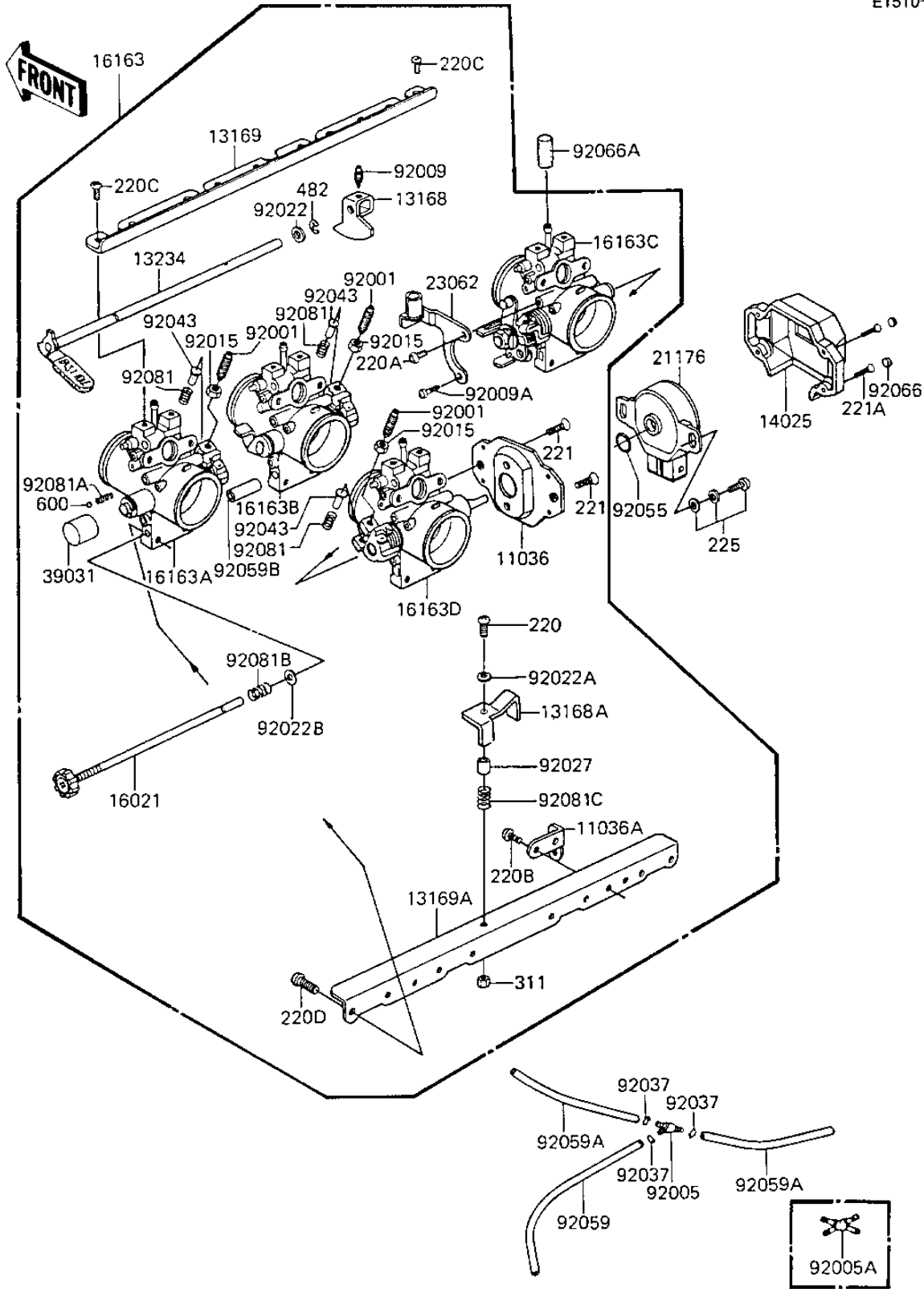

1984 GPz PARTS LIST

THROTTLE ASSY

| ITEM NAME | PART NUMBER | QUANTITY |
|--------------------------------------|-------------|----------|
| BRACKET-A,THROTTLE SE (Ref # 11036) | 11036-1481 | 1 |
| BRACKET-A,STAY LWR (Ref # 11036A) | 11036-1491 | 1 |
| LEVER,FAST IDLE (Ref # 13168) | 13168-1118 | 1 |
| LEVER,IDLING LINK (Ref # 13168A) | 13168-1218 | 1 |
| PLATE,THROTTLE STAY,U (Ref # 13169) | 13169-1521 | 1 |
| PLATE,THROTTLE STAY (Ref # 13169A) | 13169-1727 | 1 |
| SHAFT-COMP,FAST IDLE (Ref # 13234) | 13234-1008 | 1 |
| COVER,THROTTLE SENSOR (Ref # 14025) | 14025-1753 | 1 |
| SCREW-THROTTLE STOP (Ref # 16021) | 16021-1044 | 1 |
| THROTTLE-ASSY (Ref # 16163) | 16163-1025 | 1 |
| THROTTLE-ASSY,LH,OUTS (Ref # 16163A) | 16163-1026 | 1 |
| THROTTLE-ASSY,LH,INSI (Ref # 16163B) | 16163-1027 | 1 |
| THROTTLE-ASSY,RH,INSI (Ref # 16163C) | 16163-1028 | 1 |
| THROTTLE-ASSY,RH,OUTS (Ref # 16163D) | 16163-1029 | 1 |
| SENSOR,THROTTLE (Ref # 21176) | 21176-1004 | 1 |
| BRACKET-COMP,TH CABLE (Ref # 23062) | 23062-1026 | 1 |
| CAP-END,CARBURETOR (Ref # 39031) | 39031-1007 | 1 |
| BOLT,ADJUSTING (Ref # 92001) | 92001-1447 | 3 |
| FITTING,TUBE (Ref # 92005) | 92005-1017 | 1 |
| FITTING,FUEL,X-TYPE (Ref # 92005A) | 92005-1051 | 1 |
| SCREW,FAST IDLE LEVER (Ref # 92009) | 92009-1147 | 1 |
| SCREW,THROTTLE CABLE (Ref # 92009A) | 92009-1148 | 1 |
| NUT,THROTTLE VLV ADST (Ref # 92015) | 92015-1119 | 3 |
| WASHER,PLAIN (Ref # 92022) | 16039-019 | 1 |
| WASHER,PLAIN (Ref # 92022A) | 16039-038 | 1 |
| WASHER,THROTTLE STOP (Ref # 92022B) | 92022-1361 | 1 |
| COLLAR,STEPPED (Ref # 92027) | 92027-1203 | 1 |
| CLAMP-PIPE (Ref # 92037) | 92037-072 | 3 |
| PIN,THROTTLE VALVE (Ref # 92043) | 92043-1079 | 3 |

1984 GPz PARTS LIST

THROTTLE ASSY

| ITEM NAME | PART NUMBER | QUANTITY |
|--------------------------------------|-------------|----------|
| RING-O,THROTTLE SENSO (Ref # 92055) | 92055-1226 | 1 |
| TUBE,4X9X290 (Ref # 92059) | 92059-1043 | 1 |
| TUBE,VACUUM,LONG (Ref # 92059A) | 92059-1162 | 2 |
| TUBE,ANTI-VIBRATION (Ref # 92059B) | 92059-1352 | 1 |
| PLUG,THR SENSOR COVER (Ref # 92066) | 92066-1107 | 4 |
| RUBBER PLUG (Ref # 92066A) | 92068-006 | 2 |
| SPRING,THROTTLE VALVE (Ref # 92081) | 92081-1259 | 3 |
| SPRING,FAST IDLE SHFT (Ref # 92081A) | 92081-1260 | 1 |
| SPRING,THROTTLE STOP (Ref # 92081B) | 92081-1538 | 1 |
| SPRING,IDLING LINK (Ref # 92081C) | 92081-1539 | 1 |
| SCREW-PAN-CROS,4X18 (Ref # 220) | 220B0418 | 1 |
| SCREW PAN HEAD 5X10 (Ref # 220A) | 220B0510 | 1 |
| SCREW-PAN-CROSS (Ref # 220B) | 220C0506 | 2 |
| SCREW-PAN-CROS (Ref # 220C) | 220C0510 | 8 |
| SCREW-PAN-CROS,6X12,B (Ref # 220D) | 220C0616 | 8 |
| SCREW CNTSNK HD 5X10 (Ref # 221) | 221B0510 | 2 |
| SCREW-CSK-CROS (Ref # 221A) | 221C0310 | 4 |
| SCREW-PAN-WSP-CROS (Ref # 225) | 225B0510 | 2 |
| NUT,4MM (Ref # 311) | 311B0400 | 1 |
| CIRCLIP-TYPE-E (Ref # 482) | 482L4000 | 1 |
| BALL,STEEL,1/8" (Ref # 600) | 600A0400 | 1 |