

1984 LTD Shaft PARTS DIAGRAM

CHASSIS ELECTRICAL EQUIPMENT

F2760-0284

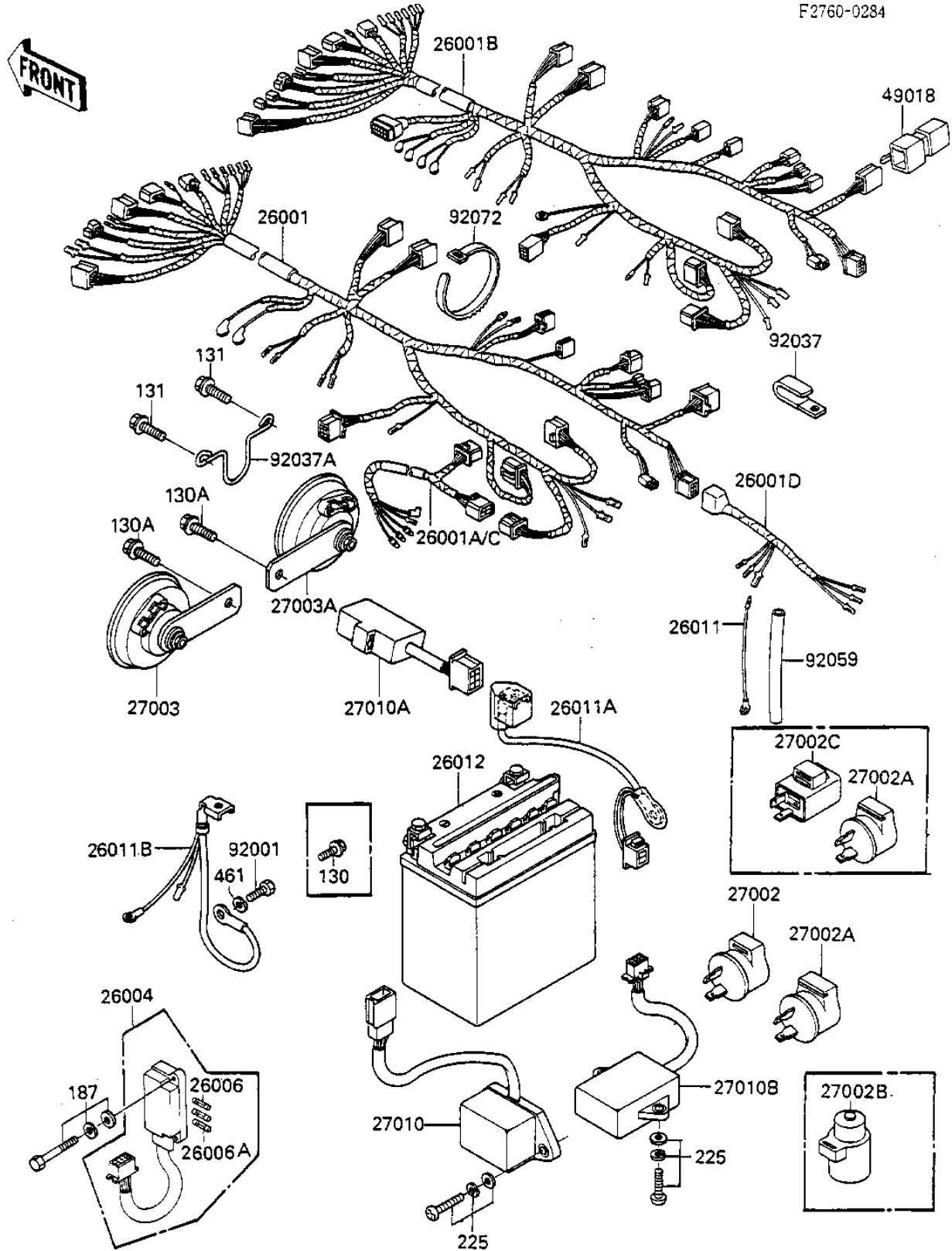

1984 LTD Shaft PARTS LIST

CHASSIS ELECTRICAL EQUIPMENT

ITEM NAME	PART NUMBER	QUANTITY
HARNESS,MAIN (Ref # 26001B)	26001-1634	1
HARNESS,SUB (Ref # 26001C)	26001-1638	1
WIRING HARNESS,REAR (Ref # 26001D)	26002-063	1
FUSE-ASSY (Ref # 26004)	26004-1020	1
FUSE 10A (Ref # 26006)	26006-003	5
FUSE-20A (Ref # 26006A)	26006-005	2
WIRE,LEAD (Ref # 26011)	26011-095	2
WIRE-LEAD,BATTERY(+) (Ref # 26011A)	26011-1181	1
WIRE-LEAD,BATTERY(-) (Ref # 26011B)	26011-1182	1
FB BAT FB12A-A K2 (Ref # 26012)	26012-1074	1
RELAY,TURN SIGNAL (Ref # 27002A)	27002-016	1
RELAY-ASSY (Ref # 27002B)	27002-1051	1
RELAY-ASSY,TURN SIGNA (Ref # 27002C)	27002-1053	1
HORN,LH (Ref # 27003)	27003-1057	1
HORN,RH (Ref # 27003A)	27003-1058	1
SWITCH,RESERV LIGHTIN (Ref # 27010)	27010-1066	1
SWITCH (Ref # 27010A)	27010-1072	1
SWITCH,TURN SIGNAL OP (Ref # 27010B)	27010-1077	1
DIODE (Ref # 49018)	49018-1052	1
CLAMP,WIRING HARNESS (Ref # 92037)	92037-1069	1
CLAMP,MAIN HARNESS (Ref # 92037A)	92037-1383	1
TUBE,P.V.C,8X9X200 (Ref # 92059)	92059-1150	2
BAND,LONG (Ref # 92072)	92072-032	2
BOLT,FLANGED,6X8 (Ref # 130)	130B0608	1
BOLT-FLANGED,8X12,BLA (Ref # 130A)	130C0812	2
BOLT-FLANGED,6X14 (Ref # 131)	131B0614	2
BOLT-UPSET-WSP (Ref # 187)	187B0622	2
SCREW-PAN-WSP-CROS (Ref # 225)	225B0620	4