

1983 Spectre PARTS DIAGRAM

TRANSMISSION

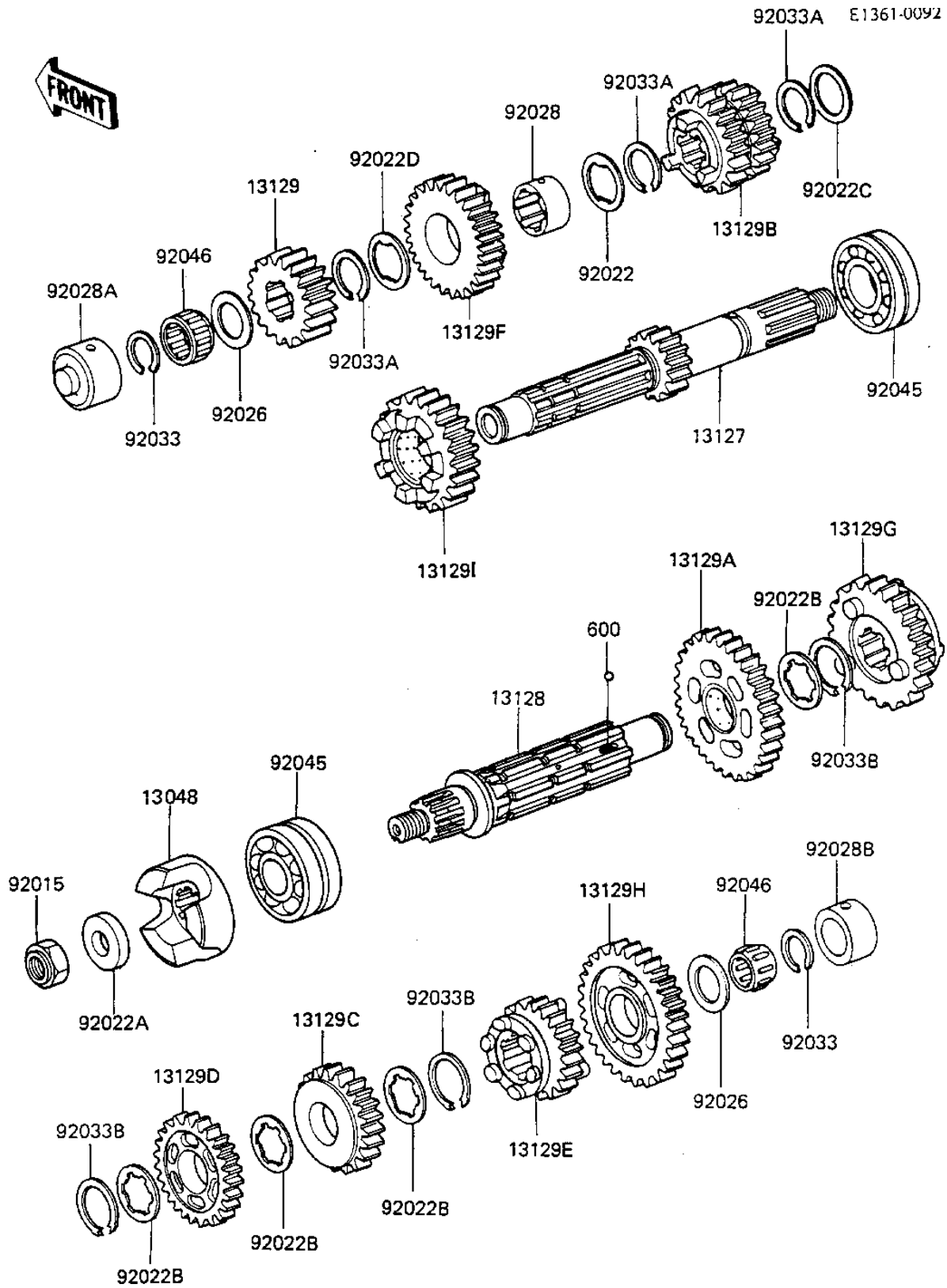

1983 Spectre PARTS LIST

TRANSMISSION

ITEM NAME	PART NUMBER	QUANTITY
CAM-DAMPER,OUTPUT SHA (Ref # 13048)	13048-1014	1
SHAFT,DRIVE,14T (Ref # 13127)	13127-1008	1
SHAFT-TRANSMISSION OU (Ref # 13128)	13128-1043	1
2ND GEAR,DRIVE SHAFT (Ref # 13129)	13129-1077	1
2ND GEAR,OUTPUT,32T (Ref # 13129A)	13129-1078	1
GEAR INPUT 3RD&4TH,21 (Ref # 13129B)	13260-1195	1
3RD GEAR,OUTPUT,29T (Ref # 13129C)	13129-1080	1
4TH GEAR,OUTPUT,27T (Ref # 13129D)	13129-1081	1
5TH GEAR,OUTPUT,25T (Ref # 13129E)	13129-1083	1
GEAR,INPUT TOP,27T (Ref # 13129F)	13129-1658	1
GEAR,OUTPUT TOP,23T (Ref # 13129G)	13129-1662	1
GEAR,OUTPUT LOW,36T (Ref # 13129H)	13129-1564	1
GEAR,INPUT 5TH,26T (Ref # 13129I)	13129-1657	1
NUT,14M/M (Ref # 92015)	92015-1067	1
WASHER,LOCK,30X1.0T (Ref # 92022)	92022-1072	1
WASHER,PLAIN,5X14.1 (Ref # 92022A)	92022-1115	1
WASHER,LOCK,1.0T (Ref # 92022B)	92022-1139	1
WASHER PLAIN (Ref # 92022C)	92022-161	1
WASHER-LOCK (Ref # 92022D)	92024-033	1
SPACER,20.3X30X2T (Ref # 92026)	92026-1022	1
BUSHING,INPUT TOP GEA (Ref # 92028)	92028-1552	1
BUSHING,INPUT SHAFT (Ref # 92028A)	92028-1186	1
BUSHING,OUTPUT SHAFT (Ref # 92028B)	92028-180	1
CIRCLIP (Ref # 92033)	92033-015	1
CIRCLIP (Ref # 92033A)	92033-026	1
SNAP RING,25.9X1.2T (Ref # 92033B)	92033-1037	1
BEARING,BALL (Ref # 92045)	92045-035	1
BEARING,VS20/14A (Ref # 92046)	92046-1030	1
BALL STEEL 5/32' (Ref # 600)	600A0500	1