

1983 KX250 PARTS DIAGRAM

FRAME FITTINGS ('83 KX250-C1)

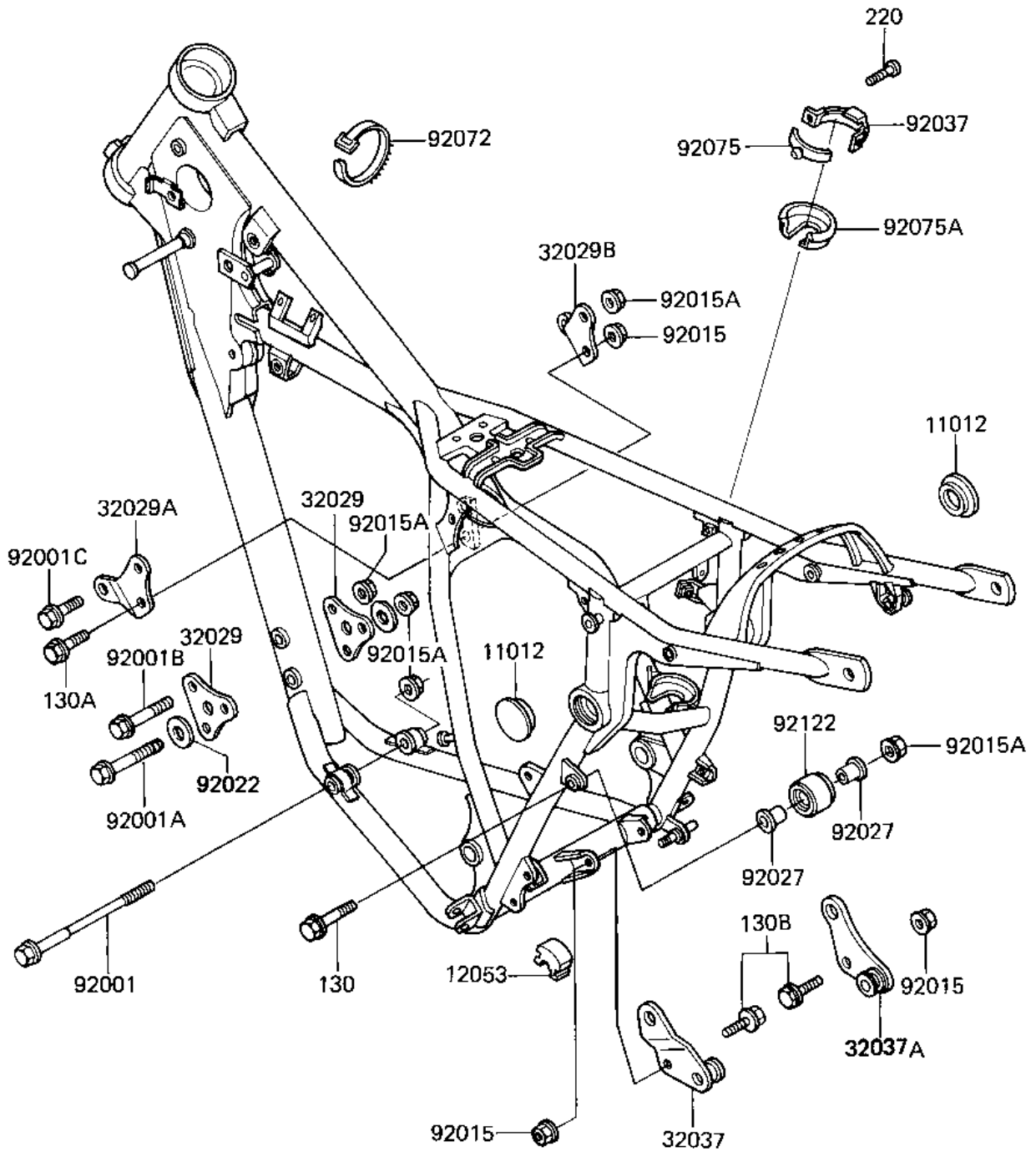

F2131-0132



1983 KX250 PARTS LIST

FRAME FITTINGS ('83 KX250-C1)

ITEM NAME	PART NUMBER	QUANTITY
CAP,UNI TRAK (Ref # 11012)	11012-1211	2
GUIDE-CHAIN,FR,LWR (Ref # 12053)	12053-1088	1
BRACKET-ENGINE,FR (Ref # 32029)	32029-1228	2
BRACKET-ENGINE,UPP,LH (Ref # 32029A)	32029-1229	1
BRACKET-ENGINE,UPP,RH (Ref # 32029B)	32029-1230	1
BRACKET-SHOCKABSORBER (Ref # 32037)	32037-1230	1
BRACKET-SHOCKABSORBER (Ref # 32037A)	32037-1231	1
BOLT,8X140 (Ref # 92001)	92002-1059	1
BOLT,FLANGED,8X80,BLA (Ref # 92001A)	92001-1640	1
BOLT,FLANGED,8X75,BLA (Ref # 92001B)	92001-1642	2
BOLT,FLANGED,10X50 (Ref # 92001)	92001-1692	1
NUT,10MM (Ref # 92015)	92015-1415	3
NUT-8MM (Ref # 92015A)	92015-1143	7
WASHER,8.5X20X1.6 (Ref # 92022)	92022-1561	2
COLLAR,CHAIN GUIDE (Ref # 92027)	92027-1383	2
CLAMP,RESERVE TANK,UP (Ref # 92037)	92037-1375	1
BAND,SHORT (Ref # 92072)	92072-030	3
DAMPER,RESERVE TANK,U (Ref # 92075)	92075-1431	1
DAMPER,RESERVE TANK,L (Ref # 92075A)	92075-1432	1
ROLLER,CHAIN GUIDE (Ref # 92122)	92122-1021	1
BOLT,FLANGED,8X50 (Ref # 130)	130G0850	1
BOLT-FLANGED,8X30 (Ref # 130A)	130P0830	2
BOLT-FLANGED,10X20 (Ref # 130B)	130P1020	2
SCREW PAN HEAD 6X12 (Ref # 220)	220B0612	1