

1984 KDX250 PARTS DIAGRAM

TRANSMISSION

E1361-0134

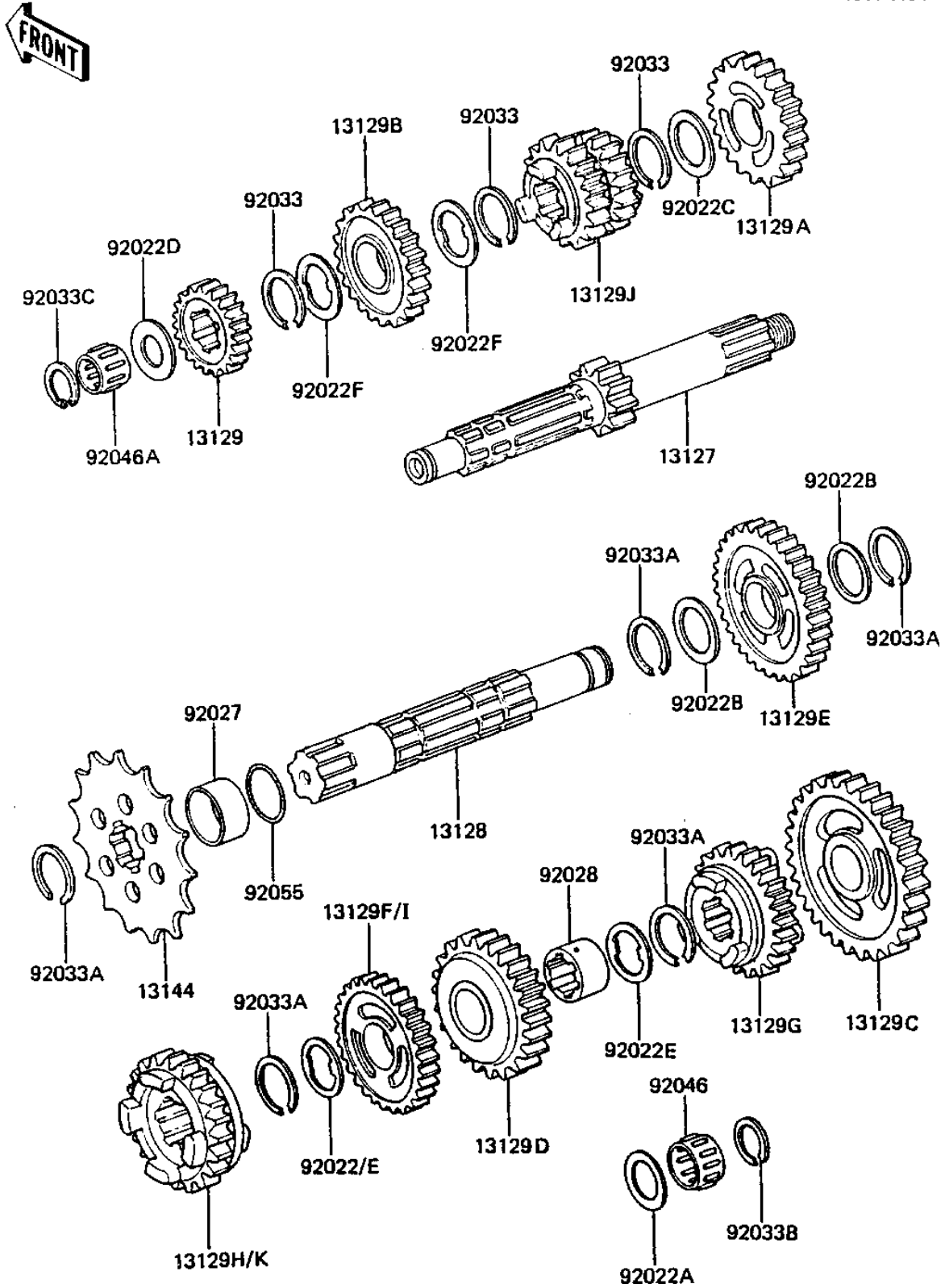

1984 KDX250 PARTS LIST

TRANSMISSION

| ITEM NAME | PART NUMBER | QUANTITY |
|-------------------------------------|-------------|----------|
| SHAFT-TRANSMISSION IN (Ref # 13127) | 13127-1065 | 1 |
| OUTPUT SHAFT (Ref # 13128) | 13128-1029 | 1 |
| GEAR,4TH (Ref # 13129) | 13129-1226 | 1 |
| GEAR,5TH (Ref # 13129A) | 13129-1227 | 1 |
| GEAR, TOP (Ref # 13129B) | 13129-1228 | 1 |
| GEAR, LOW (Ref # 13129C) | 13129-1229 | 1 |
| GEAR,2ND (Ref # 13129D) | 13129-1230 | 1 |
| GEAR,4TH (Ref # 13129E) | 13129-1232 | 1 |
| GEAR,OUTPUT 57H,20T (Ref # 13129G) | 13129-1352 | 1 |
| GEAR,OUTPUT 3RD,27T (Ref # 13129I) | 13129-1504 | 1 |
| GEAR,INPUT 2ND&3RD (Ref # 13129J) | 13129-1599 | 1 |
| GEAR,OUTPUT TOP,21T (Ref # 13129K) | 13129-1600 | 1 |
| ENGINE SPROCKET,14T (Ref # 13144) | 13144-1006 | 1 |
| WASHER THRUST (Ref # 92022A) | 92022-112 | 1 |
| WASHER-PLAIN 25MM (Ref # 92022B) | 92022-159 | 2 |
| WASHER-PLAIN (Ref # 92022C) | 92022-198 | 1 |
| WASHER,PLAIN (Ref # 92022D) | 92022-281 | 1 |
| WASHER-LOCK (Ref # 92022E) | 92024-038 | 2 |
| WASHER-LOCK (Ref # 92022F) | 92024-039 | 2 |
| COLLAR-ENG SPROKET (Ref # 92027) | 92027-163 | 1 |
| BUSHING,OUTPUT GEAR (Ref # 92028) | 92028-1268 | 1 |
| CIRCLIP,25MM (Ref # 92033) | 92033-025 | 3 |
| CIRCLIP (Ref # 92033A) | 92033-026 | 5 |
| CIRCLIP,18MM (Ref # 92033B) | 92033-029 | 1 |
| CIRCLIP,16MM (Ref # 92033C) | 92033-032 | 1 |
| BEARING-NEEDLE,KT2026 (Ref # 92046) | 92046-1170 | 1 |
| BEARING-NEEDLE (Ref # 92046A) | 92046-1184 | 1 |
| "O" RING (Ref # 92055) | 92055-035 | 1 |