

## 1980 KE125 PARTS DIAGRAM

CYLINDER HEAD/CYLINDER ('80-'81 A7/A8)

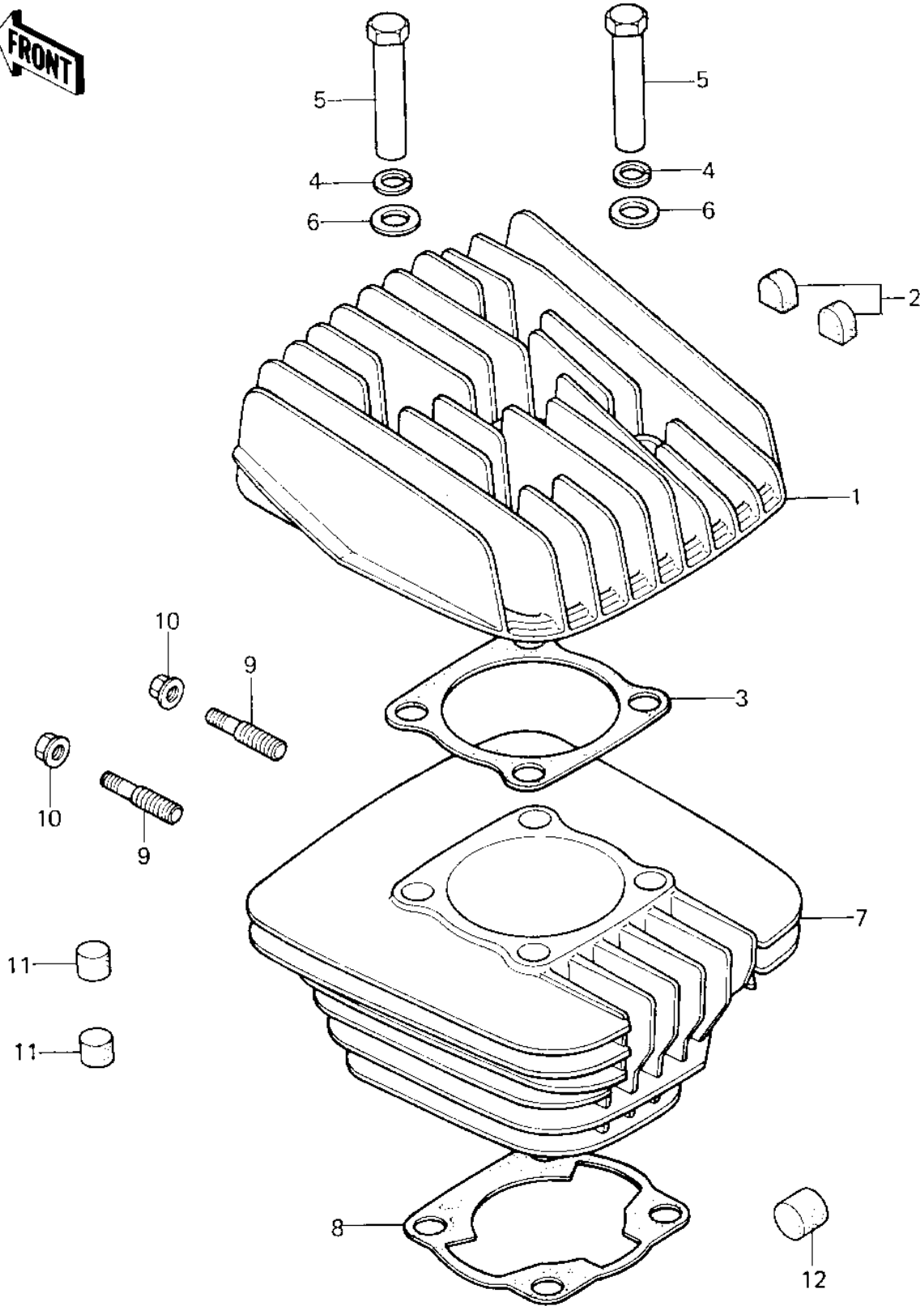

## 1980 KE125 PARTS LIST

CYLINDER HEAD/CYLINDER ('80-'81 A7/A8)

ITEM NAME	PART NUMBER	QUANTITY
HEAD,CYLINDER,F.BLACK (Ref # 1)	11001-1033	1
DAMPER RUBBER (Ref # 2)	92075-1176	1
GASKET,CYLINDER HEAD (Ref # 3)	11004-064	1
WASHER SPRING 12MM (Ref # 4)	461F1200	1
NUT 8MM (Ref # 5)	92015-020	1
WASHER PLAIN 12MM (Ref # 6)	92022-072	1
CYLINDER,F.BLACK (Ref # 7)	11005-1073	1
GASKET,CYLINDER BASE (Ref # 8)	11009-037	1
STUD (Ref # 9)	92004-029	1
NUT-6MM (Ref # 10)	92015-1078	1
DAMPER RUBBER-CYL-HD (Ref # 11)	92075-109	1
DAMPER RUBBER-CYL HD (Ref # 12)	92075-117	1