

1983 KZ550-A4 PARTS DIAGRAM

IGNITION ('82-'83 A3/A4)

E1830-0019

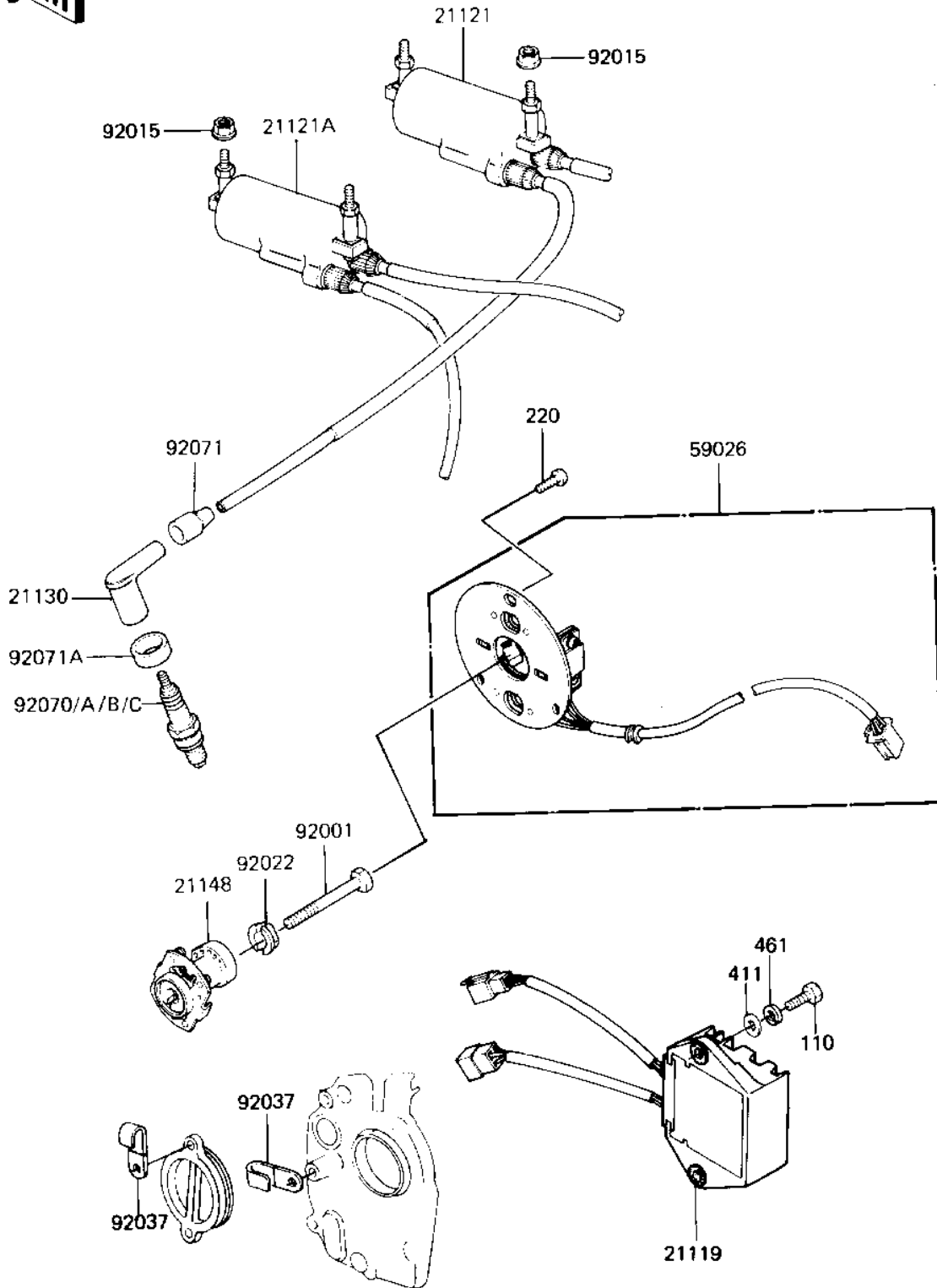

1983 KZ550-A4 PARTS LIST

IGNITION ('82-'83 A3/A4)

| ITEM NAME | PART NUMBER | QUANTITY |
|--|-------------|----------|
| IGNITER (Ref # 21119) | 21119-1040 | 1 |
| COIL,IGNITION #1/4 (Ref # 21121) | 21121-1035 | 1 |
| COIL,IGNITION,#2/3 (Ref # 21121A) | 21121-1036 | 1 |
| CAP,SPARK PLUG"LD05F" (Ref # 21130) | 21130-1003 | 4 |
| ADVANCER, (Ref # 21148) | 21148-1016 | 1 |
| COIL,PULSING (Ref # 59026) | 59026-1009 | 1 |
| BOLT-8X63 (Ref # 92001) | 92001-1397 | 1 |
| NUT-6MM (Ref # 92015) | 92015-1078 | 4 |
| WASHER,SPARK ADVANCER (Ref # 92022) | 92022-244 | 1 |
| CLAMP,WIRING HARNESS (Ref # 92037) | 21126-008 | 2 |
| SPARK PLUG D8EA (Ref # 92070) | D8EA | 4 |
| SPARK PLUG DR8ES (Canada) (Ref # 92070B) | 92070-1019 | 4 |
| GROMMET,SPARK PLG CAP (Ref # 92071) | 21132-005 | 4 |
| GROMMET,SPARK PLUG (Ref # 92071A) | 92071-1015 | 4 |
| BOLT-UPSET (Ref # 110) | 112G0618 | 2 |
| SCREW PAN HEAD 5X12 (Ref # 220) | 220B0512 | 3 |
| WASHER PLAIN 6MM (Ref # 411) | 411B0600 | 2 |
| WASHER SPRING 6MM (Ref # 461) | 461F0600 | 2 |