

# 1980 KZ550-A1 PARTS DIAGRAM

TRANSMISSION ('80-'81 A1/A2)

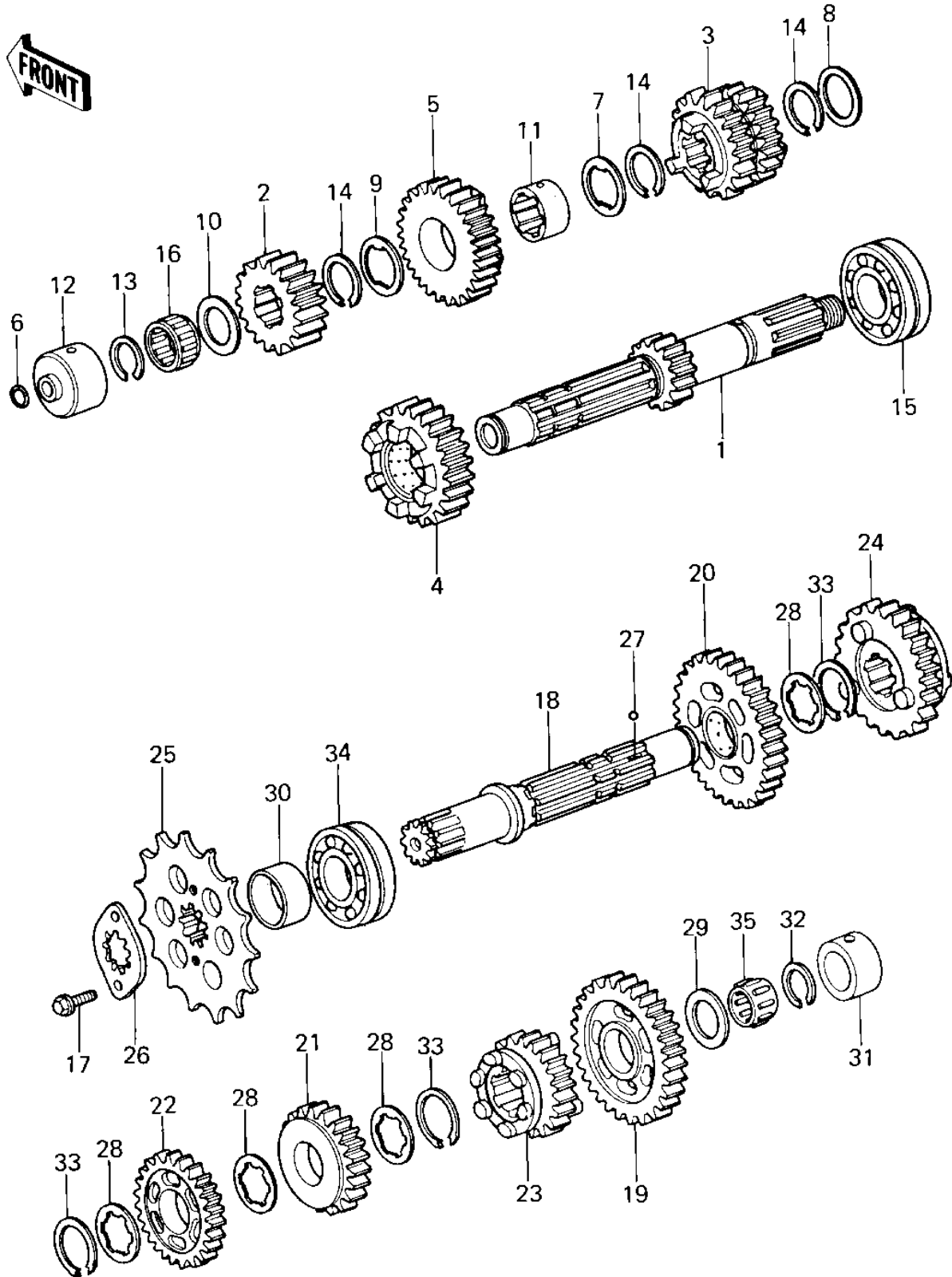

# 1980 KZ550-A1 PARTS LIST

TRANSMISSION ('80-'81 A1/A2)

ITEM NAME	PART NUMBER	QUANTITY
SHAFT,DRIVE,14T (Ref # 1)	13127-1008	1
2ND GEAR,DRIVE SHAFT (Ref # 2)	13129-1077	1
GEAR INPUT 3RD&4TH,21 (Ref # 3)	13260-1195	1
5TH GEAR,DRIVE SHAFT (Ref # 4)	13129-1082	1
GEAR,INPUT TOP,27T (Ref # 5)	13129-1658	1
"O" RING,8MM (Ref # 6)	670B1508	1
WASHER,LOCK,30X1.0T (Ref # 7)	92022-1072	1
WASHER PLAIN (Ref # 8)	92022-161	1
WASHER-LOCK (Ref # 9)	92024-033	1
SPACER,20.3X30X2T (Ref # 10)	92026-1022	1
BUSHING,INPUT TOP GEA (Ref # 11)	92028-1552	1
BUSHING,DRIVE SHAFT (Ref # 12)	92028-1032	1
CIRCLIP (Ref # 13)	92033-015	1
CIRCLIP (Ref # 14)	92033-026	3
BEARING,BALL (Ref # 15)	92045-035	1
BEARING,VS20/14A (Ref # 16)	92046-1030	1
BOLT,FLANGED,6X12 (Ref # 17)	130G0612	2
SHAFT,OUTPUT (Ref # 18)	13128-1009	1
LOW GEAR,OUTPUT,36T (Ref # 19)	13129-1076	1
2ND GEAR,OUTPUT,32T (Ref # 20)	13129-1078	1
3RD GEAR,OUTPUT,29T (Ref # 21)	13129-1080	1
4TH GEAR,OUTPUT,27T (Ref # 22)	13129-1081	1
5TH GEAR,OUTPUT,25T (Ref # 23)	13129-1083	1
GEAR,OUTPUT TOP,23T (Ref # 24)	13129-1662	1
SPROCKET,ENGINE,16T (Ref # 25)	13144-1016	1
PLATE,SPROCKET (Ref # 26)	13270-1060	1
BALL STEEL 5/32' (Ref # 27)	600A0500	3
WASHER,LOCK,1.0T (Ref # 28)	92022-1139	4
SPACER,20.3X30X2T (Ref # 29)	92026-1022	1

# 1980 KZ550-A1 PARTS LIST

TRANSMISSION ('80-'81 A1/A2)

ITEM NAME	PART NUMBER	QUANTITY
COLLAR,25X32X23.5L (Ref # 30)	92027-1106	1
BUSHING,OUTPUT SHAFT (Ref # 31)	92028-180	1
CIRCLIP (Ref # 32)	92033-015	1
SNAP RING,25.9X1.2T (Ref # 33)	92033-1037	3
BEARING,BALL (Ref # 34)	92045-035	1
BEARING,VS20/14A (Ref # 35)	92046-1030	1