

# 2001 Ultra 150 PARTS DIAGRAM

Pads(JH1200-A2/A3/A4)

F3147A

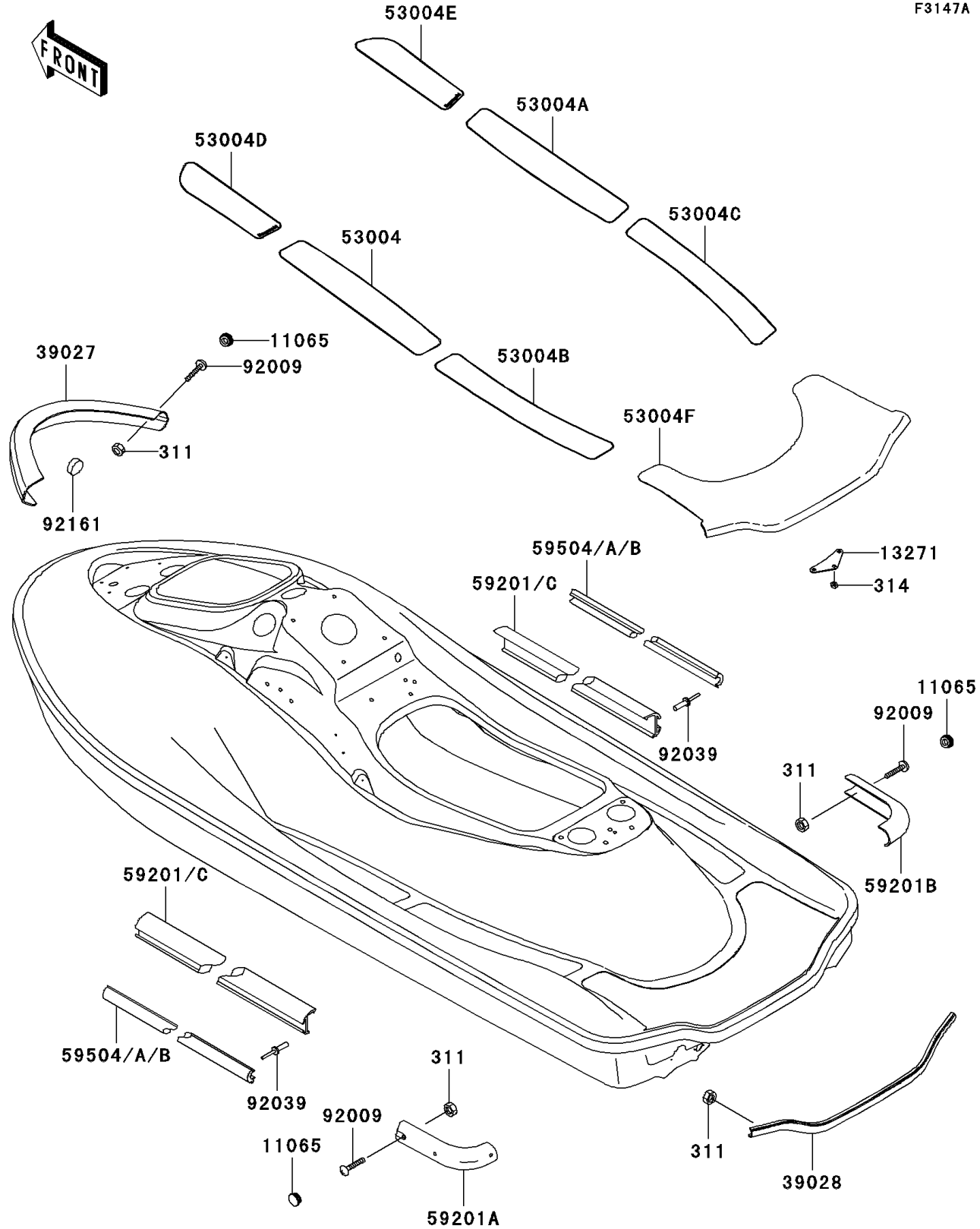

## 2001 Ultra 150 PARTS LIST

Pads(JH1200-A2/A3/A4)

ITEM NAME	PART NUMBER	QUANTITY
NUT-HEX,5MM (Ref # 311)	311R0500	16
NUT-HEX-FINE,10MM (Ref # 314)	314R1000	3
CAP,F.BLACK (Ref # 11065)	11065-3707-6Z	10
PLATE (Ref # 13271)	13271-3759	1
BUMPER-FRONT,F.BLACK (Ref # 39027)	39027-3743-6Z	1
BUMPER-REAR,F.BLACK (Ref # 39028)	39028-3743-6Z	1
MAT,FR,LH,F.BLACK (Ref # 53004)	53004-3793-6Z	1
MAT,FR,RH,F.BLACK (Ref # 53004A)	53004-3794-6Z	1
MAT,RR,LH,F.BLACK (Ref # 53004B)	53004-3795-6Z	1
MAT,RR,RH,F.BLACK (Ref # 53004C)	53004-3796-6Z	1
MAT,LH,F.BLACK (Ref # 53004D)	53004-3798-6Z	1
MAT,RH,F.BLACK (Ref # 53004E)	53004-3799-6Z	1
MAT,RR,F.BLACK (Ref # 53004F)	53004-3820-6Z	1
BUMPER,SIDE,F.BLACK (Ref # 59201)	59201-3779-6Z	2
BUMPER,CORNER,LH,F.BLACK (Ref # 59201A)	59201-3780-6Z	1
BUMPER,CORNER,RH,F.BLACK (Ref # 59201B)	59201-3781-6Z	1
INSERT-BOAT FENDER,F.BLACK (Ref # 59504A)	59504-3725-6Z	2
SCREW,5X30 (Ref # 92009)	92009-3834	10
RIVET (Ref # 92039)	92039-3771	24
DAMPER (Ref # 92161)	92161-3713	1