

# 1999 Ultra 150 PARTS DIAGRAM

Hull

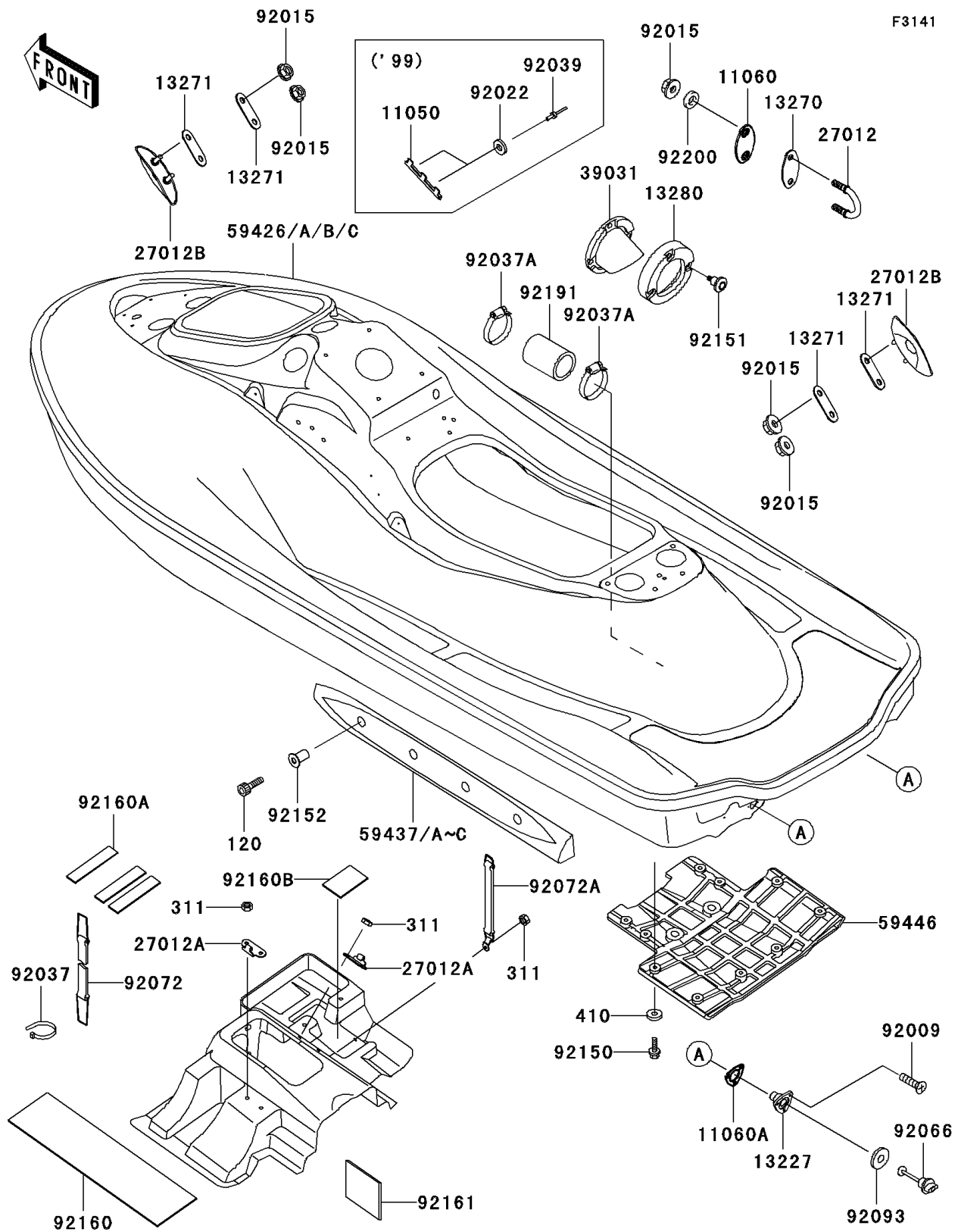

F3141

# 1999 Ultra 150 PARTS LIST

## Hull

ITEM NAME	PART NUMBER	QUANTITY
BRACKET,BREAKER (Ref # 11050)	11050-3772	1
GASKET,U HOOK,RR (Ref # 11060)	11060-3800	2
GASKET,DRAIN PLUG (Ref # 11060A)	11060-3801	2
HOUSING,DRAIN PLUG (Ref # 13227)	13227-3711	2
PLATE (Ref # 13270)	13270-3860	2
PLATE (Ref # 13271)	13271-3724	4
HOLDER,EXHAUST VALVE (Ref # 13280)	13280-3718	1
HOOK (Ref # 27012)	27012-3797	2
HOOK (Ref # 27012A)	27012-3816	2
HOOK,BOW,F.BLACK (Ref # 27012B)	27012-3822-6Z	2
CAP-END (Ref # 39031)	39031-3704	1
STABILIZER,LH,R.BLACK (Ref # 59437)	59437-3721-6S	1
STABILIZER,RH,R.BLACK (Ref # 59437B)	59437-3722-6S	1
COVER-JET PUMP (Ref # 59446)	59446-3749	1
SCREW,TAPPING,4X16 (Ref # 92009)	92009-3849	6
NUT,FLANGED,8MM (Ref # 92015)	92015-3709	8
WASHER,5X16X1.5 (Ref # 92022)	92022-3041	2
CLAMP (Ref # 92037)	92037-1173	1
CLAMP (Ref # 92037A)	92037-509	2
RIVET (Ref # 92039)	92039-3747	2
PLUG,RR,DRAIN (Ref # 92066)	92066-3744	2
BAND,340X22 (Ref # 92072)	92072-3805	1
BAND,248X18 (Ref # 92072A)	92072-3829	1
SEAL (Ref # 92093)	92093-3720	2
BOLT,SOCKET,6X18 (Ref # 92150)	92150-3775	10
BOLT,SOCKET,M6,SHOULDER (Ref # 92151)	92151-3746	3
COLLAR (Ref # 92152)	92152-3715	8
DAMPER (Ref # 92160)	92160-3839	1
DAMPER (Ref # 92160A)	92160-3840	3

# 1999 Ultra 150 PARTS LIST

## Hull

ITEM NAME	PART NUMBER	QUANTITY
DAMPER (Ref # 92160B)	92160-3913	1
BOLT-SOCKET (Ref # 120)	120R0630	8
NUT-HEX,6MM (Ref # 311)	311R0600	5
WASHER-PLAIN-SMALL,6MM (Ref # 410)	410S0600	10
DAMPER (Ref # 92161)	92161-3704	1
TUBE,39X51X70 (Ref # 92191)	92191-3856	1
WASHER (Ref # 92200)	92200-3779	4
HULL-COMP,S.RED (Ref # 59426)	59426-3889-H1	1