

# 1982 Police 1000 PARTS DIAGRAM

## TRANSMISSION

E1361-0101

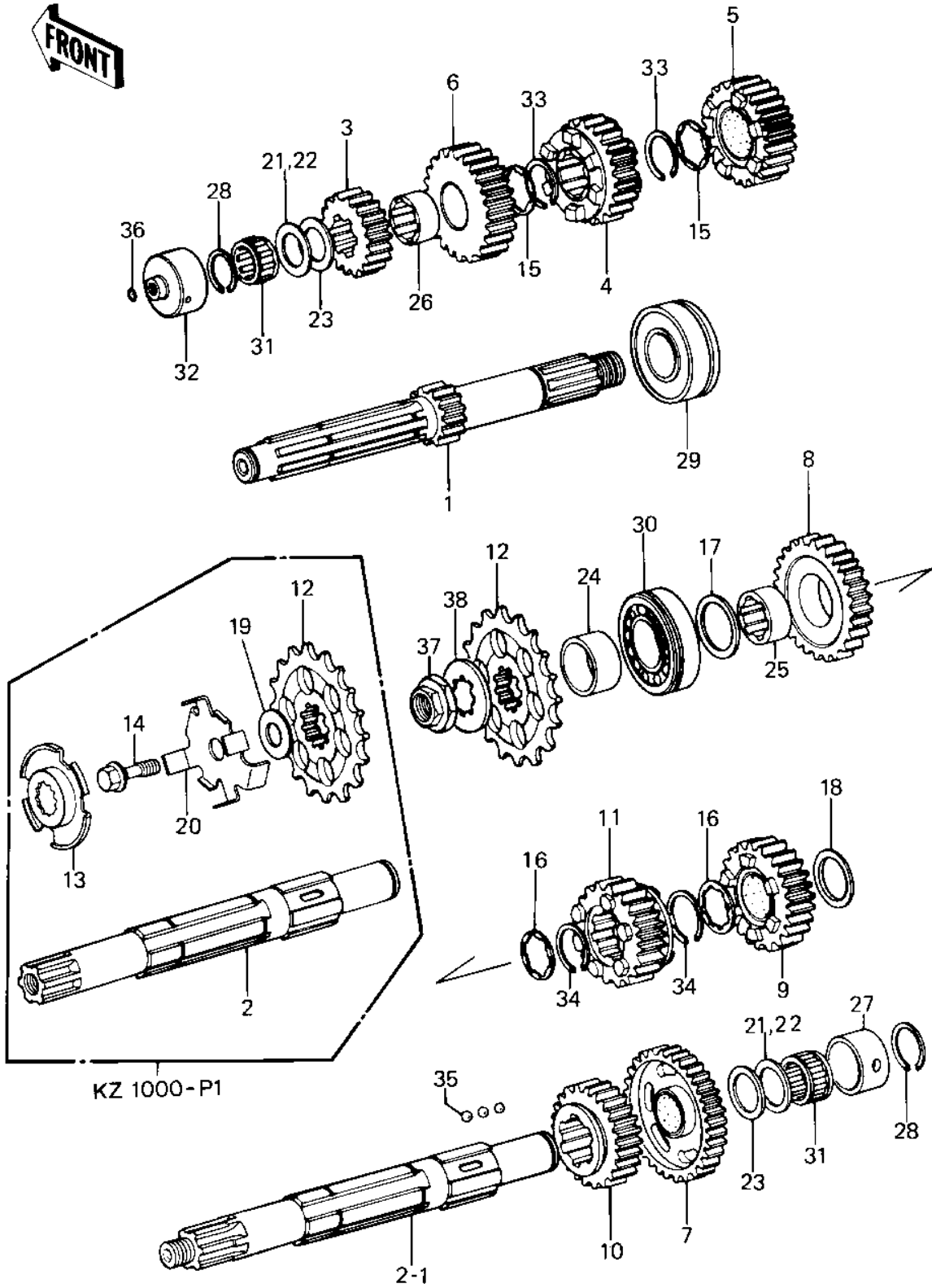

# 1982 Police 1000 PARTS LIST

## TRANSMISSION

ITEM NAME	PART NUMBER	QUANTITY
SHAFT-TRANSMISSION IN (Ref # 1)	13127-1034	1
SHAFT-TRANSMISSION OU (Ref # 2)	13128-1030	1
SHAFT-TRANSMISSION OU (Ref # 2.1)	13128-1048	1
INPUT 2ND,18T (Ref # 3)	13129-1235	1
INPUT 3RD,21T (Ref # 4)	13129-1236	1
INPUT 4TH,23T (Ref # 5)	13129-1237	1
INPUT TOP,25T (Ref # 6)	13129-1238	1
OUTPUT LOW,37T (Ref # 7)	13129-1239	1
OUTPUT 2ND,33T (Ref # 8)	13129-1240	1
OUTPUT 3RD,30T (Ref # 9)	13129-1241	1
OUTPUT 4TH,27T (Ref # 10)	13129-1242	1
OUTPUT TOP,26T (Ref # 11)	13129-1243	1
SPROCKET-OUTPUT,15T (Ref # 12)	13144-1042	1
STOPPER,ENGN SPROCKET (Ref # 13)	32085-1101	1
BOLT,FLANGED,10X39 (Ref # 14)	92001-1479	1
WASHER,LOCK (O.D=35) (Ref # 15)	92022-1077	2
WASHER,LOCK,30X42X1.4 (Ref # 16)	92022-1218	2
WASHER,28.3X42X2.9 (Ref # 17)	92022-1219	1
WASHER,32.3X42X3 (Ref # 18)	92022-1220	1
WASHER,12.3X38X2.3 (Ref # 19)	92022-1274	1
WASHER,SPRCKT STOPPER (Ref # 20)	92022-1351	1
WASHER,PLAIN,22MM (Ref # 21)	92022-212	2
WASHER,PLAIN,22MM (Ref # 22)	92022-213	AR
SPACER (I.D=22 O.D=35 (Ref # 23)	92026-1020	2
COLLAR (Ref # 24)	92027-1339	1
BUSHING,2ND GEAR (Ref # 25)	92028-1112	1
BUSHING,TOP GEAR (Ref # 26)	92028-1124	1
BUSH,OUTPUT SHAFT (Ref # 27)	92028-123	1
CIRCLIP,25MM (Ref # 28)	92033-025	2

# 1982 Police 1000 PARTS LIST

## TRANSMISSION

ITEM NAME	PART NUMBER	QUANTITY
BEARING,BALL,5305NSH2 (Ref # 29)	92045-1028	1
BEARING-BALL,63/28NC3 (Ref # 30)	92045-1034	1
BEARING,PK223013.8 (Ref # 31)	92046-031	2
RACE,DRIVE SHAFT BRNG (Ref # 32)	92048-1012	1
CIRCLIP 28MM (Ref # 33)	480J2800	2
CIRCRIP-TYPE-C (Ref # 34)	480J3200	2
BALL STEEL 3/16' (Ref # 35)	600A0600	3
"O" RING,8MM (Ref # 36)	670B1508	1
NUT,20MM (Ref # 37)	92015-1210	1
WASHER (Ref # 38)	92200-1060	1