

# 1982 Police 1000 PARTS DIAGRAM

## MUFFLERS

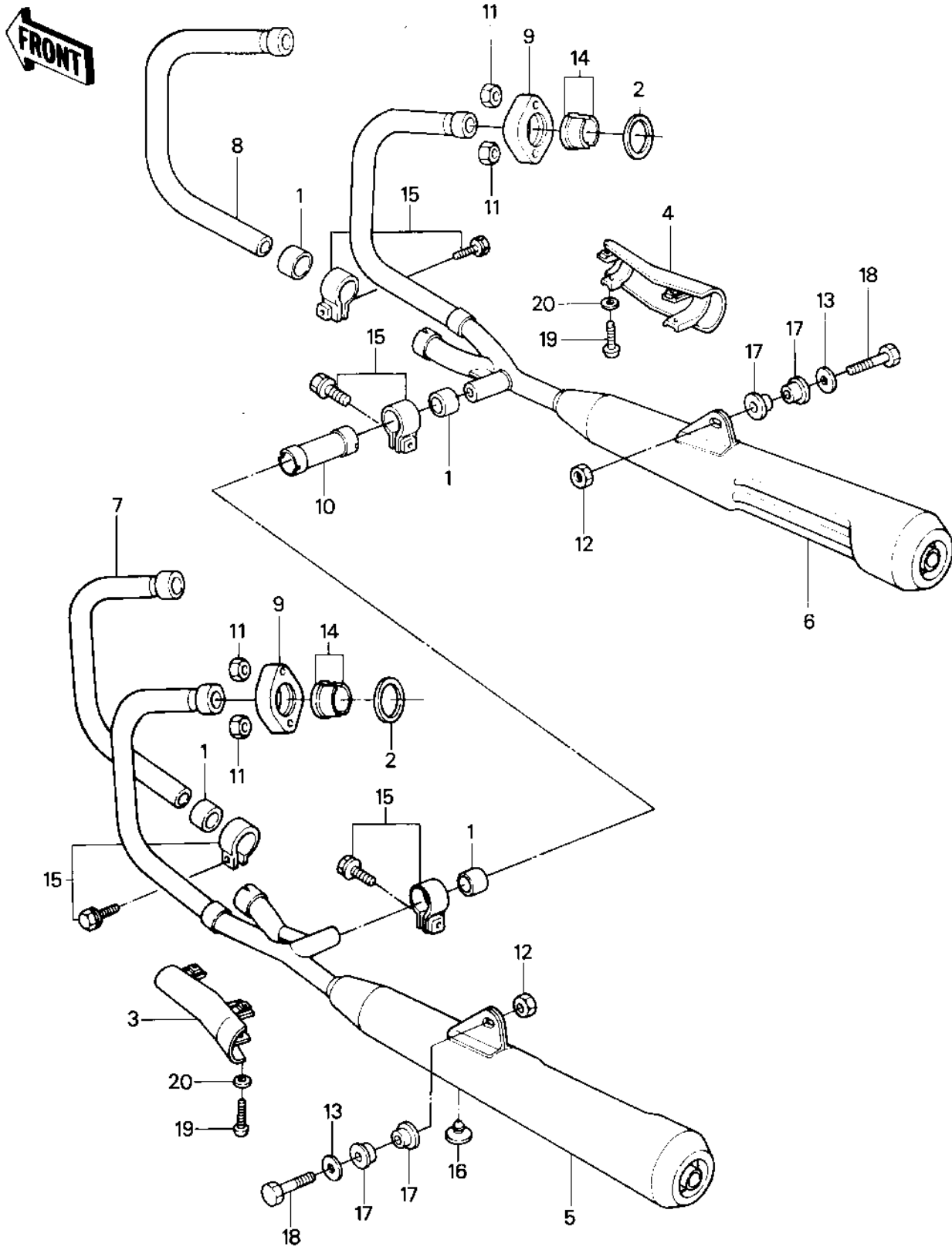

# 1982 Police 1000 PARTS LIST

## MUFFLERS

ITEM NAME	PART NUMBER	QUANTITY
GASKET,MANIFOLD EXHAU (Ref # 1)	11060-1068	4
GASKET,EXHAUST PIPE H (Ref # 2)	11009-1906	4
COVER,MUFFLER,LH (Ref # 3)	14025-1355	1
COVER,MUFFLER,RH (Ref # 4)	14025-1356	1
MUFFLER-LH (Ref # 5)	18001-1299	1
MUFFLER,L.H. (Ref # 5)	18001-1595	1
MUFFLER,L.H. (Ref # 5)	18001-1595	1
MUFFLER-RH (Ref # 6)	18001-1300	1
MUFFLER,R.H. (Ref # 6)	18001-1596	1
MUFFLER,R.H. (Ref # 6)	18001-1596	1
PIPE-EXHAUST,#2 (Ref # 7)	18049-1188	1
PIPE-EXHAUST,#3 (Ref # 8)	18049-1189	1
HOLDER-EXHAUST PIPE (Ref # 9)	18069-1015	4
PIPE,MUFFLER CONNECT (Ref # 10)	32032-1676	1
PIPE,MUFFLER CONNECT (Ref # 10)	32032-1676	1
NUT-8MM (Ref # 11)	92015-1143	8
NUT,8MM (Ref # 11)	92015-1398	8
NUT,LOCK,10MM (Ref # 12)	92019-021	2
WASHER,PLAIN (Ref # 13)	92022-289	2
COLLAR,EXHAUST PIPE (Ref # 14)	92027-1300	8
CLAMP,MUFFLER (Ref # 15)	92037-1258	4
CLAMP,MUFFLER (Ref # 15)	92037-1536	4
DAMPER RUBB MAIN STAD (Ref # 16)	92075-015	1
BUSHING,MUFFLER FITT (Ref # 17)	92092-010	4
BOLT-HEX HEAD,10X55 (Ref # 18)	113N1055	2
SCREW PAN HEAD 6X45 (Ref # 19)	220B0645	4
SCREW-PAN-CROS (Ref # 19)	220X0645	4
WASHER SPRING 6MM (Ref # 20)	461F0600	4