

## 2002 Vulcan 500 LTD PARTS DIAGRAM

Fuel Tank

F2410

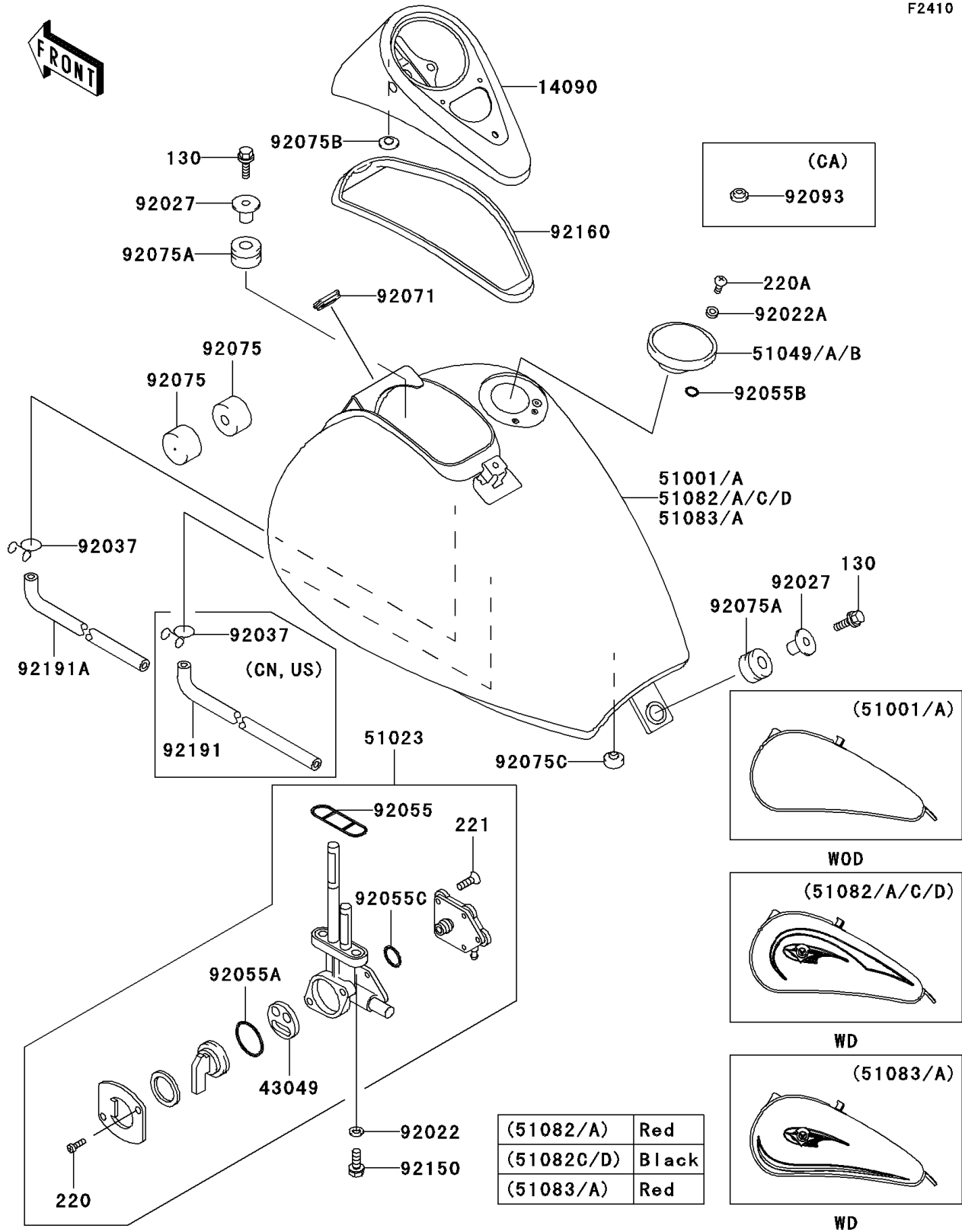

## 2002 Vulcan 500 LTD PARTS LIST

Fuel Tank

ITEM NAME	PART NUMBER	QUANTITY
COVER,METER (Ref # 14090)	14090-1560	1
PACKING,TAP VALVE (Ref # 43049)	43049-1091	1
TAP-ASSY,FUEL (Ref # 51023)	51023-1267	1
CAP-TANK,FUEL (Ref # 51049B)	51049-1126	1
WASHER,6.2X11X1.5 (Ref # 92022)	92022-183	1
WASHER,5.1X10X1.0 (Ref # 92022A)	92022-1977	1
COLLAR,L=19.3 (Ref # 92027)	92027-1780	1
RING-O,FUEL TAP PACKING (Ref # 92055)	92055-1112	1
RING-O,TAP LEVER (Ref # 92055A)	92055-1419	1
RING-O,ID=9 (Ref # 92055B)	92055-1552	1
RING-O (Ref # 92055C)	92055-1664	1
GROMMET (Ref # 92071)	92071-1187	1
DAMPER,FUEL TANK (Ref # 92075)	92075-125	1
DAMPER (Ref # 92075A)	92075-1736	1
DAMPER (Ref # 92075B)	92075-1876	1
DAMPER,RUBBER (Ref # 92075C)	92075-261	1
BOLT-FLANGED,8X30 (Ref # 130)	130G0830	1
SCREW-PAN-CROS (Ref # 220)	220B0308	1
SCREW-PAN-CROS (Ref # 220A)	220D0510	1
SCREW-CSK-CROS,4X14 (Ref # 221)	221B0414	1
BOLT,FLANGED,6X16 (Ref # 92150)	92150-1358	1
DAMPER,METER COVER (Ref # 92160)	92160-1593	1
TUBE,DRAIN (Ref # 92191A)	92191-1578	1
TANK-COMP-FUEL,C.C.RED (Ref # 51082)	51082-5048-L1	1
TANK-COMP-FUEL,C.C.RED (Ref # 51082A)	51082-5049-L1	1
CLAMP,TUBE (Ref # 92037)	92037-147	2
SEAL,FUEL TANK CAP (Ref # 92093)	92093-1030	1
TUBE (Ref # 92191)	92191-1015	1