

2011 KX™450F PARTS DIAGRAM

Crankcase

E1411

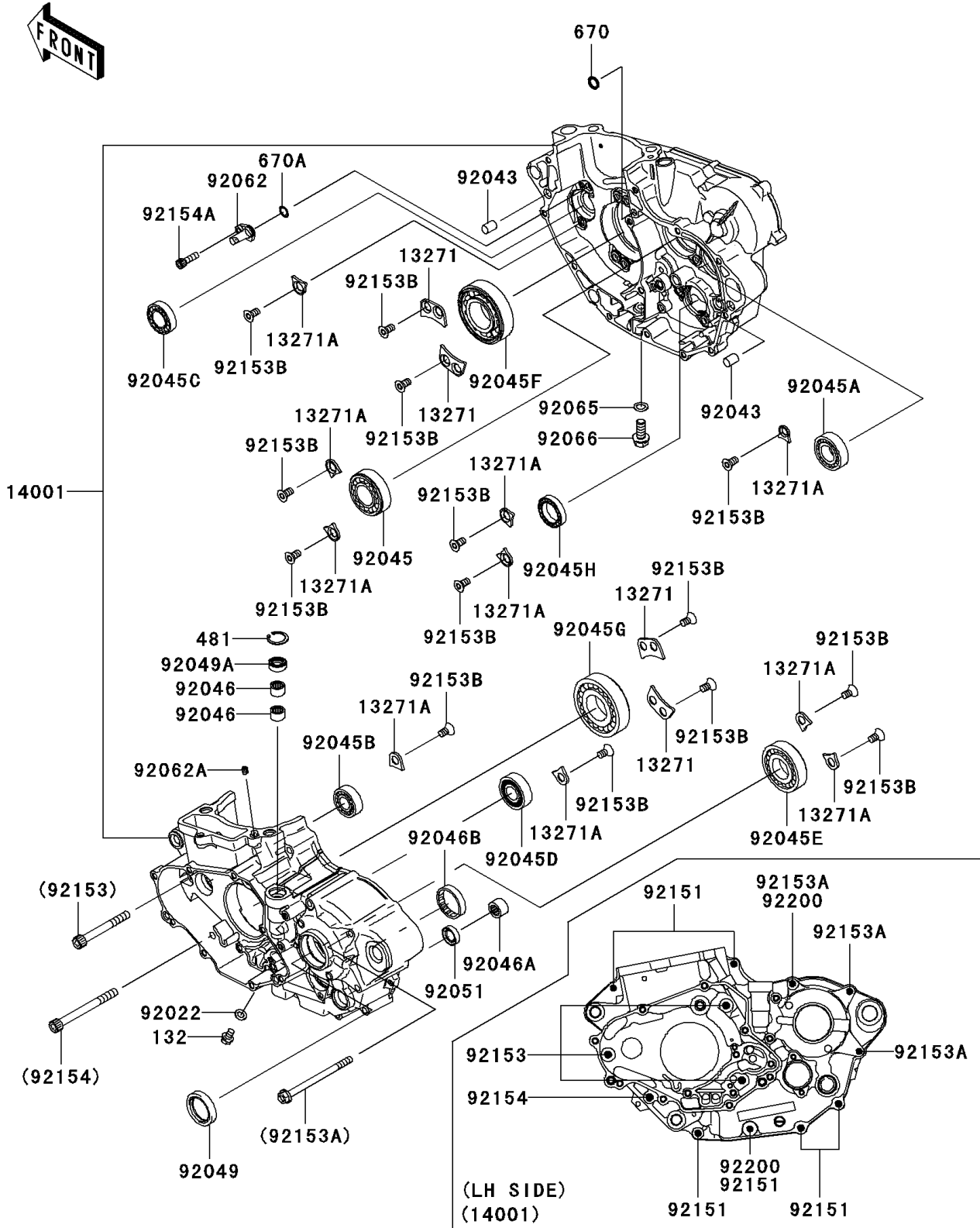

2011 KX™450F PARTS LIST

Crankcase

| ITEM NAME | PART NUMBER | QUANTITY |
|---|-------------|----------|
| BOLT-FLANGED-SMALL,6X8 (Ref # 132) | 132BA0608 | 1 |
| CIRCLIP (Ref # 481) | 481J2100 | 1 |
| O RING,7MM (Ref # 670) | 670D1507 | 1 |
| O RING,8MM (Ref # 670A) | 670D1508 | 1 |
| PLATE (Ref # 13271) | 13271-0334 | 1 |
| PLATE (Ref # 13271A) | 13271-0345 | 1 |
| SET-CRANKCASE (Ref # 14001) | 14001-0162 | 1 |
| WASHER,6.2X11X1 (Ref # 92022) | 92022-304 | 1 |
| PIN,10X14 (Ref # 92043) | 92043-1506 | 1 |
| BEARING-BALL,25X52X15 (Ref # 92045) | 92045-0035 | 1 |
| BEARING-BALL,20X42X12 (Ref # 92045A) | 92045-0036 | 1 |
| BEARING-BALL,6202SH2C3 (Ref # 92045B) | 92045-0037 | 1 |
| BEARING-BALL,6904C3UR5 (Ref # 92045C) | 92045-0038 | 1 |
| BEARING-BALL,3TM-5X0391LUC3 (Ref # 92045D) | 92045-0057 | 1 |
| BEARING-BALL (Ref # 92045E) | 92045-0062 | 1 |
| BEARING-BALL,B32-32-A-ZEC4 (Ref # 92045F) | 92045-0074 | 1 |
| BEARING-BALL (Ref # 92045G) | 92045-0132 | 1 |
| BEARING-BALL,6805JRZ (Ref # 92045H) | 92045-1432 | 1 |
| BEARING-NEEDLE,HK1210 (Ref # 92046) | 92046-1010 | 1 |
| BEARING-NEEDLE,HK1312 (Ref # 92046A) | 92046-1148 | 1 |
| BEARING-NEEDLE,7E-HKS33X38X8 (Ref # 92046B) | 92046-1221 | 1 |
| SEAL-OIL,TC 30 40 7 (Ref # 92049) | 92049-0030 | 1 |
| SEAL-OIL,CLUTCH RELEASE (Ref # 92049A) | 92049-1475 | 1 |
| SEAL-OIL,TB13225.5 (Ref # 92051) | 92051-005 | 1 |
| NOZZLE (Ref # 92062) | 92062-0017 | 1 |
| NOZZLE,6X8,SILVER (Ref # 92062A) | 92062-1081 | 1 |
| GASKET,10.5X16X1 (Ref # 92065) | 92065-058 | 1 |
| PLUG,DRAIN,10X22 (Ref # 92066) | 92066-0038 | 1 |
| BOLT,6X50 (Ref # 92151) | 92151-1545 | 1 |

2011 KX™450F PARTS LIST

Crankcase

| ITEM NAME | PART NUMBER | QUANTITY |
|-----------------------------------|-------------|----------|
| BOLT,7X60 (Ref # 92153) | 92153-0846 | 1 |
| BOLT,FLANGED,6X85 (Ref # 92153A) | 92153-0934 | 1 |
| BOLT,TORX,6X8.7 (Ref # 92153B) | 92153-1669 | 1 |
| BOLT,SOCKET,7X75 (Ref # 92154) | 92154-0037 | 1 |
| BOLT,SOCKET,5X18 (Ref # 92154A) | 92154-0038 | 1 |
| WASHER,6.3X13.5X1.0 (Ref # 92200) | 92200-0171 | 1 |