

2008 Teryx® 750 4x4 LE PARTS DIAGRAM

Gear Change Mechanism

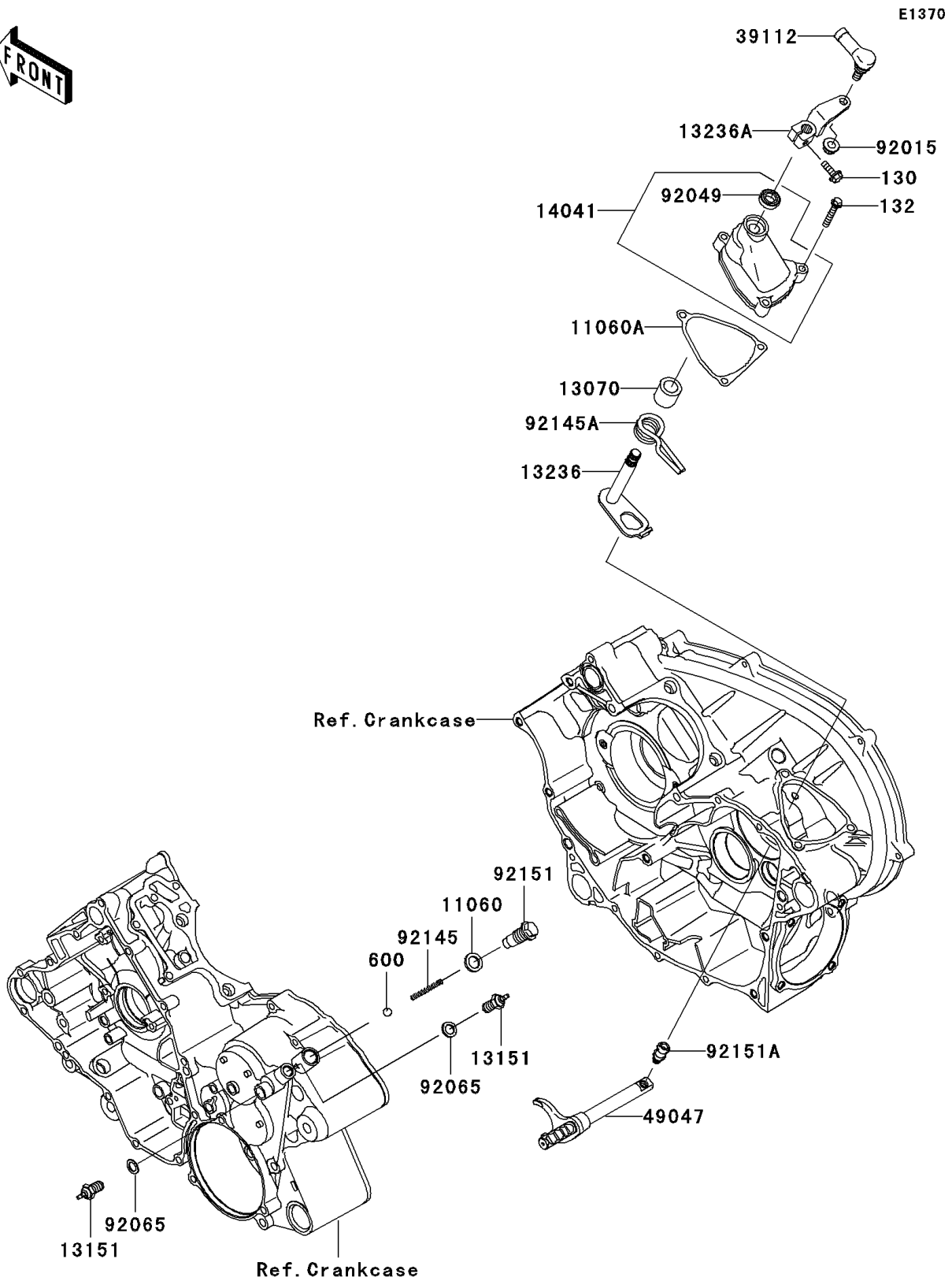

2008 Teryx® 750 4x4 LE PARTS LIST

Gear Change Mechanism

| ITEM NAME | PART NUMBER | QUANTITY |
|--|-------------|----------|
| BOLT-FLANGED,6X20 (Ref # 130) | 130CD0620 | 1 |
| BOLT-FLANGED-SMALL,6X30 (Ref # 132) | 132BD0630 | 1 |
| BALL-STEEL,5/16" (Ref # 600) | 600A1000 | 1 |
| GASKET,14X20X2 (Ref # 11060) | 11060-1287 | 1 |
| GASKET,CHANGE LEVER COVER (Ref # 11060A) | 11060-1956 | 1 |
| GUIDE (Ref # 13070) | 13070-1352 | 1 |
| SWITCH-COMP,NEUTRAL (Ref # 13151) | 13151-1080 | 1 |
| LEVER-COMP,CHANGE (Ref # 13236) | 13236-0051 | 1 |
| LEVER-COMP,CHANGE LEVER (Ref # 13236A) | 13236-1343 | 1 |
| COVER-COMP,CHANGE LEVER (Ref # 14041) | 14041-1136 | 1 |
| RODEND-TIE,CHANGE LEVER (Ref # 39112) | 39112-1080 | 1 |
| ROD-SHIFT (Ref # 49047) | 49047-1104 | 1 |
| NUT,8MM (Ref # 92015) | 92015-1432 | 1 |
| SEAL-OIL,TB12205.5 (Ref # 92049) | 92049-1271 | 1 |
| GASKET,10.5X16X1 (Ref # 92065) | 92065-058 | 1 |
| SPRING,CHANGE POSITION (Ref # 92145) | 92145-1297 | 1 |
| SPRING,CHANGE LEVER (Ref # 92145A) | 92145-1299 | 1 |
| BOLT,CHANGE POSITION (Ref # 92151) | 92151-1687 | 1 |
| BOLT,SHIFT ROD (Ref # 92151A) | 92151-1699 | 1 |