

2008 MULE™ 3010 Trans4x4 Diesel PARTS DIAGRAM

Transmission

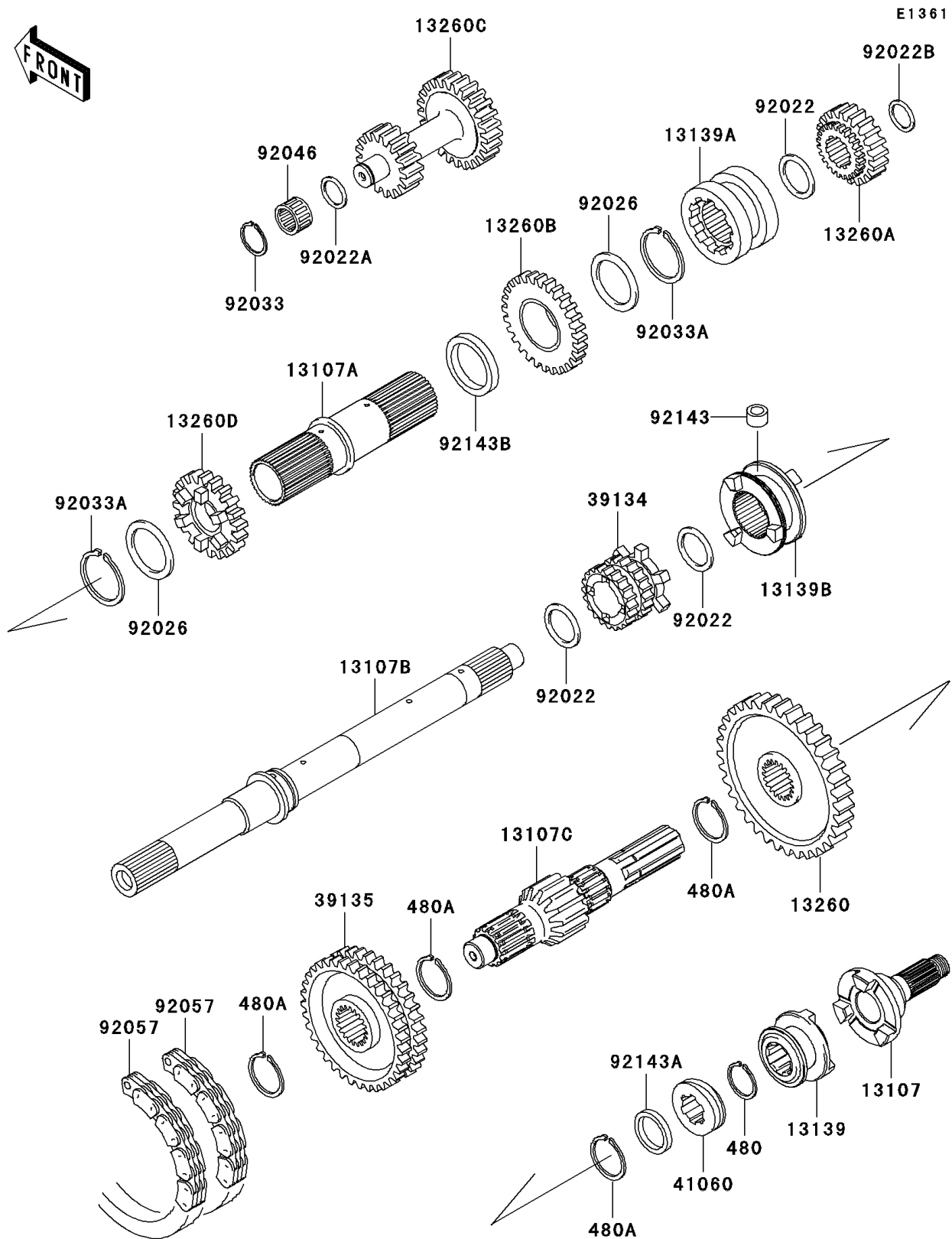

2008 MULE™ 3010 Trans4x4 Diesel PARTS LIST

Transmission

| ITEM NAME | PART NUMBER | QUANTITY |
|--|-------------|----------|
| CIRCLIP-TYPE-C,25MM (Ref # 480) | 480J2500 | 1 |
| CIRCLIP-TYPE-C,30MM (Ref # 480A) | 480J3000 | 1 |
| SHAFT,2WD/4WD (Ref # 13107) | 13107-0106 | 1 |
| SHAFT,INPUT OUTER (Ref # 13107A) | 13107-1309 | 1 |
| SHAFT,INPUT (Ref # 13107B) | 13107-1512 | 1 |
| SHAFT,OUTPUT,14T (Ref # 13107C) | 13107-1517 | 1 |
| SHIFTER,2WD/4WD (Ref # 13139) | 13139-0010 | 1 |
| SHIFTER,SPEED,HI/LOW (Ref # 13139A) | 13139-1069 | 1 |
| SHIFTER,FR/RR (Ref # 13139B) | 13139-1072 | 1 |
| GEAR,OUTPUT REVERSE,51T (Ref # 13260) | 13260-1288 | 1 |
| GEAR,INPUT REDUCTION,20T (Ref # 13260A) | 13260-1289 | 1 |
| GEAR,INPUT REDUCTION,28T (Ref # 13260B) | 13260-1290 | 1 |
| GEAR,REDUCTION,17T&25T (Ref # 13260C) | 13260-1291 | 1 |
| GEAR,INPUT 28T (Ref # 13260D) | 13260-1462 | 1 |
| SPROCKET-DRIVE,20T (Ref # 39134) | 39134-1055 | 1 |
| SPROCKET-DRIVEN,41T (Ref # 39135) | 39135-1055 | 1 |
| GEAR-METER SCREW (Ref # 41060) | 41060-1147 | 1 |
| WASHER,25.3X33X1 (Ref # 92022) | 92022-1109 | 1 |
| WASHER,17.3X28X1 (Ref # 92022A) | 92022-255 | 1 |
| WASHER,17.3X30X1.4 (Ref # 92022B) | 92022-270 | 1 |
| SPACER,35.3X44X0.5 (Ref # 92026) | 92026-1375 | 1 |
| RING-SNAP (Ref # 92033) | 92033-032 | 1 |
| RING-SNAP (Ref # 92033A) | 92033-1269 | 1 |
| BEARING-NEEDLE,K17X23X13.8 (Ref # 92046) | 92046-1184 | 1 |
| CHAIN,REVERSE,81RH2520,54L (Ref # 92057) | 92057-1364 | 1 |
| COLLAR,8X14X10.5 (Ref # 92143) | 92143-1497 | 1 |
| COLLAR,25X32X4.5 (Ref # 92143A) | 92143-1597 | 1 |
| COLLAR (Ref # 92143B) | 92143-1599 | 1 |