

## 1989 NINJA® ZX™-7 PARTS DIAGRAM

Generator

E1810

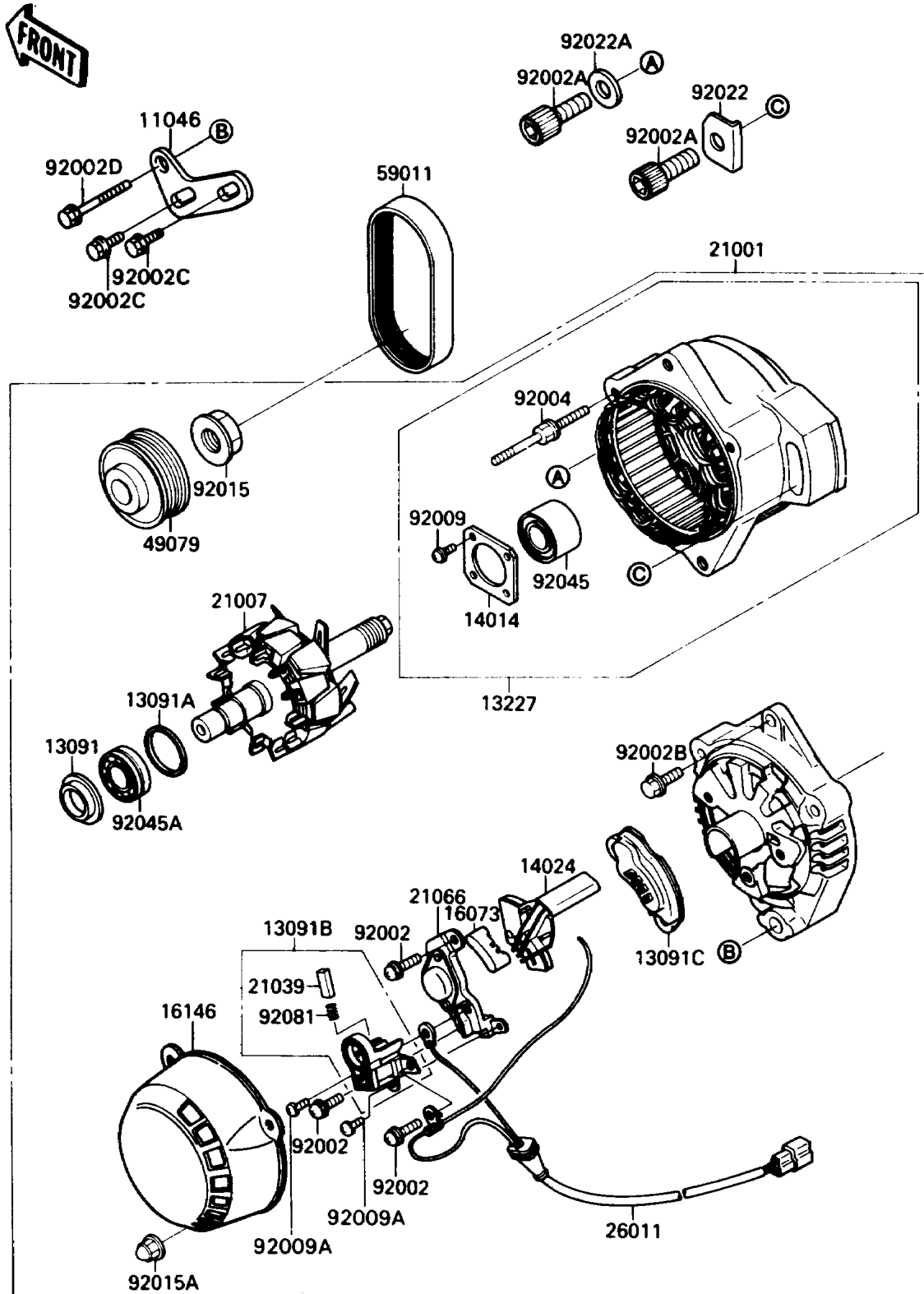

## 1989 NINJA® ZX™-7 PARTS LIST

Generator

| ITEM NAME                          | PART NUMBER | QUANTITY |
|------------------------------------|-------------|----------|
| BRACKET,GENERATOR (Ref # 11046)    | 11046-1717  | 1        |
| HOLDER,COVER (Ref # 13091)         | 13091-1327  | 1        |
| HOLDER,BEARING (Ref # 13091A)      | 13091-1328  | 1        |
| HOLDER,BRUSH (Ref # 13091B)        | 13091-1465  | 1        |
| RECTIFIER (Ref # 13091C)           | 13091-1466  | 1        |
| HOUSING,GENERATOR (Ref # 13227)    | 13227-1078  | 1        |
| PLATE-POSITION (Ref # 14014)       | 14014-1085  | 1        |
| COVER,RECTIFIER (Ref # 14024)      | 14025-1942  | 1        |
| INSULATOR (Ref # 16073)            | 16073-1062  | 1        |
| COVER-ASSY,GENERATOR (Ref # 16146) | 16146-1100  | 1        |
| GENERATOR (Ref # 21001)            | 21001-1098  | 1        |
| ROTOR,GENERATOR (Ref # 21007)      | 21007-1194  | 1        |
| BRUSH,CARBON (Ref # 21039)         | 21039-1052  | 1        |
| REGULATOR-VOLTAGE (Ref # 21066)    | 21066-1056  | 1        |
| WIRE-LEAD,GENERATOR (Ref # 26011)  | 26011-1461  | 1        |
| PULLEY-BELT (Ref # 49079)          | 49079-1058  | 1        |
| BELT,GENERATOR (Ref # 59011)       | 59011-1054  | 1        |
| SCREW,5X17.5 (Ref # 92002)         | 92002-1380  | 1        |
| BOLT,SOCKET,10X45 (Ref # 92002A)   | 92002-1854  | 1        |
| BOLT (Ref # 92002B)                | 92002-1919  | 1        |
| BOLT,6X16 (Ref # 92002C)           | 92002-1933  | 1        |
| BOLT,8X50 (Ref # 92002D)           | 92002-1934  | 1        |
| STUD (Ref # 92004)                 | 92004-1196  | 1        |
| SCREW (Ref # 92009)                | 92009-1462  | 1        |
| SCREW (Ref # 92009A)               | 92009-1585  | 1        |
| NUT,PULLEY LOCK (Ref # 92015)      | 92015-1650  | 1        |
| NUT (Ref # 92015A)                 | 92015-1800  | 1        |
| WASHER (Ref # 92022)               | 92022-1819  | 1        |
| WASHER,10.5X19X3.2 (Ref # 92022A)  | 92022-1820  | 1        |

## 1989 NINJA® ZX™-7 PARTS LIST

Generator

| ITEM NAME                           | PART NUMBER | QUANTITY |
|-------------------------------------|-------------|----------|
| BEARING-BALL (Ref # 92045)          | 92045-1195  | 1        |
| BEARING-BALL,#6002NC (Ref # 92045A) | 92045-1237  | 1        |
| SPRING,BRUSH (Ref # 92081)          | 92081-1759  | 1        |