

2010 KX™85 PARTS DIAGRAM

Clutch

E1350

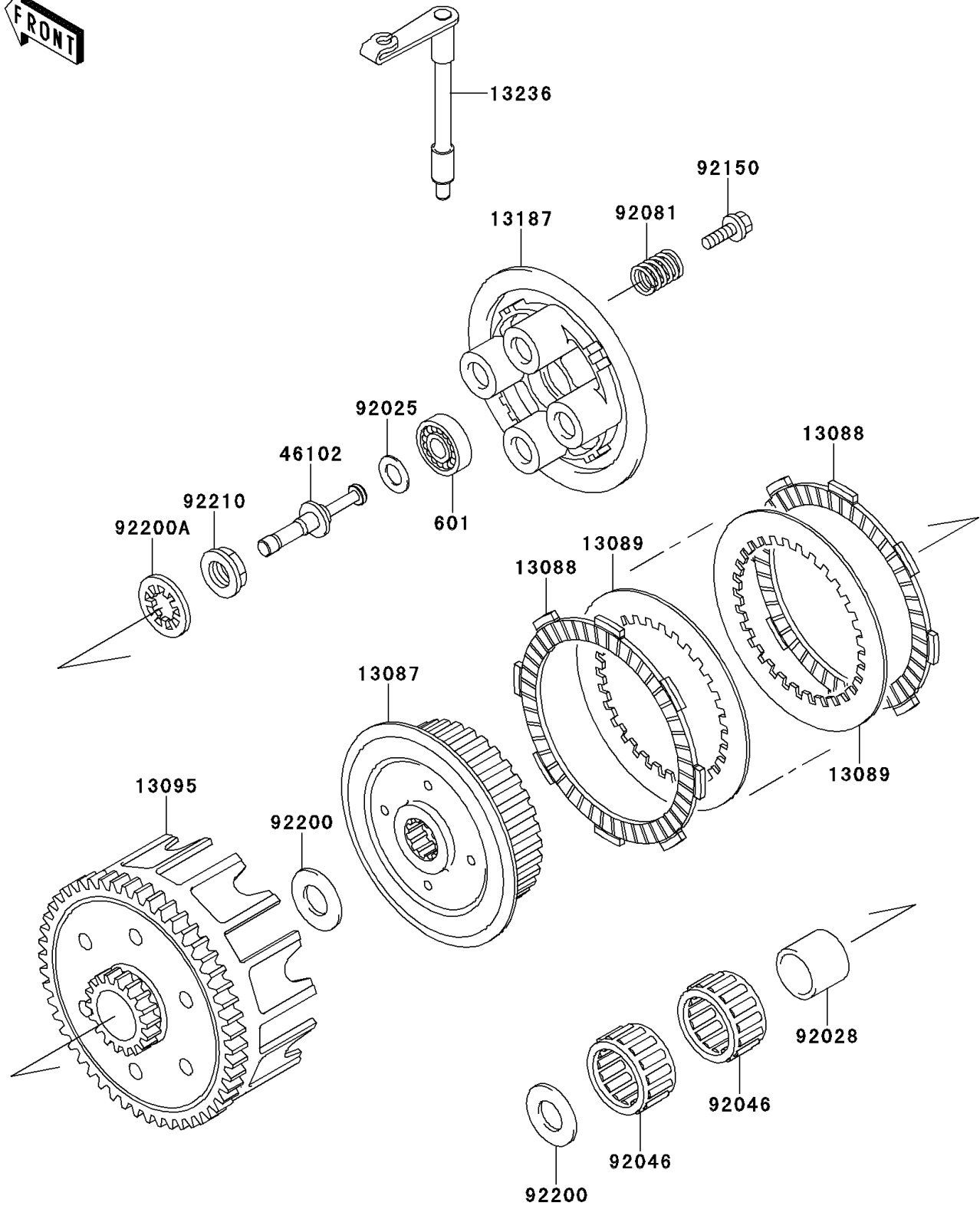

2010 KX™85 PARTS LIST

Clutch

| ITEM NAME | PART NUMBER | QUANTITY |
|---|-------------|----------|
| BEARING-BALL (Ref # 601) | 601A6001 | 1 |
| HUB-CLUTCH (Ref # 13087) | 13087-1170 | 1 |
| PLATE-FRICTION,ID=91 (Ref # 13088) | 13088-1016 | 1 |
| PLATE-CLUTCH (Ref # 13089) | 13089-1120 | 1 |
| HOUSING-COMP-CLUTCH (Ref # 13095) | 13095-1406 | 1 |
| PLATE-CLUTCH OPERATING (Ref # 13187) | 13187-1013 | 1 |
| LEVER-COMP,RELEASE (Ref # 13236) | 13236-1298 | 1 |
| ROD,CLUTCH RELEASE (Ref # 46102) | 46102-1409 | 1 |
| SHIM (Ref # 92025) | 92025-1780 | 1 |
| BUSHING,20X25X21.1 (Ref # 92028) | 92028-1811 | 1 |
| BEARING-NEEDLE,KT252910EG (Ref # 92046) | 92046-1254 | 1 |
| SPRING,CLUTCH (Ref # 92081) | 92081-1492 | 1 |
| BOLT,6X20,WASHER (Ref # 92150) | 92150-1715 | 1 |
| WASHER,20.3X33X2.0 (Ref # 92200) | 92200-1351 | 1 |
| WASHER,20X30X2.6 (Ref # 92200A) | 92200-1352 | 1 |
| NUT,16MM (Ref # 92210) | 92210-1113 | 1 |