

1986 Concours™ PARTS DIAGRAM

Transmission

E1361-0159

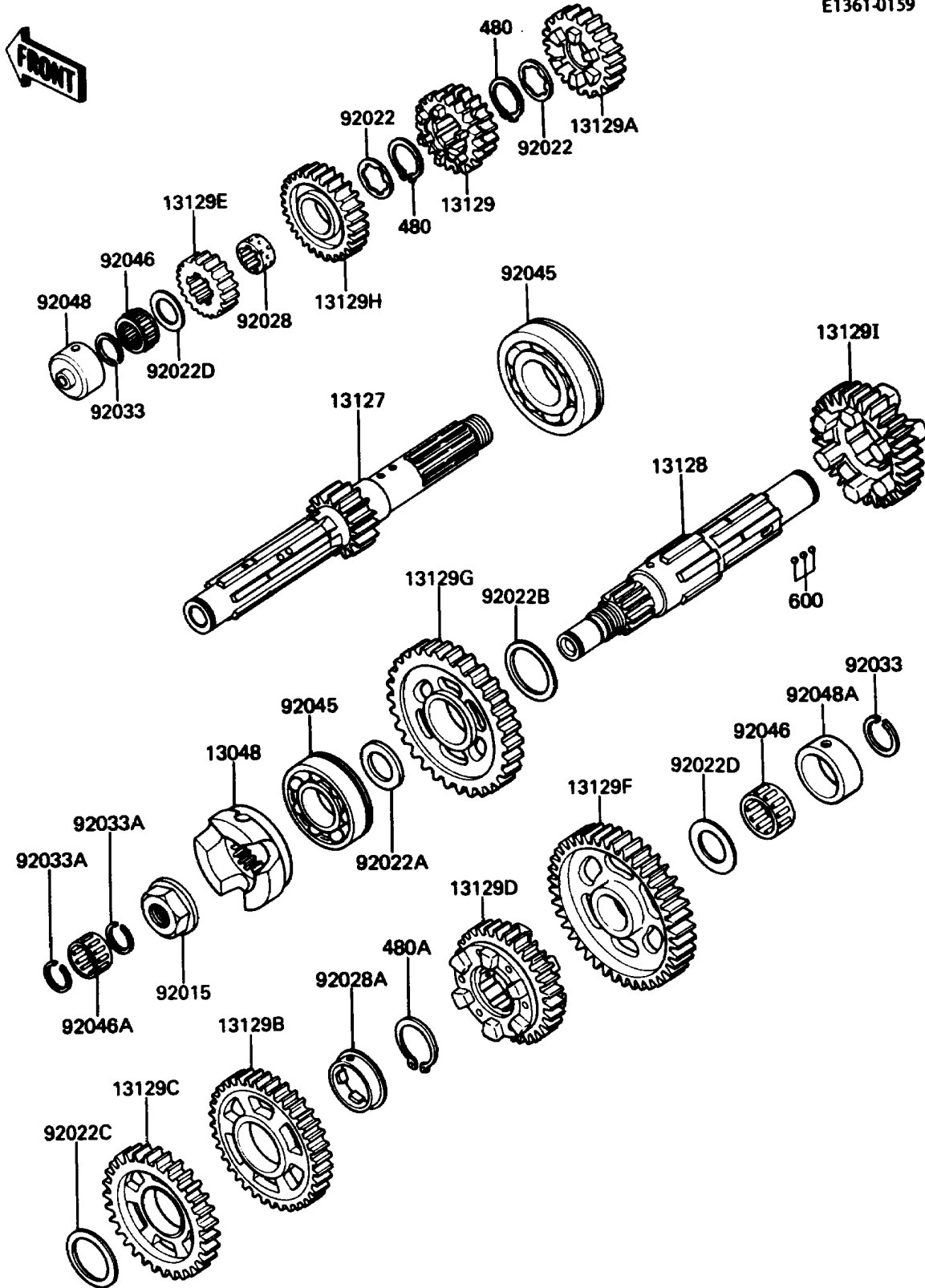

1986 Concours™ PARTS LIST

Transmission

ITEM NAME	PART NUMBER	QUANTITY
CAM-DAMPER (Ref # 13048)	13048-1060	1
SHAFT-TRANSMISSION INPUT,14T (Ref # 13127)	13127-1135	1
SHAFT-TRANSMISSION OUTPUT (Ref # 13128)	13128-1138	1
GEAR,INPUT 3RD&4TH,24T&22T (Ref # 13129)	13129-1664	1
GEAR,INPUT 5TH,26T (Ref # 13129A)	13129-1665	1
GEAR,OUTPUT 3RD,35T (Ref # 13129B)	13129-1775	1
GEAR,OUTPUT 4TH,32T (Ref # 13129C)	13129-1776	1
GEAR,OUTPUT 5TH,30T (Ref # 13129D)	13129-1777	1
GEAR,INPUT 2ND,18T (Ref # 13129E)	13129-1784	1
GEAR,OUTPUT LOW,43T (Ref # 13129F)	13129-1785	1
GEAR,OUTPUT 2ND,37T (Ref # 13129G)	13129-1786	1
GEAR,INPUT TOP,29T (Ref # 13129H)	13129-1825	1
GEAR,OUTPUT TOP,28T (Ref # 13129I)	13129-1826	1
NUT,20MM (Ref # 92015)	92015-1610	1
WASHER,TOOTHED,26X35.5X1.5 (Ref # 92022)	92022-1077	1
WASHER,28.3X42X2.9 (Ref # 92022A)	92022-1219	1
WASHER,32X40X1.6 (Ref # 92022B)	92022-1693	1
WASHER,30X38X2.0 (Ref # 92022C)	92022-1694	1
WASHER,22.3X35X1.6 (Ref # 92022D)	92022-212	1
BUSHING, TOP GEAR (Ref # 92028)	92028-1124	1
BUSHING,OUTPUT 3RD GEAR (Ref # 92028A)	92028-1374	1
RING-SNAP,20X25.5X1.2 (Ref # 92033)	92033-025	1
RING-SNAP (Ref # 92033A)	92033-028	1
BEARING-BALL (Ref # 92045)	92045-1186	1
BEARING-NEEDLE,FWF-223014 (Ref # 92046)	92046-031	1
BEARING-NEEDLE,K17X23X17 (Ref # 92046A)	92046-1145	1
RACE,INPUT SHAFT (Ref # 92048)	92048-1052	1
RACE,30X38X15 (Ref # 92048A)	92048-1053	1
CIRCLIP-TYPE-C,28MM (Ref # 480)	480J2800	1

1986 Concours™ PARTS LIST

Transmission

ITEM NAME	PART NUMBER	QUANTITY
CIRCLIP (Ref # 480A)	480J2900	1
BALL-STEEL,5/32" (Ref # 600)	600A0500	1