

2006 Vulcan® 800 Drifter® PARTS DIAGRAM

Front Fork

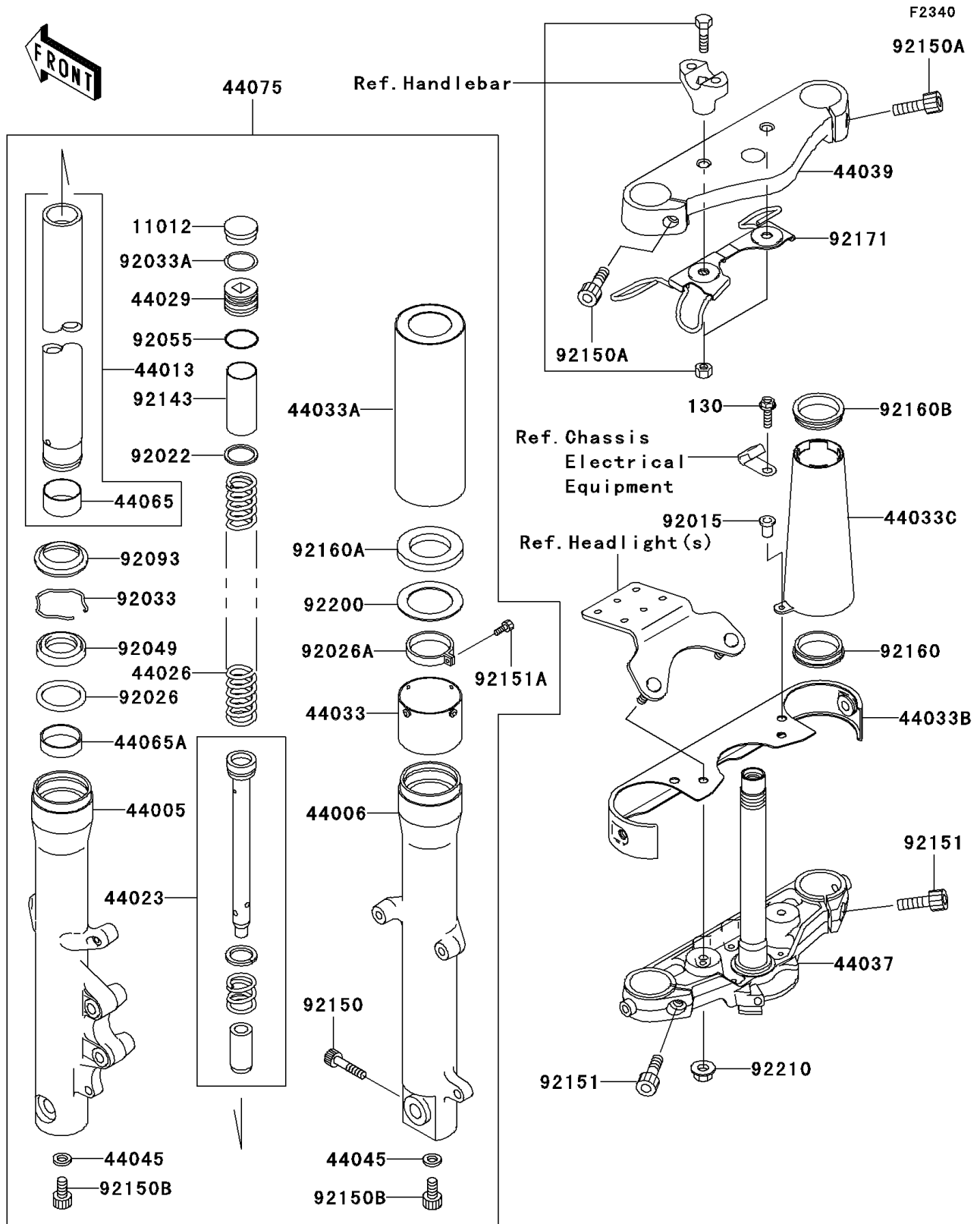

2006 Vulcan® 800 Drifter® PARTS LIST

Front Fork

ITEM NAME	PART NUMBER	QUANTITY
BOLT-FLANGED,5X16 (Ref # 130)	130J0516	1
CAP,FORK TOP (Ref # 11012)	11012-1618	1
PIPE-LEFT FORK OUTER (Ref # 44005)	44005-1415	1
PIPE-RIGHT FORK OUTER (Ref # 44006)	44006-1415	1
PIPE-FORK INNER (Ref # 44013)	44013-1467	1
CYLINDER-SET-FORK (Ref # 44023)	44023-1140	1
SPRING-FRONT FORK (Ref # 44026)	44026-1698	1
SEAT-FORK SPRING (Ref # 44029)	44029-1125	1
COVER-FORK (Ref # 44033)	44033-1252	1
COVER-FORK (Ref # 44033A)	44033-1261	1
COVER-FORK,UNDER BRACKET (Ref # 44033B)	44033-1264	1
COVER-FORK,INNER TUBE (Ref # 44033C)	44033-1265	1
HOLDER-FORK UNDER (Ref # 44037)	44037-1413	1
HOLDER-FORK UPPER (Ref # 44039)	44039-1314	1
GASKET,FORK CYLINDER BOLT (Ref # 44045)	44045-051	1
BUSHING-FRONT FORK,INNER PIPE (Ref # 44065)	44065-1131	1
BUSHING-FRONT FORK (Ref # 44065A)	44065-1132	1
DAMPER-SET-FORK (Ref # 44075)	44075-1140	1
NUT,WELL,5MM (Ref # 92015)	92015-1757	1
WASHER (Ref # 92022)	92022-1909	1
SPACER,FORK OUTER (Ref # 92026)	92026-1276	1
SPACER (Ref # 92026A)	92026-1515	1
RING-SNAP (Ref # 92033)	92033-1222	1
RING-SNAP,SPRING SEAT (Ref # 92033A)	92033-1223	1
SEAL-OIL,FORK (Ref # 92049)	92049-1363	1
RING-O,SPRING SEAT (Ref # 92055)	92055-1363	1
SEAL,FORK (Ref # 92093)	92093-1268	1
COLLAR,FORK,L=100 (Ref # 92143)	92143-1923	1
BOLT,SOCKET,10X40 (Ref # 92150)	92150-1029	1

2006 Vulcan® 800 Drifter® PARTS LIST

Front Fork

ITEM NAME	PART NUMBER	QUANTITY
BOLT,SOCKET,8X30 (Ref # 92150A)	92150-1031	1
BOLT,SOCKET,8X18 (Ref # 92150B)	92150-1432	1
BOLT,SOCKET,10X25 (Ref # 92151)	92151-1083	1
BOLT,SOCKET,4X16 (Ref # 92151A)	92151-1356	1
DAMPER (Ref # 92160)	92160-1892	1
DAMPER (Ref # 92160A)	92160-1927	1
DAMPER (Ref # 92160B)	92160-1968	1
CLAMP,CABLE (Ref # 92171)	92171-1339	1
WASHER (Ref # 92200)	92200-1417	1
NUT,FLANGED,8MM (Ref # 92210)	92210-0004	1