

1994 Vulcan® 750 PARTS DIAGRAM

Footrests

F2160

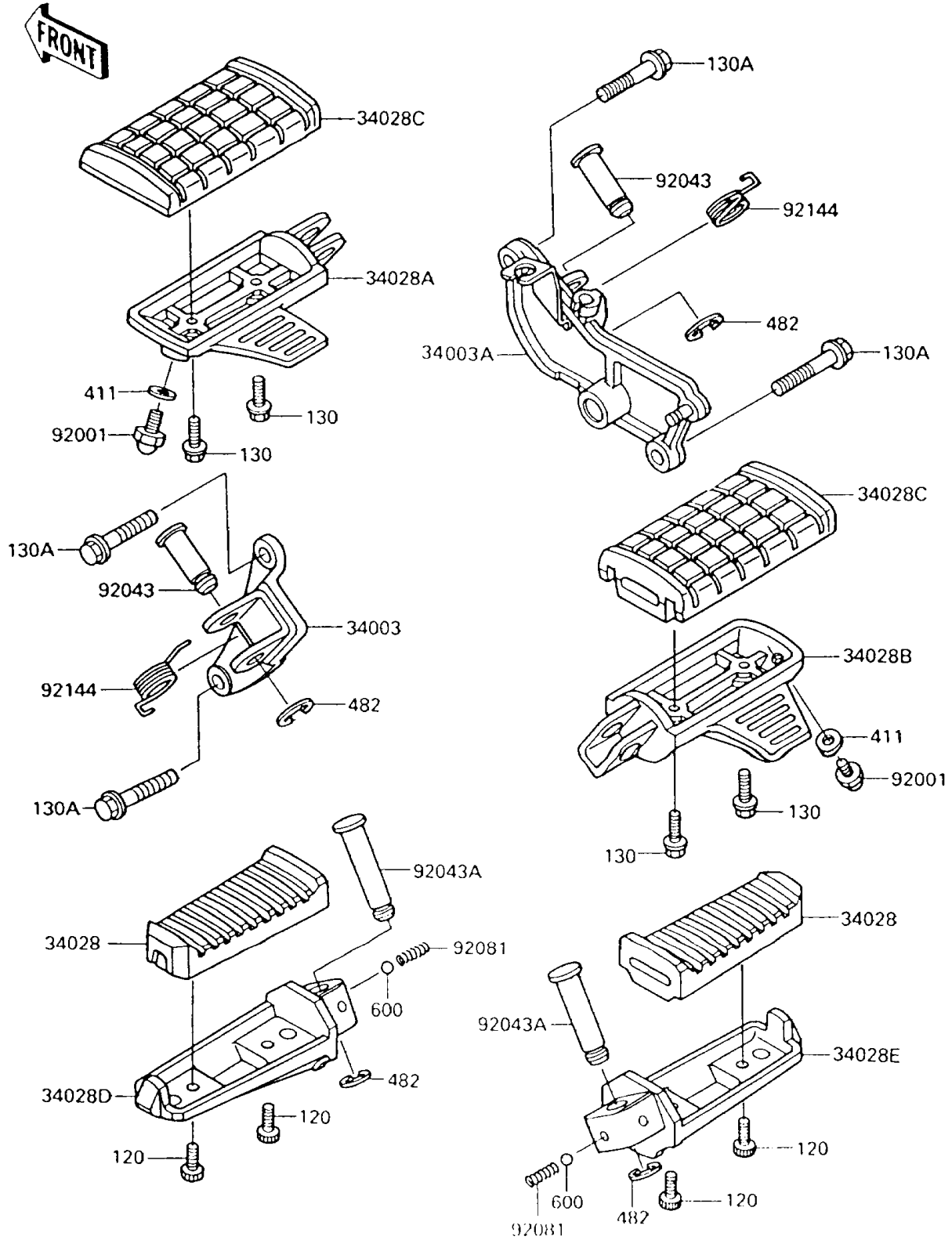

1994 Vulcan® 750 PARTS LIST

Footrests

| ITEM NAME | PART NUMBER | QUANTITY |
|-----------------------------------|-------------|----------|
| BOLT-SOCKET (Ref # 120) | 120Z0514 | 1 |
| BOLT-FLANGED,5X12 (Ref # 130) | 130D0512 | 1 |
| BOLT-FLANGED,10X30 (Ref # 130A) | 130J1030 | 1 |
| WASHER-PLAIN,6MM (Ref # 411) | 411B0600 | 1 |
| CIRCLIP-TYPE-E,10MM (Ref # 482) | 482L0100 | 1 |
| BALL-STEEL,1/4" (Ref # 600) | 600A0800 | 1 |
| HOLDER-STEP,FR,LH (Ref # 34003) | 34003-1225 | 1 |
| HOLDER-STEP,FR,RH (Ref # 34003A) | 34003-1226 | 1 |
| STEP,RR,RUBBER (Ref # 34028) | 34028-1060 | 1 |
| STEP,FR,LH (Ref # 34028A) | 34028-1147 | 1 |
| STEP,FR,RH (Ref # 34028B) | 34028-1148 | 1 |
| STEP,FR,RUBBER (Ref # 34028C) | 34028-1149 | 1 |
| STEP,RR,LH (Ref # 34028D) | 34028-1175 | 1 |
| STEP,RR,RH (Ref # 34028E) | 34028-1176 | 1 |
| BOLT,6X10 (Ref # 92001) | 92001-1905 | 1 |
| PIN,12X37 (Ref # 92043) | 92043-1144 | 1 |
| PIN,12X42.5 (Ref # 92043A) | 92043-1145 | 1 |
| SPRING,COIL,STEP,RR (Ref # 92081) | 92081-1588 | 1 |
| SPRING,STEP RETURN (Ref # 92144) | 92144-1568 | 1 |