

1994 Vulcan® 750 PARTS DIAGRAM

Transmission

E1361

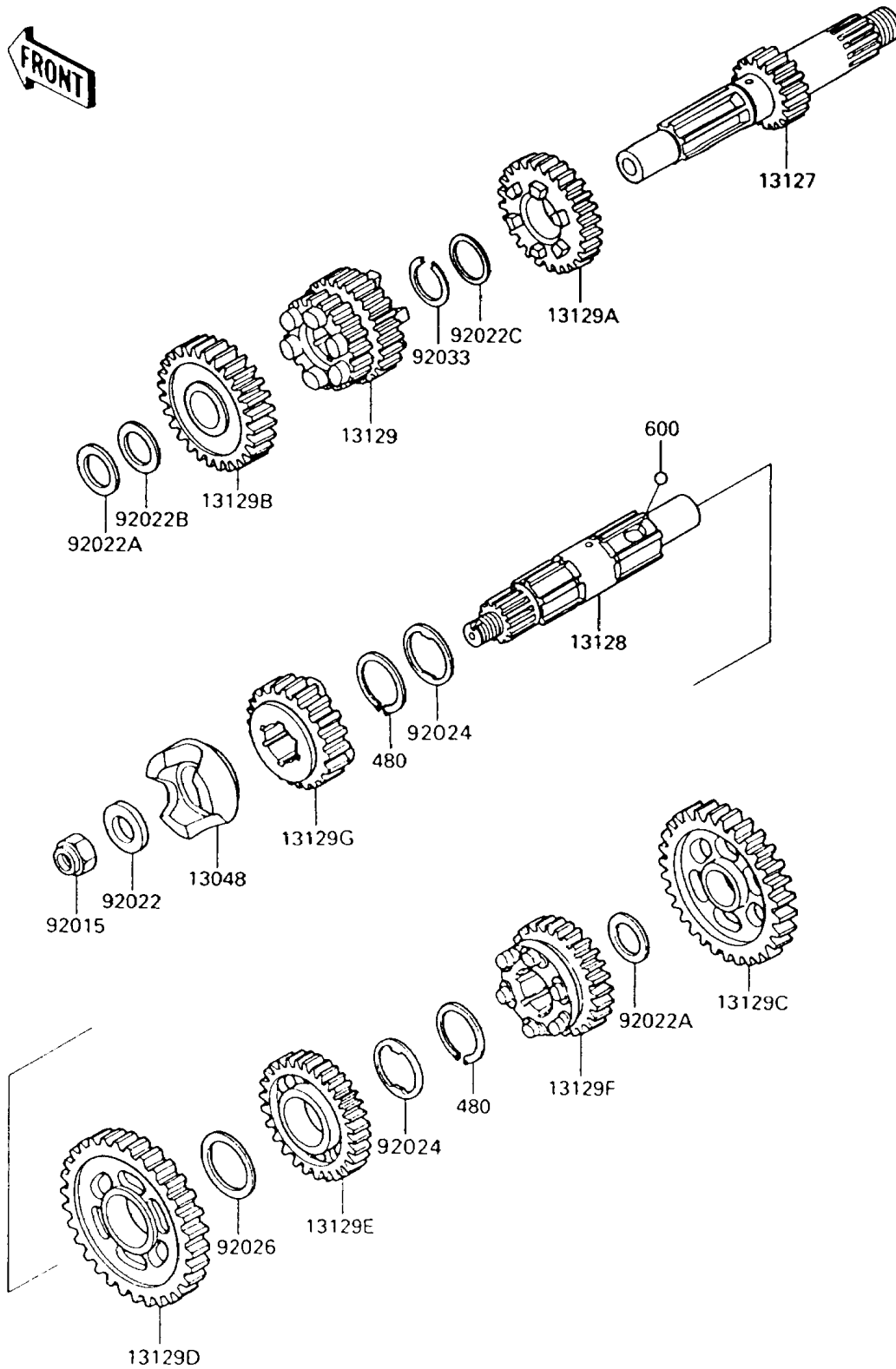

1994 Vulcan® 750 PARTS LIST

Transmission

ITEM NAME	PART NUMBER	QUANTITY
CIRCLIP-TYPE-C,30MM (Ref # 480)	480J3000	1
BALL-STEEL,5/32" (Ref # 600)	600A0500	1
CAM-DAMPER,OUTPUT SHAFT (Ref # 13048)	13048-1014	1
SHAFT-TRANSMISSION INPUT (Ref # 13127)	13127-1240	1
SHAFT-TRANSMISSION OUTPUT (Ref # 13128)	13128-1114	1
GEAR,INPUT 2ND&3RD,20T&26T (Ref # 13129)	13129-1630	1
GEAR,INPUT 4TH,26T (Ref # 13129A)	13129-1631	1
GEAR,INPUT 5TH,28T (Ref # 13129B)	13129-1632	1
GEAR,OUTPUT LOW,36T (Ref # 13129C)	13129-1633	1
GEAR,OUTPUT 2ND,32T (Ref # 13129D)	13129-1634	1
GEAR,OUTPUT 3RD,32T (Ref # 13129E)	13129-1635	1
GEAR,OUTPUT 4TH,26T (Ref # 13129F)	13129-1636	1
GEAR,OUTPUT 5TH,24T (Ref # 13129G)	13129-1637	1
NUT,LOCK,14MM (Ref # 92015)	92015-1067	1
WASHER,14.1X31X5 (Ref # 92022)	92022-1115	1
WASHER,20.5X30X1,STEEL (Ref # 92022A)	92022-112	1
WASHER,20.5X30X0.5,STEEL (Ref # 92022B)	92022-144	1
WASHER,25.3X30X1 (Ref # 92022C)	92022-161	1
WASHER,TOOTHED,30.5X38X1 (Ref # 92024)	92024-069	1
SPACER,30X38X1.0 (Ref # 92026)	92026-079	1
RING-SNAP,24MM (Ref # 92033)	92033-026	1