

2006 Vulcan® 1500 Classic PARTS DIAGRAM

Frame

F2120

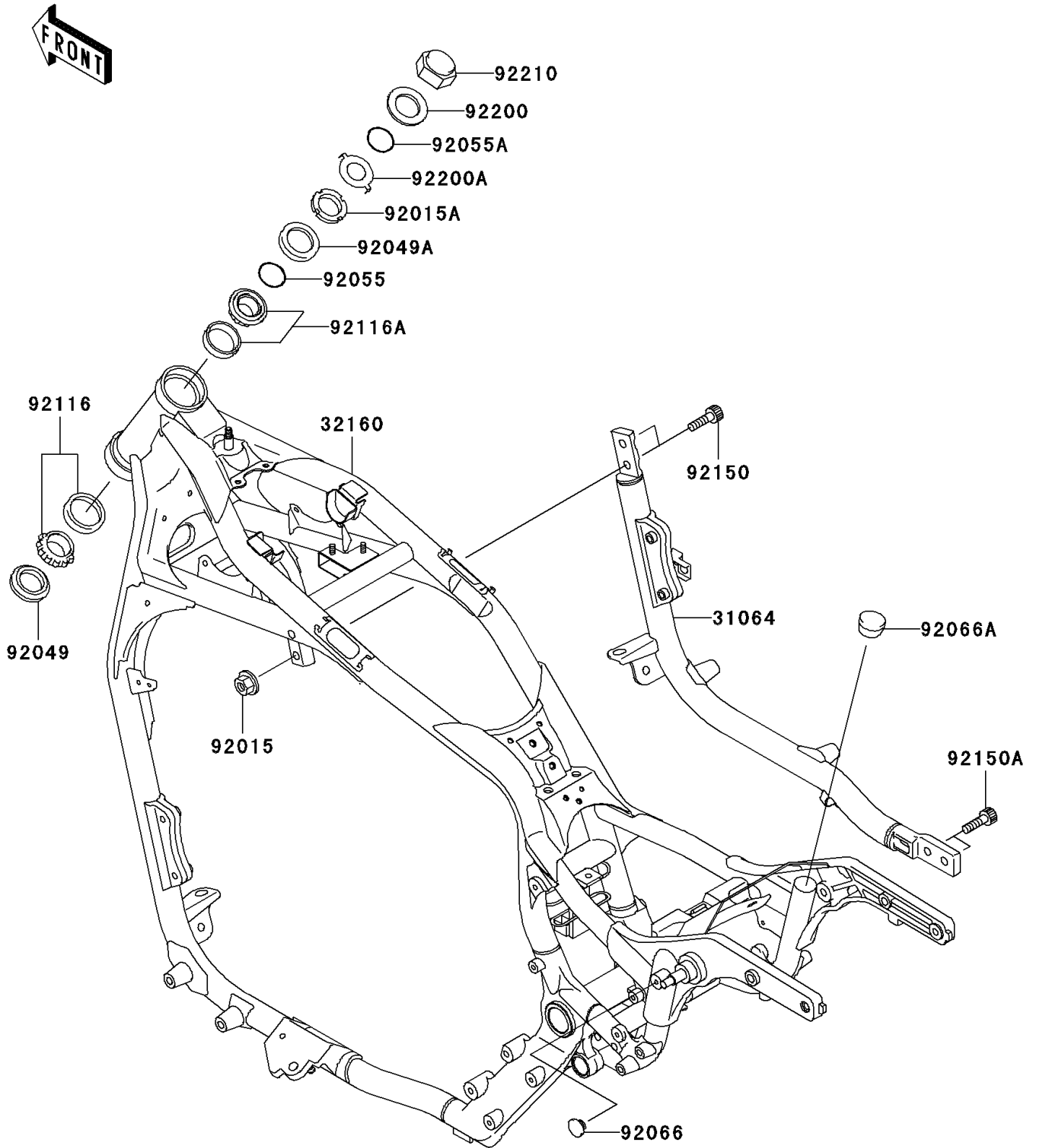

2006 Vulcan® 1500 Classic PARTS LIST

Frame

| ITEM NAME | PART NUMBER | QUANTITY |
|-----------------------------------------|-------------|----------|
| PIPE-COMP,DOWNTUBU,RH (Ref # 31064) | 31064-1237 | 1 |
| FRAME-COMP (Ref # 32160) | 32160-1679 | 1 |
| NUT,FLANGED,10MM (Ref # 92015) | 92015-1727 | 1 |
| NUT,STEERING STEM,35MM (Ref # 92015A) | 92015-1848 | 1 |
| SEAL-OIL,XMHE 43 55 4J (Ref # 92049) | 92049-1383 | 1 |
| SEAL-OIL,MX043N2 (Ref # 92049A) | 92049-1483 | 1 |
| RING-O,34.5X2.0 (Ref # 92055) | 92055-1452 | 1 |
| RING-O,ID=24.5 (Ref # 92055A) | 92055-1459 | 1 |
| PLUG,9.5X8,POLYETHYLENE (Ref # 92066) | 92066-1077 | 1 |
| PLUG (Ref # 92066A) | 92066-1444 | 1 |
| BEARING-ROLLER,32907JR-2 (Ref # 92116) | 92116-1072 | 1 |
| BEARING-ROLLER,32907JR-3 (Ref # 92116A) | 92116-1074 | 1 |
| BOLT,SOCKET,10X30 (Ref # 92150) | 92150-1690 | 1 |
| BOLT,SOCKET,10X23 (Ref # 92150A) | 92150-1942 | 1 |
| WASHER,25.5X42X2.3 (Ref # 92200) | 92200-0105 | 1 |
| WASHER,CLAW,25.5X40X2.3 (Ref # 92200A) | 92200-1083 | 1 |
| NUT,CAP,25MM (Ref # 92210) | 92210-1166 | 1 |