

1987 Vulcan® 88 PARTS DIAGRAM

Carburetor Parts

E1612-0118

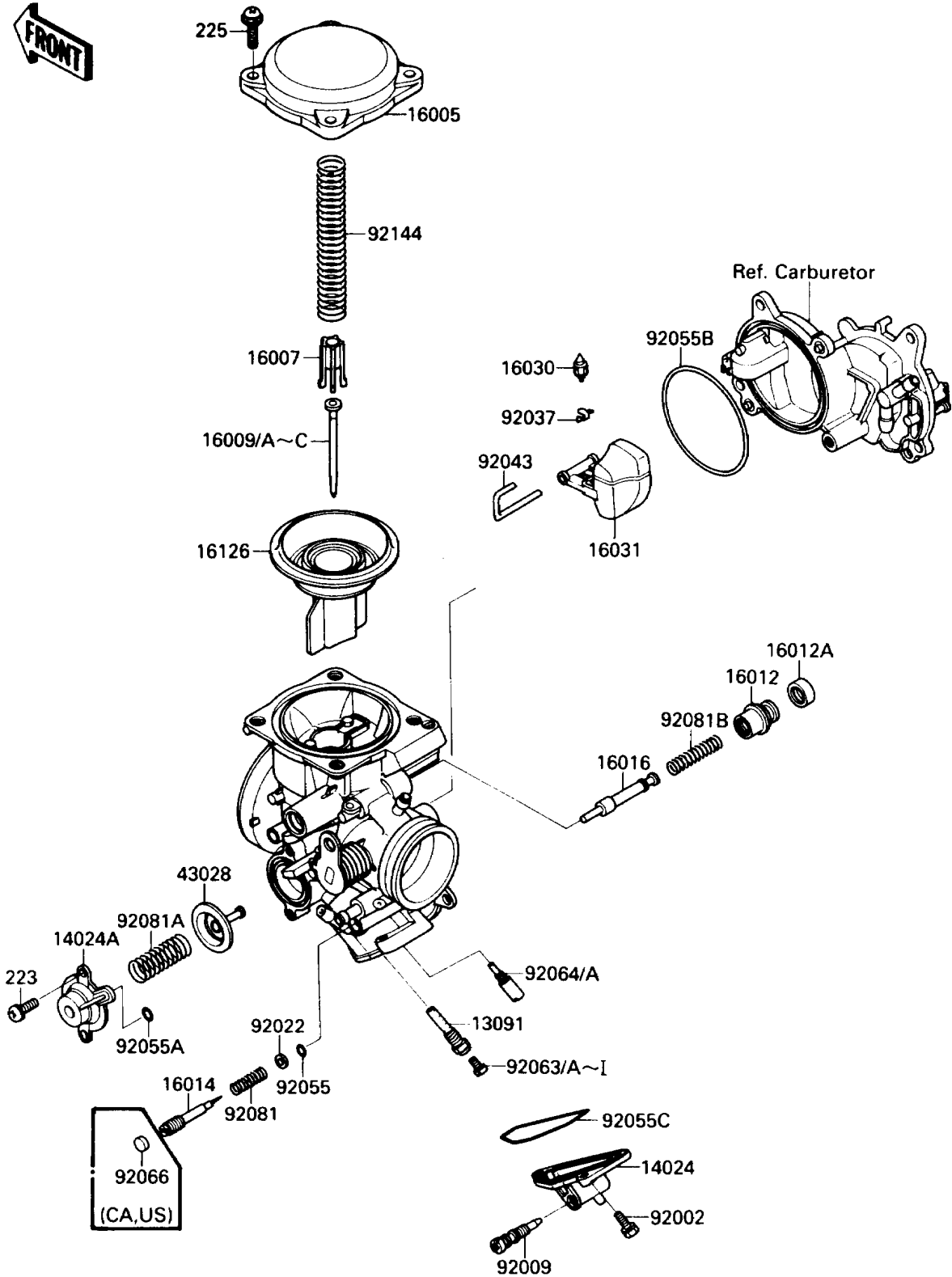

1987 Vulcan® 88 PARTS LIST

Carburetor Parts

ITEM NAME	PART NUMBER	QUANTITY
HOLDER,NEEDLE JET (Ref # 13091)	13091-1513	1
COVER,DRAIN (Ref # 14024)	14024-1608	1
COVER,AIR CUT VALVE (Ref # 14024A)	14025-1903	1
TOP-CHAMBER,MIXING (Ref # 16005)	16005-1054	1
SEAT-SPRING,VALVE (Ref # 16007)	16007-1117	1
NEEDLE-JET,RR,N53T (Ref # 16009)	16009-1361	1
NEEDLE-JET,FR,N53S (Ref # 16009A)	16009-1362	1
NEEDLE-JET,RR,N53V (Ref # 16009B)	16009-1363	1
NEEDLE-JET,FR,N53U (Ref # 16009C)	16009-1364	1
CAP-STARTER PLUNGER (Ref # 16012)	16012-1051	1
CAP-STARTER PLUNGER (Ref # 16012A)	16012-1052	1
SCREW-PILOT AIR (Ref # 16014)	16014-1054	1
PLUNGER (Ref # 16016)	16016-1071	1
VALVE-FLOAT (Ref # 16030)	16030-1007	1
FLOAT (Ref # 16031)	16031-1066	1
VALVE,VACUUM (Ref # 16126)	16126-1203	1
DIAPHRAGM,AIR CUT VALVE (Ref # 43028)	43028-1053	1
BOLT,4X14 (Ref # 92002)	92002-1761	1
SCREW,DRAIN (Ref # 92009)	92009-1434	1
WASHER,PLAIN (Ref # 92022)	92022-1003	1
CLAMP,FLOAT VALVE (Ref # 92037)	16044-007	1
PIN,FLOAT (Ref # 92043)	92043-1285	1
RING-O,PILOT ADJUST (Ref # 92055)	92055-1002	1
RING-O (Ref # 92055A)	92055-1245	1
RING-O (Ref # 92055B)	92055-1291	1
RING-O,DRAIN COVER (Ref # 92055C)	92055-1400	1
JET-MAIN,#118 (Ref # 92063)	92063-1071	2
JET-MAIN,#120 (Ref # 92063B)	92063-1072	1
JET-MAIN,2ND,#122 (Ref # 92063C)	92063-1073	1

1987 Vulcan® 88 PARTS LIST

Carburetor Parts

ITEM NAME	PART NUMBER	QUANTITY
JET-MAIN,#110 (Ref # 92063D)	92063-1114	1
JET-MAIN,#108 (Ref # 92063E)	92063-1116	1
JET-MAIN,#112 (Ref # 92063F)	92063-1117	2
JET-MAIN,#115 (Ref # 92063H)	92063-1118	2
JET-PILOT,#42 (Ref # 92064)	92064-1135	1
JET-PILOT,#40 (Ref # 92064A)	92064-1136	1
PLUG,PILOT AIR SCREW,6.9X2 (Ref # 92066)	92066-1051	1
SPRING,PILOT ADJUST SCREW (Ref # 92081)	92081-1002	1
SPRING,AIR CUT VALVE (Ref # 92081A)	92081-1719	1
SPRING,STARTER PLUNGER (Ref # 92081B)	92081-1761	1
SPRING,VACUUM VALVE (Ref # 92144)	92144-1219	1
SCREW-PAN-WS-CROS (Ref # 223)	223D0408	1
SCREW-PAN-WSP-CROS (Ref # 225)	225C0418	1