

1988 KX™80W PARTS DIAGRAM

Front Fork

F2340-0293

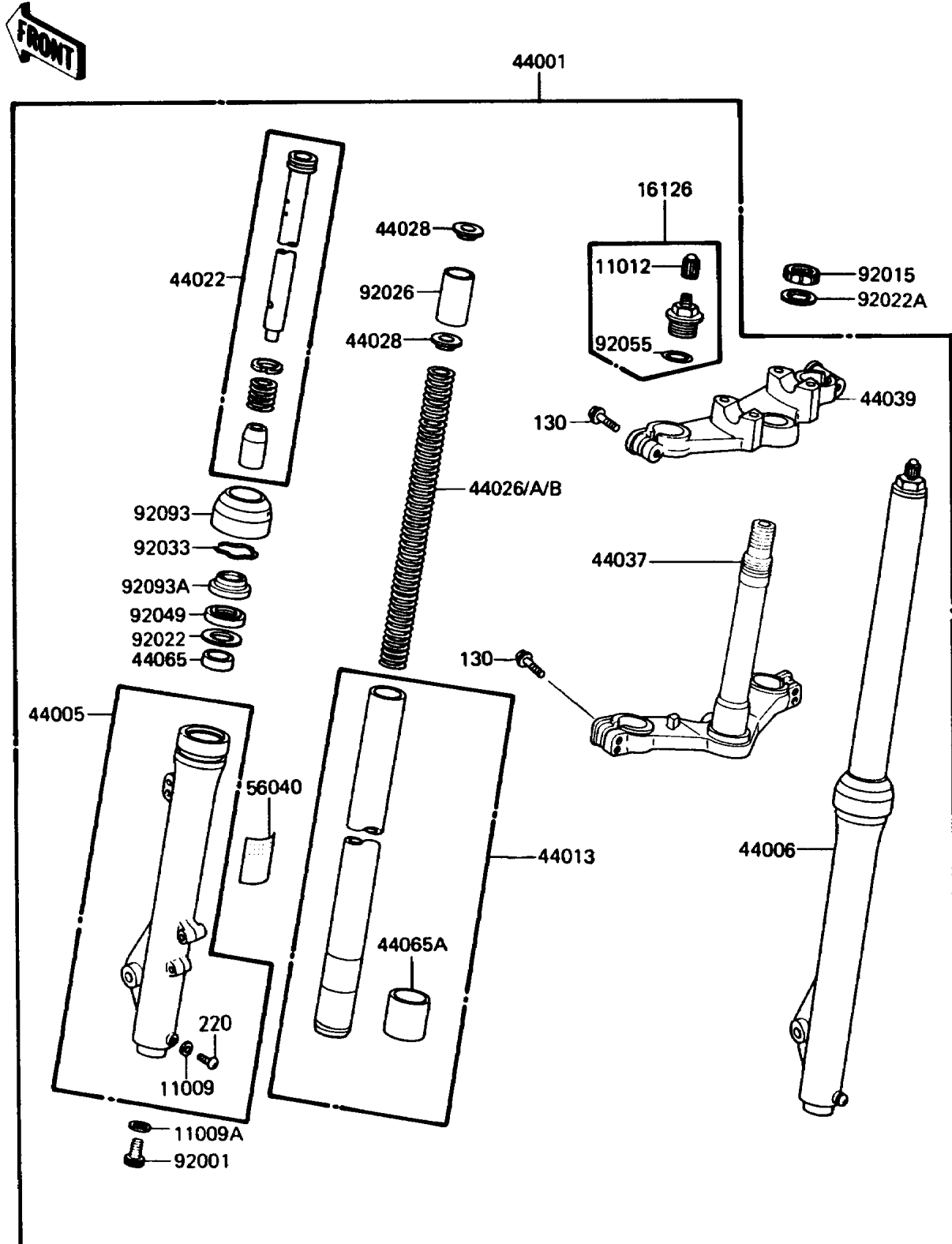

1988 KX™80W PARTS LIST

Front Fork

ITEM NAME	PART NUMBER	QUANTITY
GASKET,FORK DRAIN PLUG (Ref # 11009)	44045-002	1
GASKET (Ref # 11009A)	44045-057	1
CAP,VALVE AIR (Ref # 11012)	11012-1391	1
VALVE,AIR (Ref # 16126)	16126-1145	1
FORK-FRONT (Ref # 44001)	44001-1670	1
PIPE-LEFT FORK OUTER (Ref # 44005)	44005-1263	1
PIPE-RIGHT FORK OUTER (Ref # 44006)	44006-1260	1
PIPE-FORK INNER (Ref # 44013)	44013-1267	1
CYLINDER-FORK (Ref # 44022)	44022-1214	1
SPRING-FRONT FORK,K=0.28 (Ref # 44026)	44026-1371	1
SPRING-FRONT FORK,K=0.27 (Ref # 44026A)	44026-1389	1
SPRING-FRONT FORK,K=0.29 (Ref # 44026B)	44026-1390	1
GUIDE-FORK SPRING (Ref # 44028)	44028-1004	1
HOLDER-FORK UNDER (Ref # 44037)	44037-1225	1
HOLDER-FORK UPPER (Ref # 44039)	44039-1162	1
BUSHING-FRONT FORK (Ref # 44065)	44065-1065	1
BUSHING-FRONT FORK,INNER PIPE (Ref # 44065A)	44065-1075	1
LABEL-WARNING,FRONT FORK (Ref # 56040)	56040-1120	1
BOLT,SOCKET,FORK CYLINDER (Ref # 92001)	44041-040	1
NUT,STEERING STEM,22MM (Ref # 92015)	92015-1653	1
WASHER,FORK (Ref # 92022)	92022-1801	1
WASHER,STEERING STEM (Ref # 92022A)	92022-1873	1
SPACER,FORK,L=60 (Ref # 92026)	92026-1305	1
RING-SNAP (Ref # 92033)	44044-015	1
SEAL-OIL,FORK (Ref # 92049)	92049-1252	1
RING-O (Ref # 92055)	92055-1318	1
SEAL,FORK (Ref # 92093)	92093-1202	1
SEAL,FORK OUTER TUBE (Ref # 92093A)	92093-1250	1
BOLT-FLANGED,8X35 (Ref # 130)	130G0835	1

1988 KX™80W PARTS LIST

Front Fork

ITEM NAME	PART NUMBER	QUANTITY
SCREW-PAN-CROS (Ref # 220)	220B0408	1