

2006 KX™250F PARTS DIAGRAM

Shock Absorber(s)

F2280

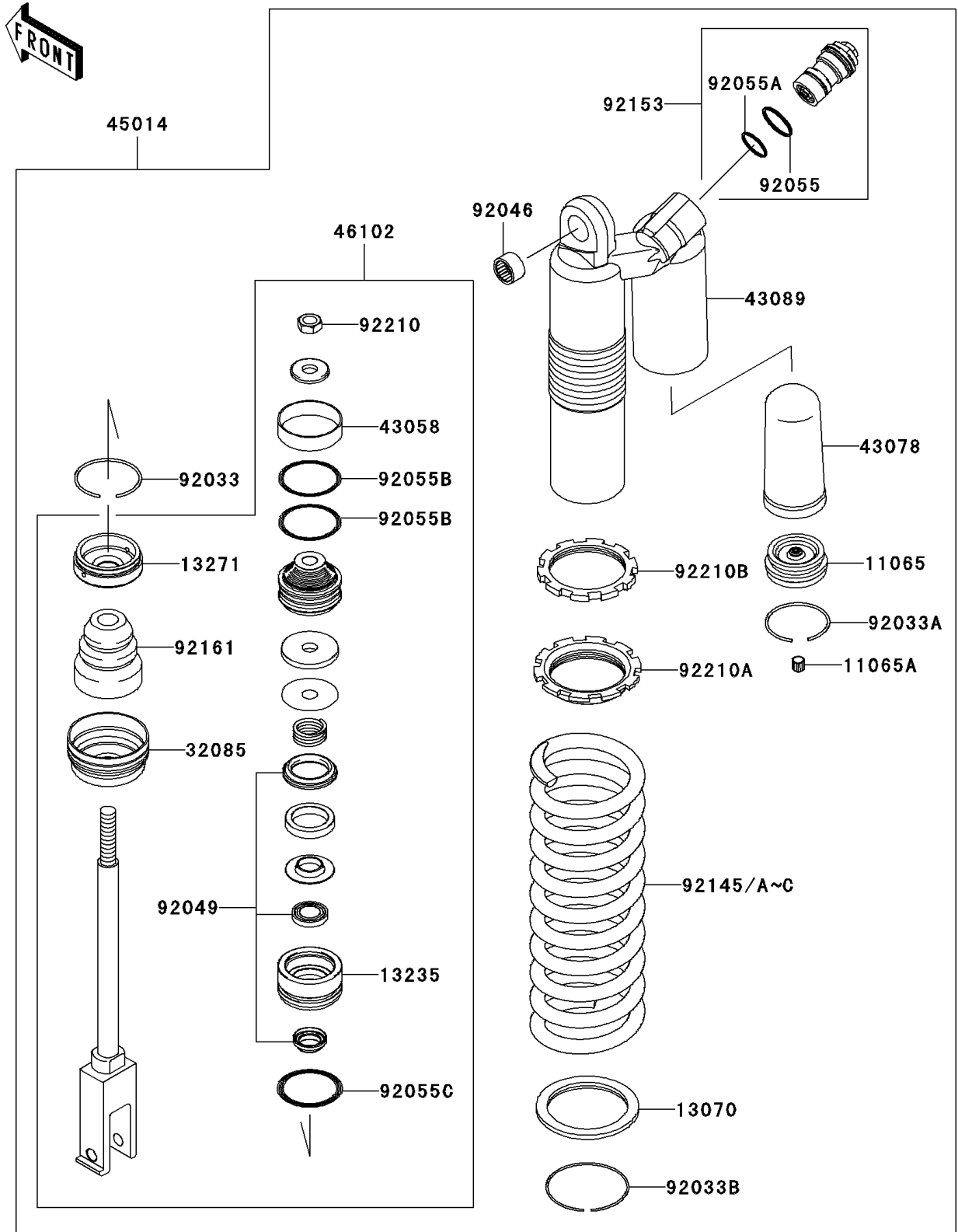

2006 KX™250F PARTS LIST

Shock Absorber(s)

| ITEM NAME | PART NUMBER | QUANTITY |
|---|----------------|----------|
| CAP,CHAMBER (Ref # 11065) | 11065-0144 | 1 |
| CAP,AIR VALVE (Ref # 11065A) | 11065-0145 | 1 |
| GUIDE,SPRING SEAT (Ref # 13070) | 13070-0057 | 1 |
| GUIDE-COMP,ROD (Ref # 13235) | 13235-0001 | 1 |
| PLATE,END (Ref # 13271) | 13271-0699 | 1 |
| STOPPER,SPRING SEAT (Ref # 32085) | 32085-0077 | 1 |
| RING,PISTON (Ref # 43058) | 43058-0012 | 1 |
| RESERVOIR (Ref # 43078) | 43078-0030 | 1 |
| CYLINDER-SHOCKABSORBER,GOLD (Ref # 43089) | 43089-0012-829 | 1 |
| SHOCKABSORBER (Ref # 45014) | 45014-5018 | 1 |
| ROD,PISTON (Ref # 46102) | 46102-0076 | 1 |
| RING-SNAP (Ref # 92033) | 92033-0040 | 1 |
| RING-SNAP (Ref # 92033A) | 92033-0041 | 1 |
| RING-SNAP (Ref # 92033B) | 92033-0042 | 1 |
| BEARING-NEEDLE,7E-HVS16X22X12 (Ref # 92046) | 92046-1301 | 1 |
| SEAL-OIL (Ref # 92049) | 92049-0075 | 1 |
| RING-O,PLUG BOLT (Ref # 92055) | 92055-0098 | 1 |
| RING-O,PLUG BOLT (Ref # 92055A) | 92055-0099 | 1 |
| RING-O (Ref # 92055B) | 92055-0100 | 1 |
| RING-O (Ref # 92055C) | 92055-0101 | 1 |
| SPRING,REAR SHOCK,K=52N/MM,SIL (Ref # 92145) | 92145-0321-8V | 1 |
| SPRING,REAR SHOCK,K=50N/MM,SIL (Ref # 92145A) | 92145-0346-8V | 1 |
| SPRING,REAR SHOCK,K=54N/MM,SIL (Ref # 92145B) | 92145-0347-8V | 1 |
| SPRING,REAR SHOCK,K=48N/MM,SIL (Ref # 92145C) | 92145-0411-8V | 1 |
| BOLT,PLUG (Ref # 92153) | 92153-1401 | 1 |
| DAMPER,STOPPER (Ref # 92161) | 92161-0329 | 1 |
| NUT,PISTON (Ref # 92210) | 92210-0270 | 1 |
| NUT,SPRING ADJUSTER (Ref # 92210A) | 92210-0271 | 1 |
| NUT,SPRING ADJUST NUT (Ref # 92210B) | 92210-0272 | 1 |