

2019 PARTS DIAGRAM

Chassis Electrical Equipment

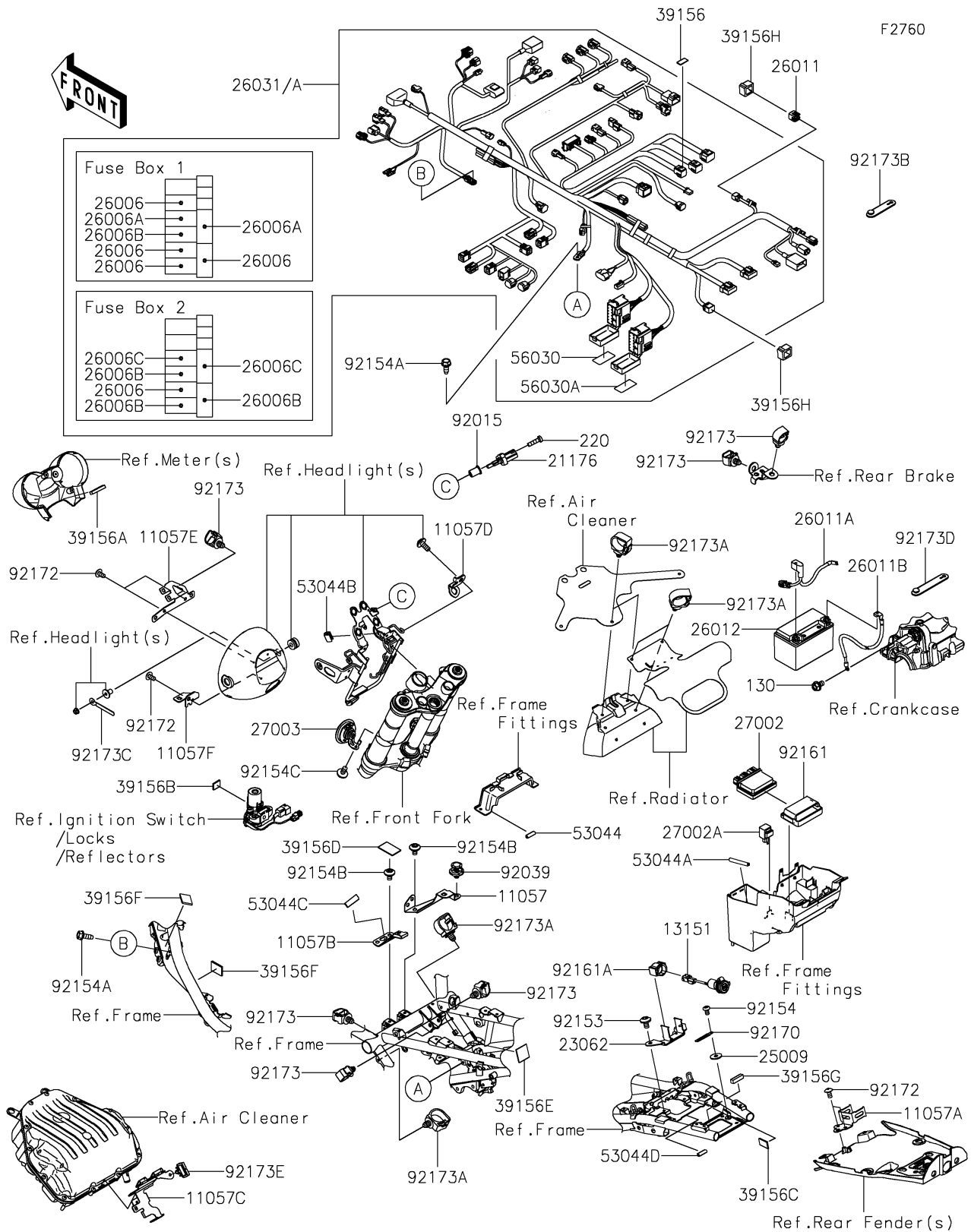

2019 PARTS LIST

Chassis Electrical Equipment

| ITEM NAME | PART NUMBER | QUANTITY |
|--|-------------|----------|
| BRACKET,MAIN HARNESS (Ref # 11057) | 11057-0915 | 1 |
| BRACKET,MAGNETIC SW. (Ref # 11057A) | 11057-0916 | 1 |
| BRACKET,FUEL PUMP CONNECTOR (Ref # 11057B) | 11057-0917 | 1 |
| BRACKET,AIR CLEANER (Ref # 11057C) | 11057-0918 | 1 |
| BRACKET,METER HARNESS (Ref # 11057D) | 11057-0919 | 1 |
| BRACKET,HEAD LAMP COVER,UPP (Ref # 11057E) | 11057-1322 | 1 |
| BRACKET,HEAD LAMP COVER,LWR (Ref # 11057F) | 11057-1323 | 1 |
| SWITCH-COMP,DC OUTLET (Ref # 13151) | 13151-0580 | 1 |
| SENSOR,AIR TEMPERATURE (Ref # 21176) | 21176-0048 | 1 |
| BRACKET-COMP,DC SOCKET (Ref # 23062) | 23062-1000 | 1 |
| WASHER,5.2X16X1.2 (Ref # 25009) | 25009-004 | 1 |
| FUSE,MINI BLADE,15A,BLUE (Ref # 26006) | 26006-0001 | 1 |
| FUSE,MINI BLADE,2A,GRAY (Ref # 26006A) | 26006-0052 | 1 |
| FUSE,MINI BLADE,7.5A,BROWN (Ref # 26006B) | 26006-0055 | 1 |
| FUSE,MINI BLADE,30A,GREEN (Ref # 26006C) | 26006-1080 | 1 |
| WIRE-LEAD,CONNECTOR COVER (Ref # 26011) | 26011-0275 | 1 |
| WIRE-LEAD,BATTERY(+) (Ref # 26011A) | 26011-0971 | 1 |
| WIRE-LEAD,BATTERY(-) (Ref # 26011B) | 26011-0972 | 1 |
| BATTERY,YTX9-BS,12V 8AH (Ref # 26012) | 26012-0838 | 1 |
| HARNESS,MAIN (Ref # 26031) | 26031-2449 | 1 |
| RELAY-ASSY,BOX (Ref # 27002) | 27002-0025 | 1 |
| RELAY-ASSY,SIGNAL LAMP (Ref # 27002A) | 27002-1097 | 1 |
| HORN (Ref # 27003) | 27003-0127 | 1 |
| PAD,10X20X1 (Ref # 39156) | 39156-2241 | 1 |
| PAD,8X50X10 (Ref # 39156A) | 39156-2283 | 1 |
| PAD,20X25X4 (Ref # 39156B) | 39156-2284 | 1 |
| PAD,20X40X4 (Ref # 39156C) | 39156-2285 | 1 |
| PAD,17X28X1 (Ref # 39156D) | 39156-2287 | 1 |
| PAD,20X20X1 (Ref # 39156E) | 39156-2288 | 1 |

2019 PARTS LIST

Chassis Electrical Equipment

| ITEM NAME | PART NUMBER | QUANTITY |
|-----------------------------------|-------------|----------|
| PAD,30X40X4 (Ref # 39156F) | 39156-2348 | 1 |
| PAD,10X40X10 (Ref # 39156G) | 39156-2350 | 1 |
| PAD,DIAG CONNECTOR (Ref # 39156H) | 39156-2361 | 1 |
| TRIM,L=30 (Ref # 53044) | 53044-0001 | 1 |
| TRIM (Ref # 53044A) | 53044-0018 | 1 |
| TRIM (Ref # 53044B) | 53044-0577 | 1 |
| TRIM,9X6.5X20 (Ref # 53044C) | 53044-0596 | 1 |
| TRIM,9X6.5X30 (Ref # 53044D) | 53044-0632 | 1 |
| BOLT-FLANGED,6X10 (Ref # 130) | 130BA0610 | 1 |
| SCREW-PAN-CROS,5X18 (Ref # 220) | 220AB0518 | 1 |
| LABEL,FUSE BOX1 (Ref # 56030) | 56030-1339 | 1 |
| LABEL,FUSE BOX2 (Ref # 56030A) | 56030-1340 | 1 |
| NUT,WELL,5MM (Ref # 92015) | 92015-1757 | 1 |
| RIVET,HOLE 8MM (Ref # 92039) | 92039-0014 | 1 |
| BOLT,SOCKET,6X10 (Ref # 92153) | 92153-1628 | 1 |
| BOLT (Ref # 92154) | 92154-0314 | 1 |
| BOLT,FLANGED,6X16 (Ref # 92154A) | 92154-0551 | 1 |
| BOLT,SOCKET,6X10 (Ref # 92154B) | 92154-0774 | 1 |
| BOLT,SOCKET,6X12 (Ref # 92154C) | 92154-2706 | 1 |
| DAMPER,RELAY BOX (Ref # 92161) | 92161-0203 | 1 |
| DAMPER,DC SOCKET (Ref # 92161A) | 92161-2069 | 1 |
| CLAMP (Ref # 92170) | 92170-1514 | 1 |
| SCREW,TAPPING,5X10 (Ref # 92172) | 92172-0262 | 1 |
| CLAMP,12MM DIA. (Ref # 92173) | 92173-0736 | 1 |
| CLAMP (Ref # 92173A) | 92173-0861 | 1 |
| CLAMP,RUBBER PLATE (Ref # 92173B) | 92173-1229 | 1 |
| CLAMP (Ref # 92173C) | 92173-1306 | 1 |
| CLAMP (Ref # 92173D) | 92173-1526 | 1 |
| CLAMP,SENSOR WIRE (Ref # 92173E) | 92173-1802 | 1 |