

## 2005 Prairie® 700 4x4 Team Green™ Special Edition PARTS DIAGRAM

Fuel Tank

F2410

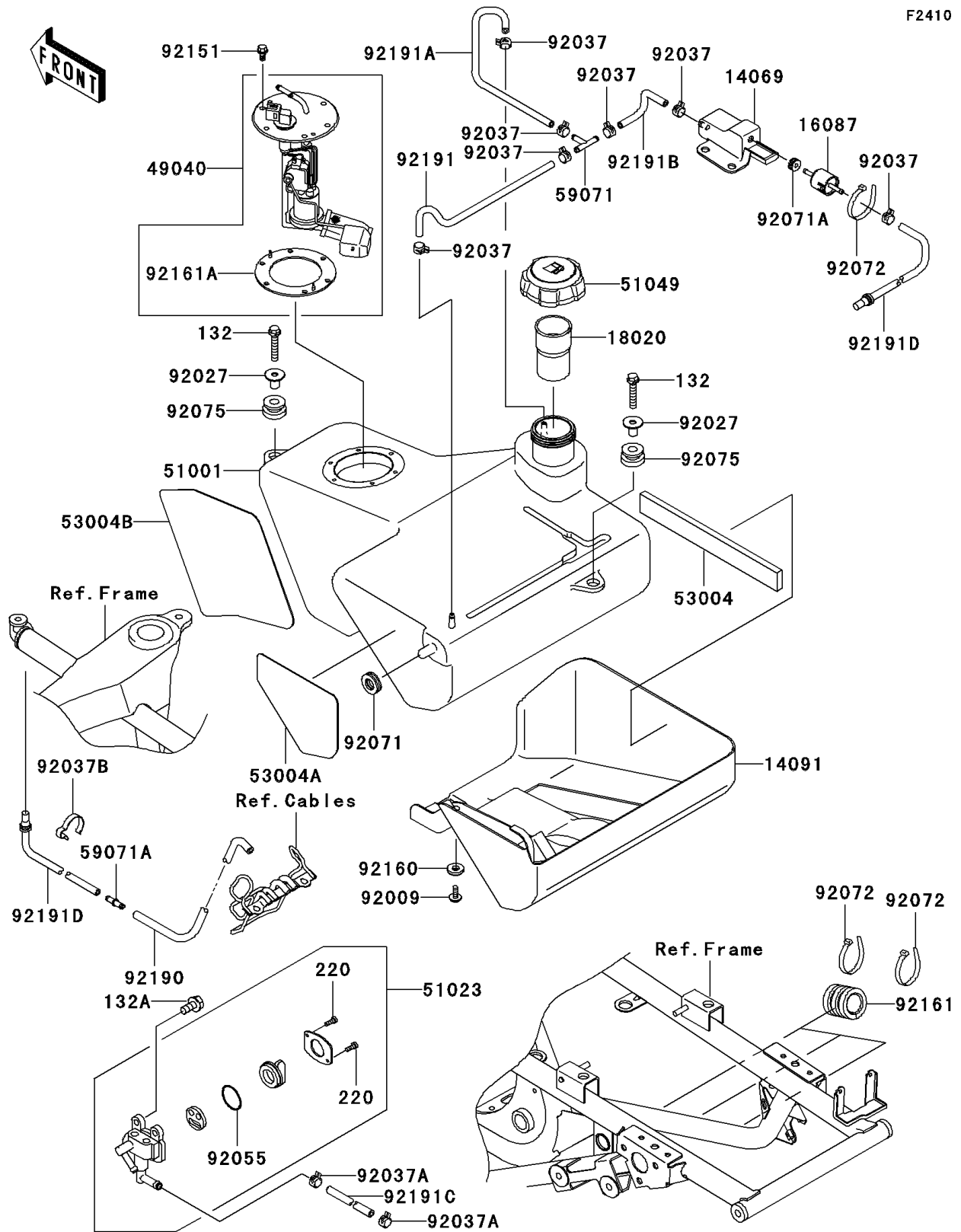

## 2005 Prairie® 700 4x4 Team Green™ Special Edition PARTS LIST

Fuel Tank

| ITEM NAME                               | PART NUMBER | QUANTITY |
|---|-------------|----------|
| BOLT-FLANGED-SMALL,6X30 (Ref # 132)     | 132G0630    | 1        |
| BOLT-FLANGED-SMALL,6X12 (Ref # 132A)    | 132J0612    | 1        |
| SCREW-PAN-CROS,3X8 (Ref # 220)          | 220B0308    | 1        |
| BREATHER,TANK (Ref # 14069)             | 14069-1069  | 1        |
| COVER,FUEL TANK (Ref # 14091)           | 14091-1404  | 1        |
| VALVE-CHECK (Ref # 16087)               | 16087-1054  | 1        |
| BAFFLE,FUEL TANK CAP (Ref # 18020)      | 18020-1278  | 1        |
| PUMP-FUEL (Ref # 49040)                 | 49040-0006  | 1        |
| TANK-COMP-FUEL (Ref # 51001)            | 51001-1638  | 1        |
| TAP-ASSY,FUEL (Ref # 51023)             | 51023-0002  | 1        |
| CAP-TANK,FUEL (Ref # 51049)             | 51049-1128  | 1        |
| MAT,FUEL TANK COVER (Ref # 53004)       | 53004-1161  | 1        |
| MAT,FUEL TANK (Ref # 53004A)            | 53004-1164  | 1        |
| MAT,FUEL TANK (Ref # 53004B)            | 53004-1165  | 1        |
| JOINT (Ref # 59071)                     | 59071-3705  | 1        |
| JOINT (Ref # 59071A)                    | 59071-3717  | 1        |
| SCREW,6X12 (Ref # 92009)                | 92009-1480  | 1        |
| COLLAR,L=16.1 (Ref # 92027)             | 92027-1847  | 1        |
| CLAMP,TUBE (Ref # 92037)                | 92037-1461  | 1        |
| CLAMP,TUBE (Ref # 92037A)               | 92037-1505  | 1        |
| CLAMP,HOSE (Ref # 92037B)               | 92037-1552  | 1        |
| RING-O (Ref # 92055)                    | 92055-0017  | 1        |
| GROMMET,AIR SUCTION VALVE (Ref # 92071) | 92071-1249  | 1        |
| GROMMET (Ref # 92071A)                  | 92071-1266  | 1        |
| BAND,L=188 (Ref # 92072)                | 92072-1239  | 1        |
| DAMPER (Ref # 92075)                    | 92075-1787  | 1        |
| BOLT,FLANGED,5X11.5 (Ref # 92151)       | 92151-1754  | 1        |
| DAMPER (Ref # 92160)                    | 92160-1017  | 1        |
| DAMPER,FUEL TANK,RR (Ref # 92161)       | 92161-1111  | 1        |

## 2005 Prairie® 700 4x4 Team Green™ Special Edition PARTS LIST

Fuel Tank

| ITEM NAME                         | PART NUMBER | QUANTITY |
|-----------------------------------|-------------|----------|
| DAMPER,FUEL PUMP (Ref # 92161A)   | 92161-1272  | 1        |
| TUBE,5X9X530 (Ref # 92190)        | 92190-1256  | 1        |
| TUBE,TANK-FRONT (Ref # 92191)     | 92191-1639  | 1        |
| TUBE,TANK-REAR (Ref # 92191A)     | 92191-1640  | 1        |
| TUBE,5X9X160 (Ref # 92191B)       | 92191-1641  | 1        |
| TUBE,5.3X10.5X425 (Ref # 92191C)  | 92191-1665  | 1        |
| TUBE,TANK BREATHER (Ref # 92191D) | 92191-1666  | 1        |