

2019 MULE SX™ 4x4 XC (CAMO)(FI) PARTS DIAGRAM

Valve(s)/Camshaft(s)

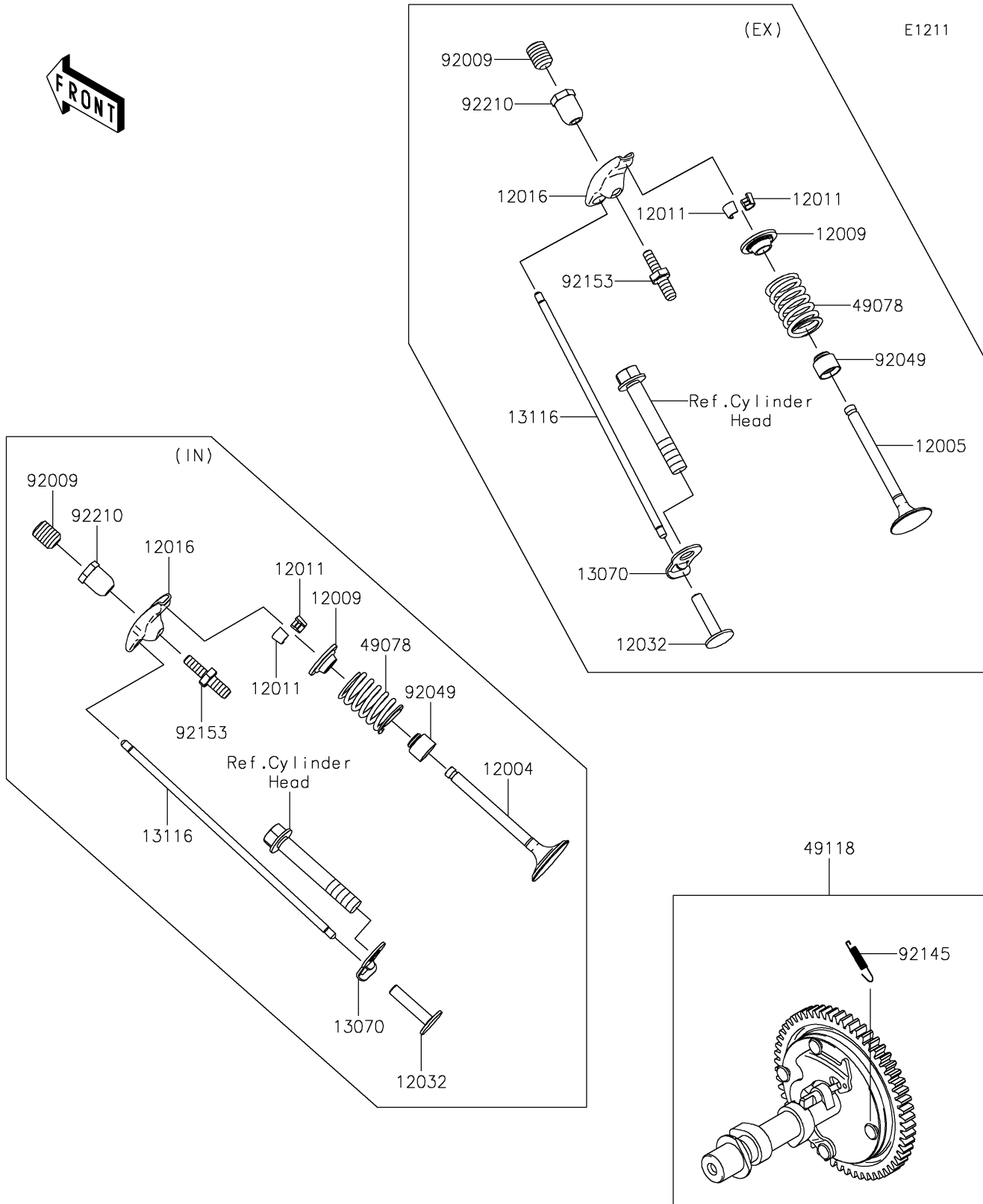

2019 MULE SX™ 4x4 XC (CAMO)(FI) PARTS LIST

Valve(s)/Camshaft(s)

| ITEM NAME | PART NUMBER | QUANTITY |
|-------------------------------------|-------------|----------|
| VALVE-INTAKE (Ref # 12004) | 12004-7004 | 1 |
| VALVE-EXHAUST (Ref # 12005) | 12005-7013 | 1 |
| RETAINER-VALVE SPRING (Ref # 12009) | 12009-7004 | 1 |
| COLLET (Ref # 12011) | 12011-2052 | 1 |
| ARM-ROCKER (Ref # 12016) | 12016-7007 | 1 |
| TAPPET (Ref # 12032) | 12032-7001 | 1 |
| GUIDE,ROD-PUSH (Ref # 13070) | 13070-7012 | 1 |
| ROD-PUSH (Ref # 13116) | 13116-7004 | 1 |
| SPRING-ENGINE VALVE (Ref # 49078) | 49078-7003 | 1 |
| CAMSHAFT-COMP (Ref # 49118) | 49118-0873 | 1 |
| SCREW (Ref # 92009) | 92009-2341 | 1 |
| SEAL-OIL,7X15X13 (Ref # 92049) | 92049-7020 | 1 |
| SPRING (Ref # 92145) | 92145-1653 | 1 |
| BOLT (Ref # 92153) | 92153-7019 | 1 |
| NUT,M6 (Ref # 92210) | 92210-7033 | 1 |