

2006 Brute Force® 650 4x4 Realtree Hardwoods Green® HD™ PARTS DIAGRAM

Muffler(s)

E1140

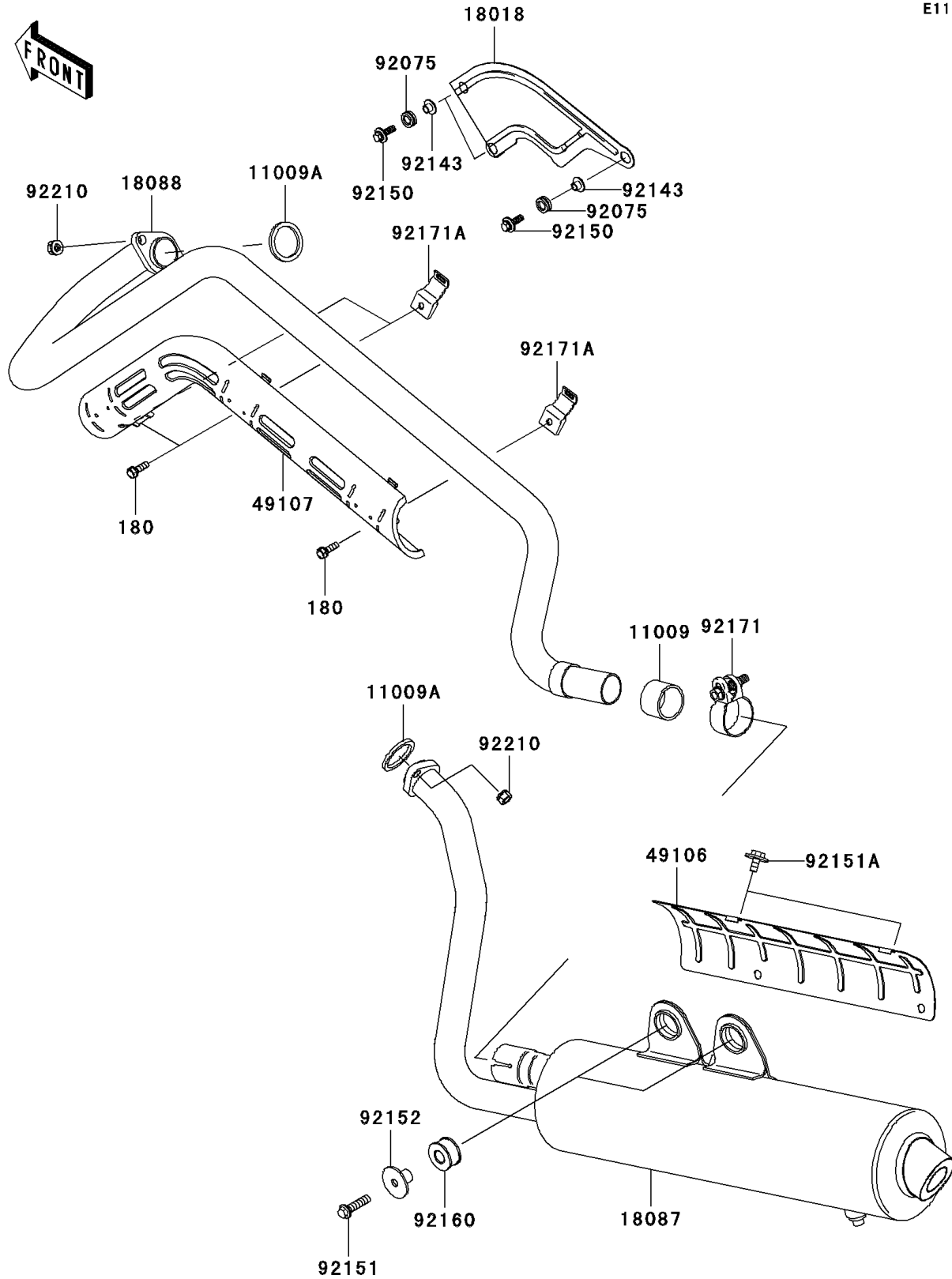

2006 Brute Force® 650 4x4 Realtree Hardwoods Green® HD™ PARTS LIST

Muffler(s)

| ITEM NAME | PART NUMBER | QUANTITY |
|---|-------------|----------|
| BOLT-UPSET-WS,6X20 (Ref # 180) | 180BD0620 | 1 |
| GASKET,MUFFLER CONNECTING (Ref # 11009) | 11009-1865 | 1 |
| GASKET,EXHAUST HOLDER (Ref # 11009A) | 11009-1894 | 1 |
| PLATE-HEAT GUARD (Ref # 18018) | 18018-1134 | 1 |
| MUFFLER (Ref # 18087) | 18087-0077 | 1 |
| PIPE-EXHAUST (Ref # 18088) | 18088-1140 | 1 |
| COVER-MUFFLER (Ref # 49106) | 49106-1291 | 1 |
| COVER-EXHAUST PIPE (Ref # 49107) | 49107-1210 | 1 |
| DAMPER (Ref # 92075) | 92075-1947 | 1 |
| COLLAR (Ref # 92143) | 92143-1057 | 1 |
| BOLT,FLANGED,6X20 (Ref # 92150) | 92150-1633 | 1 |
| BOLT,8X32 (Ref # 92151) | 92151-1446 | 1 |
| BOLT,UPSET-WP,6X12 (Ref # 92151A) | 92151-1944 | 1 |
| COLLAR,MUFFLER (Ref # 92152) | 92152-1152 | 1 |
| DAMPER,MUFFLER (Ref # 92160) | 92160-1990 | 1 |
| CLAMP (Ref # 92171) | 92171-1330 | 1 |
| CLAMP (Ref # 92171A) | 92171-1357 | 1 |
| NUT,8MM (Ref # 92210) | 92210-1242 | 1 |