

2005 Brute Force® 650 4x4 PARTS DIAGRAM

Cylinder Head

E1111

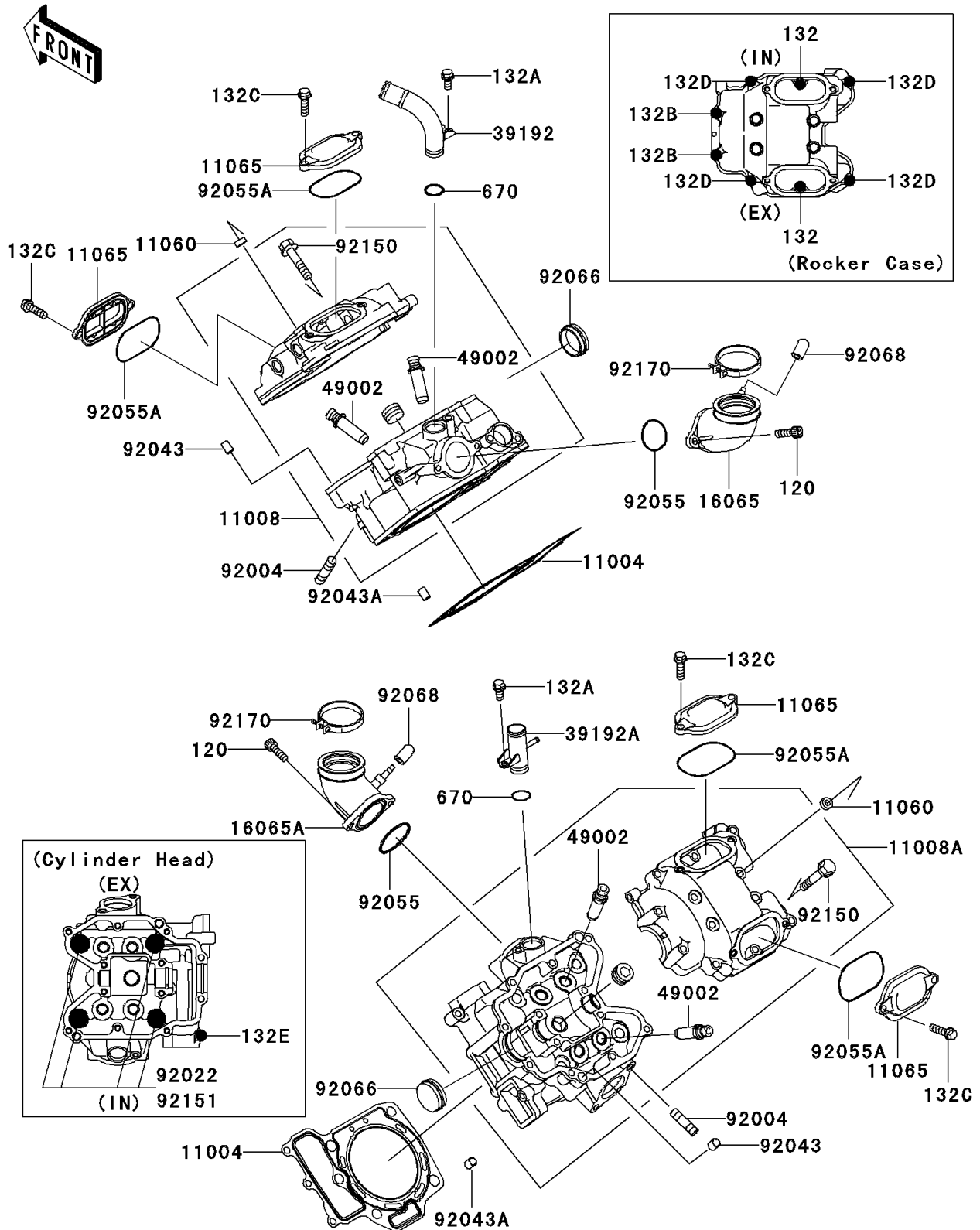

2005 Brute Force® 650 4x4 PARTS LIST

Cylinder Head

ITEM NAME	PART NUMBER	QUANTITY
BOLT-SOCKET,6X20 (Ref # 120)	120Z0620	1
BOLT-FLANGED-SMALL,6X25 (Ref # 132)	132H0625	1
BOLT-FLANGED-SMALL,6X12 (Ref # 132A)	132Y0612	1
BOLT-FLANGED-SMALL,6X130 (Ref # 132B)	132Y06130	1
BOLT-FLANGED-SMALL,6X20 (Ref # 132C)	132Y0620	1
BOLT-FLANGED-SMALL,6X30 (Ref # 132D)	132Y0630	1
BOLT-FLANGED-SMALL,6X95 (Ref # 132E)	132Y0695	1
O RING,16MM (Ref # 670)	670B2016	1
GASKET-HEAD (Ref # 11004)	11004-0030	1
HEAD-COMP-CYLINDER,FR (Ref # 11008)	11008-0030	1
HEAD-COMP-CYLINDER,RR (Ref # 11008A)	11008-0031	1
GASKET,6.2X12X0.3 (Ref # 11060)	11060-1994	1
CAP,ROCKER CASE (Ref # 11065)	11065-1152	1
HOLDER-CARBURETOR (Ref # 16065)	16065-1370	1
HOLDER-CARBURETOR,RR (Ref # 16065A)	16065-1371	1
PIPE-WATER (Ref # 39192)	39192-1132	1
PIPE-WATER (Ref # 39192A)	39192-1133	1
GUIDE-VALVE (Ref # 49002)	49002-1097	1
STUD,8X22 (Ref # 92004)	92004-1217	1
WASHER,11.5X20.5X1.6 (Ref # 92022)	92022-1720	1
PIN,6.2X8X14 (Ref # 92043)	92043-1263	1
PIN,10.1X12X14 (Ref # 92043A)	92043-4009	1
RING-O,38X1.9 (Ref # 92055)	92055-1295	1
RING-O,55.6X2.4 (Ref # 92055A)	92055-1644	1
PLUG (Ref # 92066)	92066-1289	1
PLUG,12X25 (Ref # 92068)	92068-006	1
BOLT,FLANGED,6X55 (Ref # 92150)	92150-1302	1
BOLT,FLANGED,10X150 (Ref # 92151)	92151-1917	1
CLAMP (Ref # 92170)	92170-1722	1