

## 2003 KFX®400 PARTS DIAGRAM

Clutch(A1/A2)

E1350

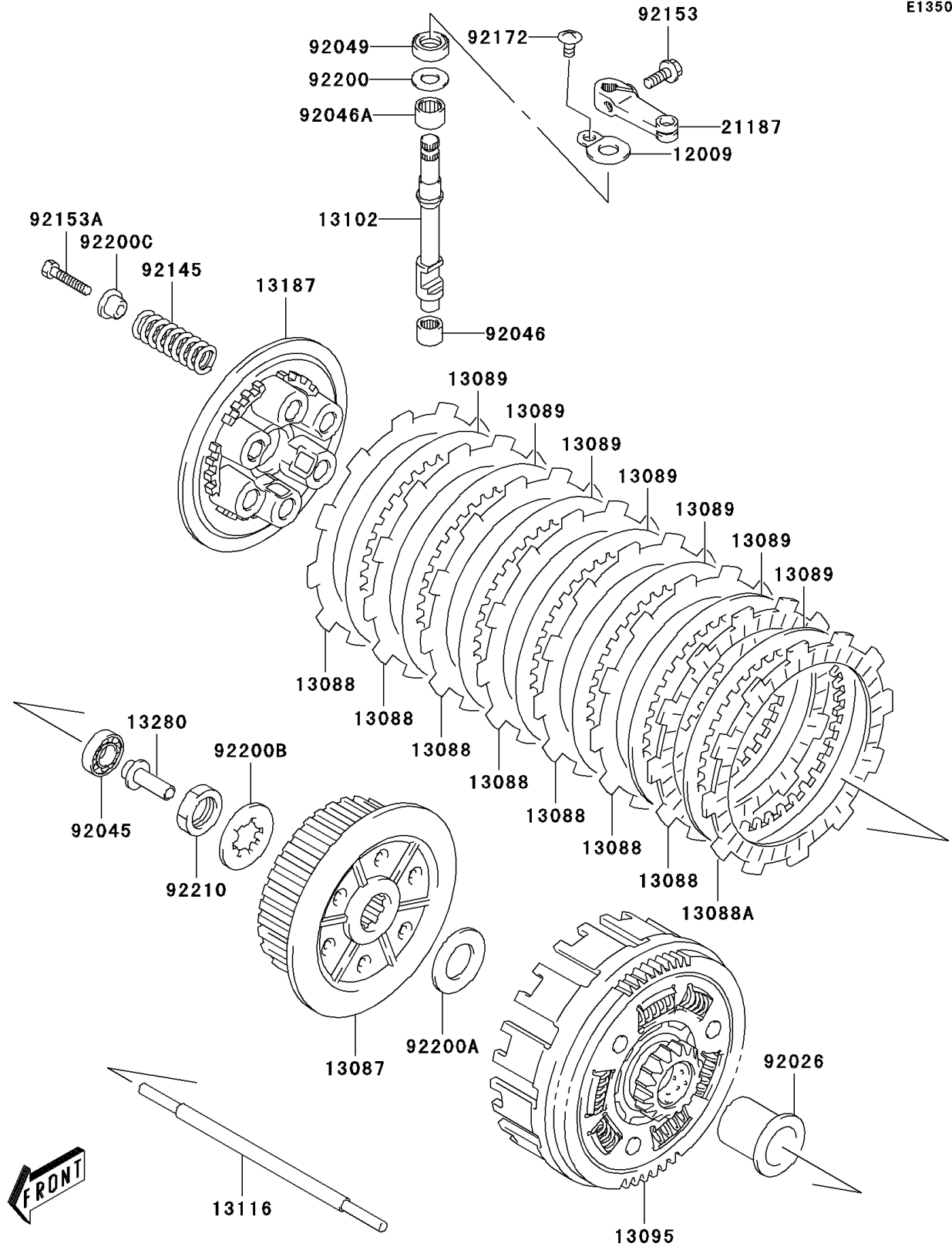

## 2003 KFX®400 PARTS LIST

Clutch(A1/A2)

ITEM NAME	PART NUMBER	QUANTITY
RETAINER-VALVE SPRING (Ref # 12009)	12009-S003	1
HUB-CLUTCH (Ref # 13087)	13087-S003	1
PLATE-FRICTION,NO.1 (Ref # 13088)	13088-S003	1
PLATE-FRICTION,NO.2 (Ref # 13088A)	13088-S004	1
PLATE-CLUTCH (Ref # 13089)	13089-S003	1
HOUSING-COMP-CLUTCH (Ref # 13095)	13095-S006	1
RELEASE-COMP-CLUTCH (Ref # 13102)	13102-S003	1
ROD-PUSH (Ref # 13116)	13116-S003	1
PLATE-CLUTCH OPERATING (Ref # 13187)	13187-S004	1
HOLDER,CLUTCH PUSH (Ref # 13280)	13280-S025	1
ARM-ASSY,CLUTCH RELEASE (Ref # 21187)	21187-S004	1
SPACER (Ref # 92026)	92026-S094	1
BEARING-BALL,12X28X8 (Ref # 92045)	92045-S004	1
BEARING-NEEDLE,CAM SHAFT,LOW (Ref # 92046)	92046-S014	1
BEARING-NEEDLE,CAM SHAFT,UPP (Ref # 92046A)	92046-S015	1
SEAL-OIL,10X20X6 (Ref # 92049)	92049-S018	1
SPRING,CLUTCH (Ref # 92145)	92145-S100	1
BOLT (Ref # 92153)	92153-S001	1
BOLT (Ref # 92153A)	92153-S082	1
SCREW (Ref # 92172)	92172-S092	1
WASHER,10X20X1.0 (Ref # 92200)	92200-S061	1
WASHER,CLUTCH (Ref # 92200A)	92200-S131	1
WASHER,CLUTCH (Ref # 92200B)	92200-S144	1
WASHER,CLUTCH SPRING (Ref # 92200C)	92200-S153	1
NUT,CLUTCH (Ref # 92210)	92210-S103	1