

1986 KDX™200 PARTS DIAGRAM

Carburetor

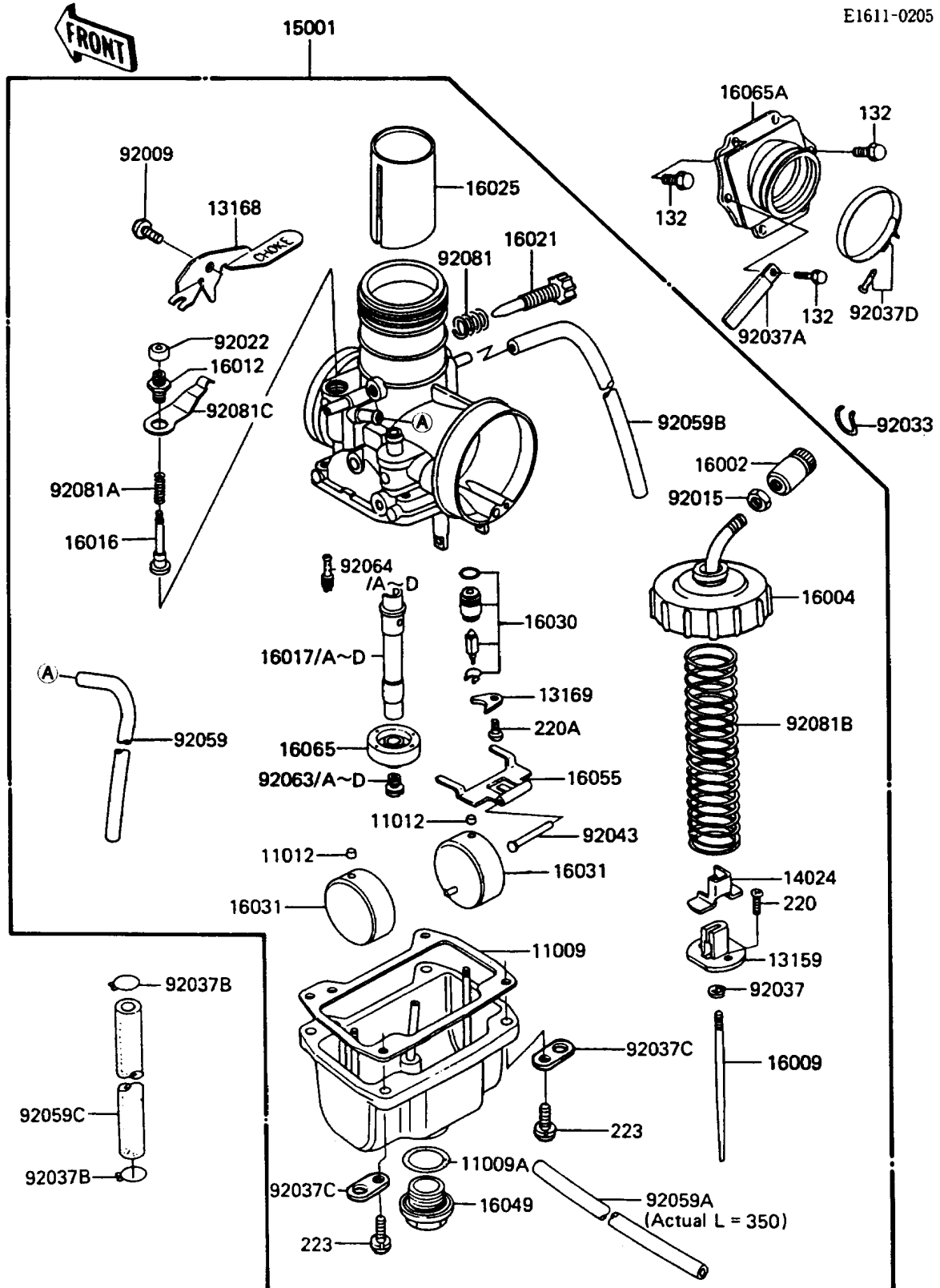

1986 KDX™200 PARTS LIST

Carburetor

ITEM NAME	PART NUMBER	QUANTITY
GASKET,FLOAT CHAMBER (Ref # 11009)	11009-1275	1
GASKET,MAIN JET COVER (Ref # 11009A)	16038-009	1
CAP,FLOAT (Ref # 11012)	11012-1047	1
CONNECTOR (Ref # 13159)	13159-1004	1
LEVER,STARTER (Ref # 13168)	13168-1233	1
PLATE,LOCK (Ref # 13169)	13169-1190	1
COVER,THROTTLE VALVE (Ref # 14024)	14025-1113	1
CARBURETOR-ASSY (Ref # 15001)	15001-1202	1
ADJUSTER-CABLE (Ref # 16002)	16002-1006	1
CAP-CHAMBER,MIXING (Ref # 16004)	16004-1013	1
NEEDLE-JET,6FL52 (Ref # 16009)	16009-1226	1
CAP-STARTER PLUNGER (Ref # 16012)	16012-019	1
PLUNGER (Ref # 16016)	16016-011	1
JET-NEEDLE,R-2 (Ref # 16017)	16017-1307	1
JET-NEEDLE,Q-8 (Ref # 16017A)	16017-1308	1
JET-NEEDLE,R-0 (Ref # 16017B)	16017-1309	1
JET-NEEDLE,R-4 (Ref # 16017C)	16017-1310	1
JET-NEEDLE,R-6 (Ref # 16017D)	16017-1311	1
SCREW-THROTTLE STOP (Ref # 16021)	16021-1029	1
VALVE-THROTTLE,CA.3.0 (Ref # 16025)	16025-1114	1
VALVE-FLOAT,3.3 (Ref # 16030)	16030-1020	1
FLOAT (Ref # 16031)	16031-029	1
COVER-MAIN JET (Ref # 16049)	16049-006	1
ARM-FLOAT (Ref # 16055)	16055-009	1
HOLDER-CARBURETOR,NEEDLE JET (Ref # 16065)	16065-1045	1
HOLDER-CARBURETOR (Ref # 16065A)	16065-1138	1
SCREW (Ref # 92009)	92009-1412	1
NUT,CABLE ADJUST LOCK (Ref # 92015)	16003-004	1
CAP,RUBBER,STARTER PLUNGER (Ref # 92022)	16039-015	1

1986 KDX™200 PARTS LIST

Carburetor

ITEM NAME	PART NUMBER	QUANTITY
RING-SNAP (Ref # 92033)	92036-018	1
CLAMP,E-TYPE (Ref # 92037)	16008-010	1
CLAMP,WIRING HARNESS (Ref # 92037A)	92037-1069	1
CLAMP,TUBE (Ref # 92037B)	92037-147	1
CLAMP (Ref # 92037C)	92037-1474	1
CLAMP,CARBURETOR HOLDER (Ref # 92037D)	92037-1484	1
PIN,FLOAT (Ref # 92043)	16032-008	1
TUBE,3.5X6.5X410 (Ref # 92059)	92059-1142	1
TUBE,3.5X6.5X350 (Ref # 92059A)	92059-1211	1
TUBE,4X7X400 (Ref # 92059B)	92059-1292	1
TUBE,5.8X10.8X230 (Ref # 92059C)	92059-1431	1
JET-MAIN,#300 (Ref # 92063)	92063-045	1
JET-MAIN,#310 (Ref # 92063A)	92063-046	1
JET-MAIN,#320 (Ref # 92063B)	92063-047	1
JET-MAIN,#330 (Ref # 92063C)	92063-048	1
JET-MAIN,#340 (Ref # 92063D)	92063-049	1
JET-PILOT,#20 (Ref # 92064)	92064-021	1
JET-PILOT,#30 (Ref # 92064A)	92064-022	1
JET-PILOT,#25 (Ref # 92064B)	92064-032	1
JET-PILOT,#22.5 (Ref # 92064C)	92064-040	1
JET-PILOT,#27.5 (Ref # 92064D)	92064-1033	1
SPRING,THROTTLE STOP SCREW (Ref # 92081)	16022-005	1
SPRING,STARTER PLUNGER (Ref # 92081A)	92081-1181	1
SPRING,THROTTLE VALVE (Ref # 92081B)	92081-1432	1
SPRING,PLATE (Ref # 92081C)	92081-1625	1
BOLT-FLANGED-SMALL (Ref # 132)	132G0620	1
SCREW-PAN-CROS (Ref # 220)	220B0308	1
SCREW-PAN-CROS,4X6 (Ref # 220A)	220B0406	1
SCREW-PAN-WS-CROS (Ref # 223)	223B0518	1