

2003 Prairie® 360 4x4 Advantage Classic PARTS DIAGRAM

Valve(s)

E1210

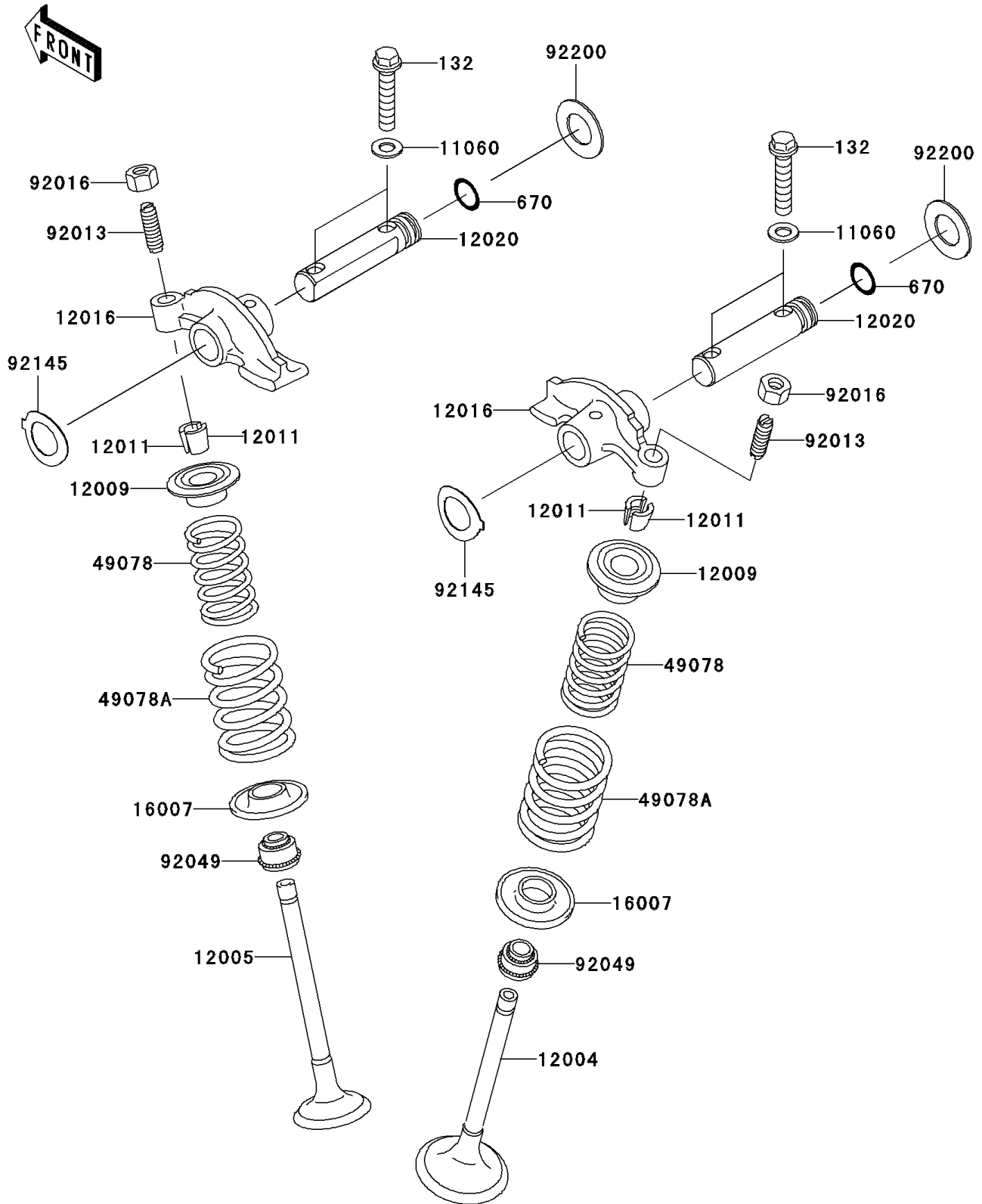

2003 Prairie® 360 4x4 Advantage Classic PARTS LIST

Valve(s)

ITEM NAME	PART NUMBER	QUANTITY
BOLT-FLANGED-SMALL (Ref # 132)	132Y0630	1
O RING,10MM (Ref # 670)	670D1510	1
GASKET,6.2X12X0.3 (Ref # 11060)	11060-1994	1
VALVE-INTAKE (Ref # 12004)	12004-1155	1
VALVE-EXHAUST (Ref # 12005)	12005-1326	1
RETAINER-VALVE SPRING (Ref # 12009)	12009-005	1
COLLET,RETAINER (Ref # 12011)	12011-004	1
ARM-ROCKER (Ref # 12016)	12016-1138	1
SHAFT-ROCKER (Ref # 12020)	12020-1085	1
SEAT-SPRING,VALVE (Ref # 16007)	16007-1024	1
SPRING-ENGINE VALVE,INNER (Ref # 49078)	49078-1209	1
SPRING-ENGINE VALVE,OUTER (Ref # 49078A)	49078-1210	1
SCREW,6MM (Ref # 92013)	92013-009	1
NUT,6MM (Ref # 92016)	92016-061	1
SEAL-OIL,RV37129.5 (Ref # 92049)	92049-016	1
SPRING,ROCKER SHAFT (Ref # 92145)	92145-1532	1
WASHER,13.4X25X1.0 (Ref # 92200)	92200-0045	1