

1982 KZ1300 Standard PARTS DIAGRAM

CARBURETOR PARTS

E1612-0037

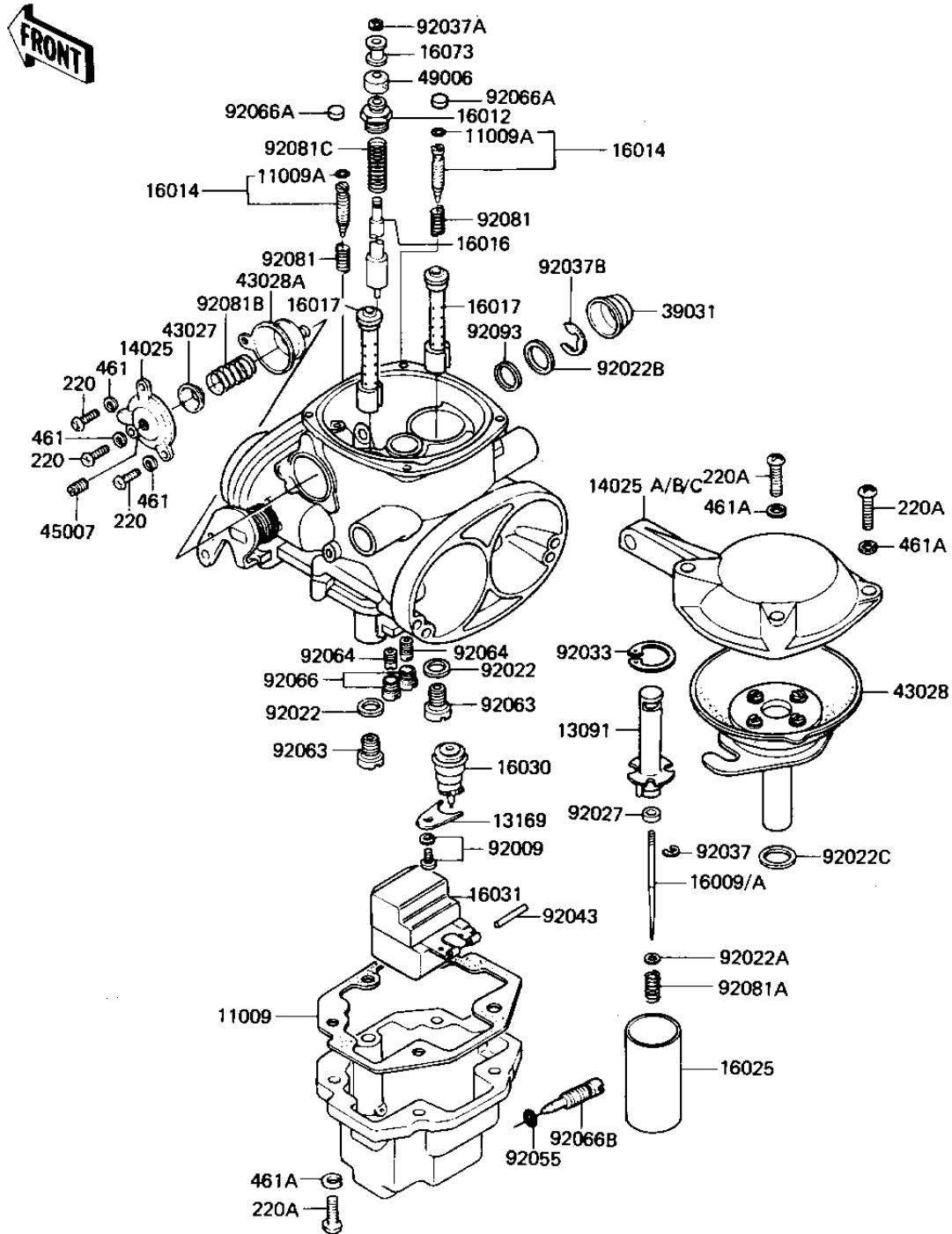

1982 KZ1300 Standard PARTS LIST

CARBURETOR PARTS

| ITEM NAME | PART NUMBER | QUANTITY |
|---------------------------------------|-------------|----------|
| GASKET,FLOAT CHAMBER (Ref # 11009) | 11009-1148 | 1 |
| "O" RING (Ref # 11009A) | 16038-022 | 1 |
| HOLDER,PISTON VALVE (Ref # 13091) | 13091-1056 | 1 |
| PLATE, LOCK (Ref # 13169) | 13169-1190 | 1 |
| COVER,COASTING RICHER (Ref # 14025) | 14025-1158 | 1 |
| TOP,MXNG CHAMBER,L.H. (Ref # 14025A) | 14025-1159 | 1 |
| TOP,MXNG CHAMBER,CENT (Ref # 14025B) | 14025-1160 | 1 |
| TOP,MXNG CHAMBER,R.H. (Ref # 14025C) | 14025-1161 | 1 |
| JET NEEDLE,5P3 (Canada) (Ref # 16009) | 16009-1038 | 1 |
| JET NEEDLE,5P4 (Ref # 16009A) | 16009-1050 | 1 |
| CAP,STARTER PLUNGER (Ref # 16012) | 16012-1005 | 1 |
| SCREW,PILOT ADJUSTING (Ref # 16014) | 16014-1016 | 1 |
| PLUNGER,STARTER (Ref # 16016) | 16016-1005 | 1 |
| NEEDLE JET,Y-8 (Ref # 16017) | 16017-1038 | 1 |
| VALVE,PISTON (Ref # 16025) | 16025-1029 | 1 |
| FLOAT VALVE ASSY (Ref # 16030) | 16030-1005 | 1 |
| FLOAT (Ref # 16031) | 16031-1006 | 1 |
| COLLAR (Ref # 16073) | 16073-014 | 1 |
| CAP,STEEL (Ref # 39031) | 39031-1002 | 1 |
| RETAINER,DPHRGM SPRNG (Ref # 43027) | 43027-1004 | 1 |
| DIAPHRAGM ASSY,VACUUM (Ref # 43028) | 43028-1014 | 1 |
| DIAPHRAGM,RICHER (Ref # 43028A) | 43028-1017 | 1 |
| SCREW,SLOTTED (Ref # 45007) | 45007-1001 | 1 |
| RUBBER CAP,STARTER PL (Ref # 49006) | 16036-017 | 1 |
| SCREW-CLAMP (Ref # 92009) | 16033-014 | 1 |
| WASHER MAIN JET (Ref # 92022) | 16034-001 | 1 |
| WASHER,JET NEEDLE (Ref # 92022A) | 92022-1123 | 1 |
| WASHER,PLAIN (Ref # 92022B) | 92022-1150 | 1 |
| WASHER,PLAIN,DURACON (Ref # 92022C) | 92022-1155 | 1 |

1982 KZ1300 Standard PARTS LIST

CARBURETOR PARTS

| ITEM NAME | PART NUMBER | QUANTITY |
|---|-------------|----------|
| UNAVAILABLE IN PRICE BOOK (Ref # 92027) | 92027-11 | 1 |
| CIRCLIP (Ref # 92033) | 92033-1009 | 1 |
| CIRCLIP (Ref # 92037) | 16008-014 | 1 |
| CIRCLIP (Ref # 92037A) | 16076-003 | 1 |
| CIRCLIP (Ref # 92037B) | 92037-1140 | 1 |
| FLOAT PIN (Ref # 92043) | 16032-003 | 1 |
| "O" RING (Ref # 92055) | 92055-044 | 1 |
| MAIN JET,#110R (Ref # 92063) | 92063-1038 | 1 |
| PILOT JET,#42.5 (Ref # 92064) | 92064-1024 | 1 |
| SCREW,HOLE PLUG (Ref # 92066) | 92066-1044 | 1 |
| PLUG,PILOT SCREW (Ref # 92066A) | 92066-1051 | 1 |
| SCREW,DRAIN (Ref # 92066B) | 92066-1064 | 1 |
| SPRING,PILOT SCREW (Ref # 92081) | 16022-016 | 1 |
| SPRING,JET NEEDLE (Ref # 92081A) | 92081-1126 | 1 |
| SPRING,RICHER DPHRGM (Ref # 92081B) | 92081-1156 | 1 |
| SPRING,STARTER PLUNGR (Ref # 92081C) | 92081-1163 | 1 |
| OIL SEAL (Ref # 92093) | 92093-1027 | 1 |
| SCREW PAN HEAD 4X10 (Ref # 220) | 220B0410 | 1 |
| UNAVAILABLE IN PRICE BOOK (Ref # 220A) | 214B0516A | 1 |
| WASHER SPRING 4MM (Ref # 461) | 461F0400 | 1 |
| WASHER SPRING 5MM (Ref # 461A) | 461F0500 | 1 |