

1968 PARTS DIAGRAM

CARBURETOR

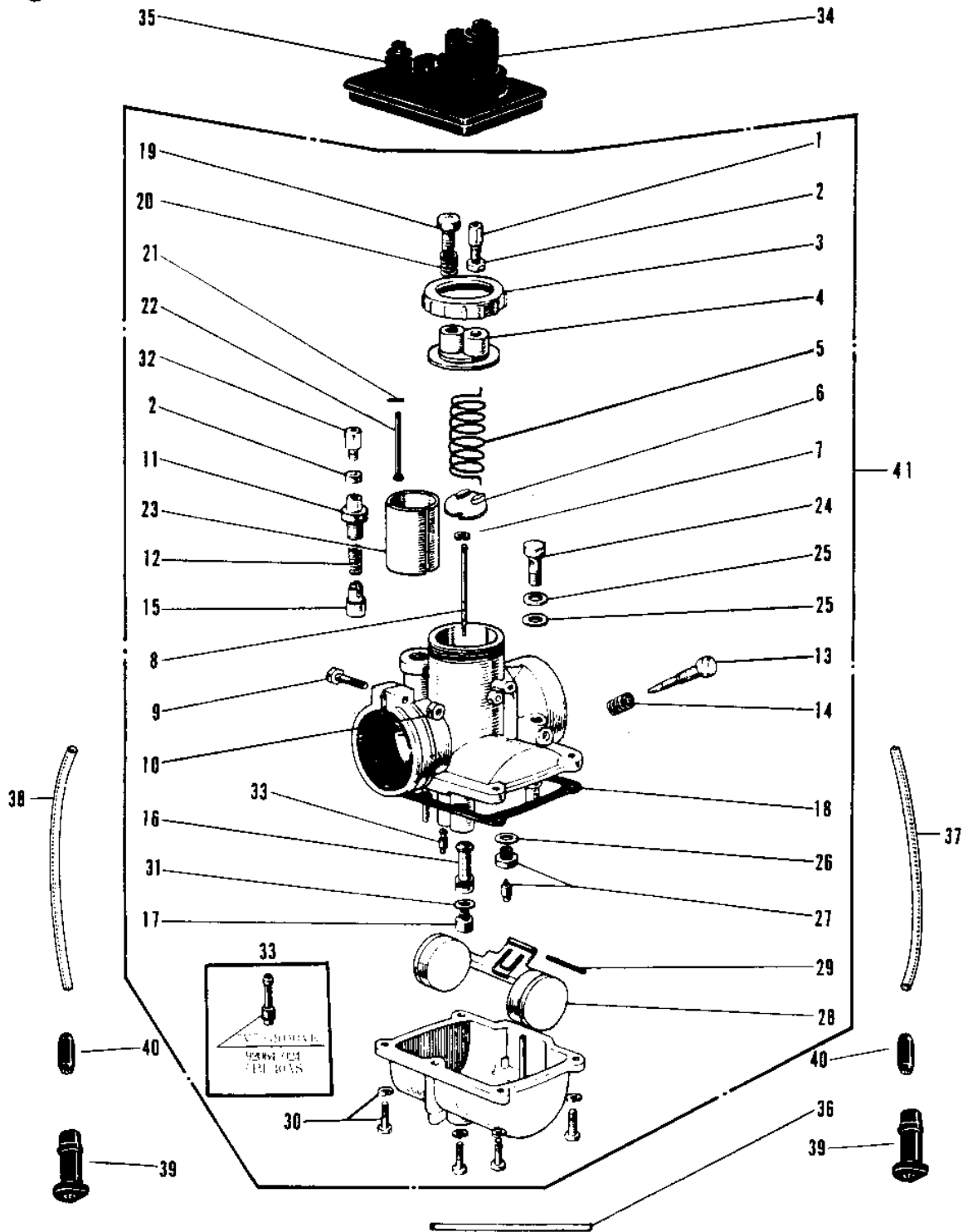
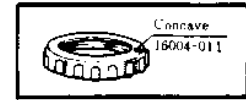

1968 PARTS LIST

CARBURETOR

ITEM NAME	PART NUMBER	QUANTITY
CABLE ADJUSTER (Ref # 1)	16002-002	1
NUT CABLE ADJUST LOCK (Ref # 2)	16003-004	1
CAP MIXING CHAMBER (Ref # 3)	16004-008	1
CAP MIXING CHAMBER (Ref # 3)	16004-011	1
TOP MIXING CHAMBER (Ref # 4)	16005-013	1
SPRING THROTTLE VALVE (Ref # 5)	16006-010	1
SPRING SEAT THRTL VLV (Ref # 6)	16007-011	1
CIRCLIP (Ref # 7)	16008-010	1
JET NEEDLE 4J13 (Ref # 8)	16009-012	1
SCREW CLAMP (Ref # 9)	16010-004	1
NUT 6MM (Ref # 10)	311B0600	2
CAP STARTER PLUNGER (Ref # 11)	16012-006	1
SPRING STARTER PLUNG (Ref # 12)	16013-005	1
SCREW PILOT AIR ADJUST (Ref # 13)	16014-003	1
SPRING, THROTTLE ADJUST (Ref # 14)	16022-010	1
PLUNGER-ENRICHNER (Ref # 15)	16016-002	1
NEEDLE JET N-6 (Ref # 16)	16017-019	1
JET-MAIN NO 190A (Ref # 17)	92063-021	1
JET-MAIN NO 170A (Ref # 17)	92063-019	1
JET-MAIN NO 180A (Ref # 17)	92063-020	1
JET-MAIN NO 200A (Ref # 17)	92063-022	1
JET-MAIN NO 210A (Ref # 17)	92063-023	1
GASKET FLOAT CHAMBER (Ref # 18)	16019-010	1
SCREW, THROTTLE STOP (Ref # 19)	16021-002	1
SPRING THR STOP SCREW (Ref # 20)	16022-005	1
UNAVAILABLE IN PRICE BOOK (Ref # 21)	16023-001	1
ROD THROTTLE VLV STOP (Ref # 22)	16024-004	1
VALVE THROTTLE CA2.0 (Ref # 23)	16025-015	1
BOLT BANJO (Ref # 24)	92001-014	1

1968 PARTS LIST

CARBURETOR

ITEM NAME	PART NUMBER	QUANTITY
GASKET 8MM (Ref # 25)	751P0800	1
WASHER FLOAT VLV SEAT (Ref # 26)	16029-004	1
FLOAT VALVE ASSY (Ref # 27)	16030-005	1
FLOAT (Ref # 28)	16031-010	1
FLOAT PIN (Ref # 29)	16032-003	1
SCREW FLOAT CHAMBER (Ref # 30)	16033-008	1
SCREW FLOAT CHAMBER (Ref # 30)	16033-009	1
WASHER MAIN JET (Ref # 31)	16034-001	1
CABLE ADJUSTER (Ref # 32)	16002-005	1
PILOT JET #40 (Ref # 33)	92064-005	1
JET-PILOT NO 40 (Ref # 33)	92064-024	1
GROMMET CARBURETOR CAP (Ref # 34)	14038-011	1
CAP CARBURETOR (Ref # 35)	14038-014	1
PIPE FUEL OVERFLOW (Ref # 36)	92059-023	1
PIPE FUEL OVERFLOW (Ref # 36)	92059-031	1
PIPE AIR VENT A (Ref # 37)	92059-038	2
GUIDE FUEL OVERFLOW (Ref # 39)	16136-002	1
PIPE (Ref # 40)	92098-001	1
CARBURETOR ASSY (Ref # 41)	16001-054	1