

1981 KX™80 PARTS DIAGRAM

FRONT FORK (F/NO.007514-)

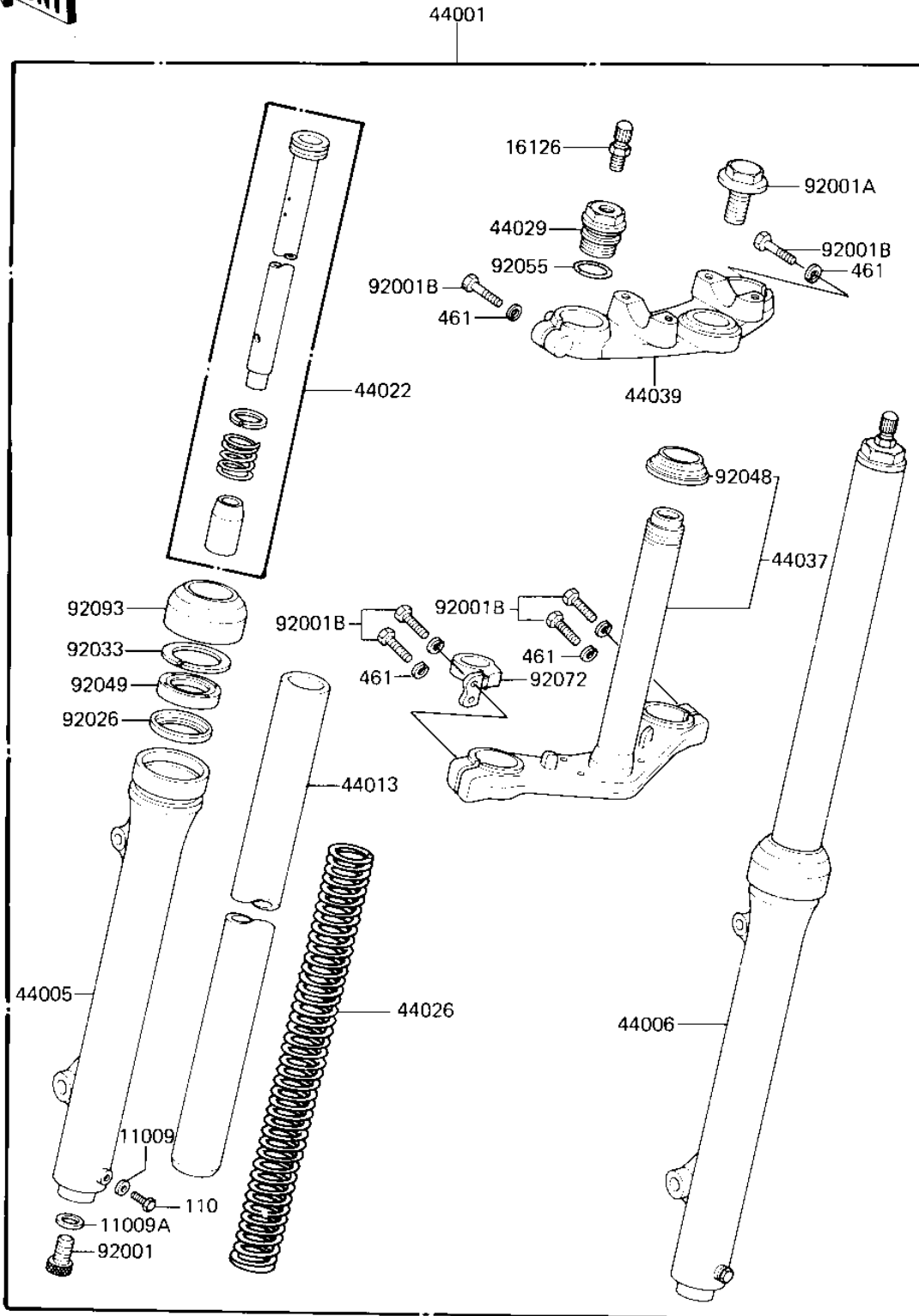

F2340-0144



1981 KX™80 PARTS LIST

FRONT FORK (F/NO.007514-)

| ITEM NAME | PART NUMBER | QUANTITY |
|-------------------------------------|-------------|----------|
| GASKET,DRAIN PLUG (Ref # 11009) | 44045-047 | 1 |
| GASKET,FORK CYL BOLT (Ref # 11009A) | 44045-051 | 1 |
| VALVE,AIR (Ref # 16126) | 16126-1041 | 1 |
| FORK-FRONT (Ref # 44001) | 44001-1360 | 1 |
| TUBE,LH,FORK OUTER (Ref # 44005) | 44005-1092 | 1 |
| TUBE,RH,FORK OUTER (Ref # 44006) | 44006-1086 | 1 |
| PIPE-FORK INNER (Ref # 44013) | 44013-1083 | 1 |
| CYLINDER-FORK (Ref # 44022) | 44022-1081 | 1 |
| SPRING FRONT FORK (Ref # 44026) | 44026-1149 | 1 |
| SEAT-FORK SPRING (Ref # 44029) | 44029-1032 | 1 |
| HOLDER-FORK UNDER (Ref # 44037) | 44037-1079 | 1 |
| HOLDER-FORK UPPER (Ref # 44039) | 44039-1049 | 1 |
| BOLT,FORK CYLINDER (Ref # 92001) | 44041-078 | 1 |
| BOLT,STEERING STEM (Ref # 92001A) | 92001-1318 | 1 |
| BOLT,8X35 (Ref # 92001B) | 92001-1643 | 1 |
| SPACER,FORK OUTER (Ref # 92026) | 92026-1099 | 1 |
| RING-SNAP (Ref # 92033) | 92033-1078 | 1 |
| CONE STERNNG BERG LOW (Ref # 92048) | 92047-010 | 1 |
| SEAL-OIL,FORK OUTER (Ref # 92049) | 92049-1080 | 1 |
| RING-0 (Ref # 92055) | 92055-1124 | 1 |
| BAND (Ref # 92072) | 92072-1082 | 1 |
| SEAL,FORK OUTER (Ref # 92093) | 92093-1066 | 1 |
| BOLT HEX HEAD 6X8 (Ref # 110) | 110B0608 | 1 |
| WASHER SPRING 8MM (Ref # 461) | 461F0800 | 1 |