

## 1980 Z1R PARTS DIAGRAM

FAIRING ('80 D3)

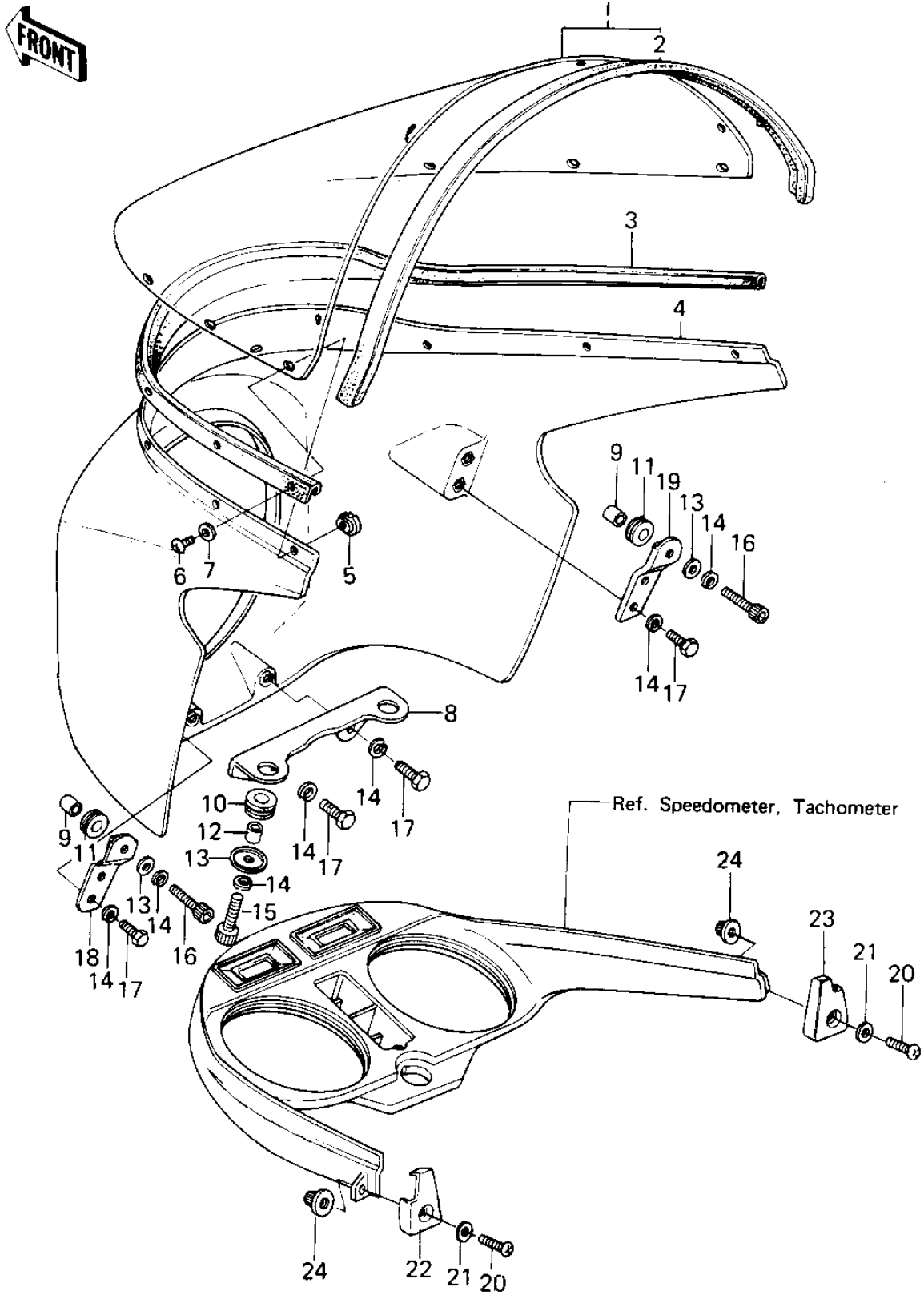

## 1980 Z1R PARTS LIST

FAIRING ('80 D3)

| ITEM NAME                      | PART NUMBER   | QUANTITY |
|--------------------------------|---------------|----------|
| WINDSHIELD (Ref # 1)           | 39155-1001    | 1        |
| TRIM (Ref # 2)                 | 53044-1003    | 1        |
| TRIM (Ref # 3)                 | 53044-1002    | 1        |
| COWLING,EBONY (Ref # 4)        | 55028-1001-8G | 1        |
| NUT,5M/M (Ref # 5)             | 92015-1025    | 2        |
| SCREW-PAN-CROS,5X12, (Ref # 6) | 220C0512      | 1        |
| WASHER,PLAIN (Ref # 7)         | 92022-1038    | 1        |
| BRACKET,LOWER (Ref # 8)        | 11034-1124    | 1        |
| COLLAR (Ref # 9)               | 92027-241     | 1        |
| GROMMET (Ref # 10)             | 92071-1011    | 1        |
| GROMMET (Ref # 11)             | 92071-1010    | 1        |
| COLLAR 6.8X10X10.5 (Ref # 12)  | 92027-120     | 1        |
| WASHER,PLAIN,6MM (Ref # 13)    | 92022-286     | 1        |
| WASHER SPRING 6MM (Ref # 14)   | 461F0600      | 1        |
| BOLT,6X20 (Ref # 15)           | 120P0620      | 1        |
| BOLT,6X25 (Ref # 16)           | 120P0625      | 1        |
| BOLT-UPSET 6X14 (Ref # 17)     | 112B0614      | 1        |
| BRACKET,L.H.UPPER (Ref # 18)   | 11034-1122    | 1        |
| BRACKET,R.H.UPPER (Ref # 19)   | 11034-1123    | 1        |
| SCREW PAN HEAD 5X12 (Ref # 20) | 220B0512      | 1        |
| WASHER PLAIN 5MM (Ref # 21)    | 410B0500      | 1        |
| CAP,L.H. (Ref # 22)            | 11012-1025    | 1        |
| CAP,R.H. (Ref # 23)            | 11012-1026    | 1        |