

1980 Z1R PARTS DIAGRAM

SWING ARM/SHOCK ABSORBERS ('80 D3)

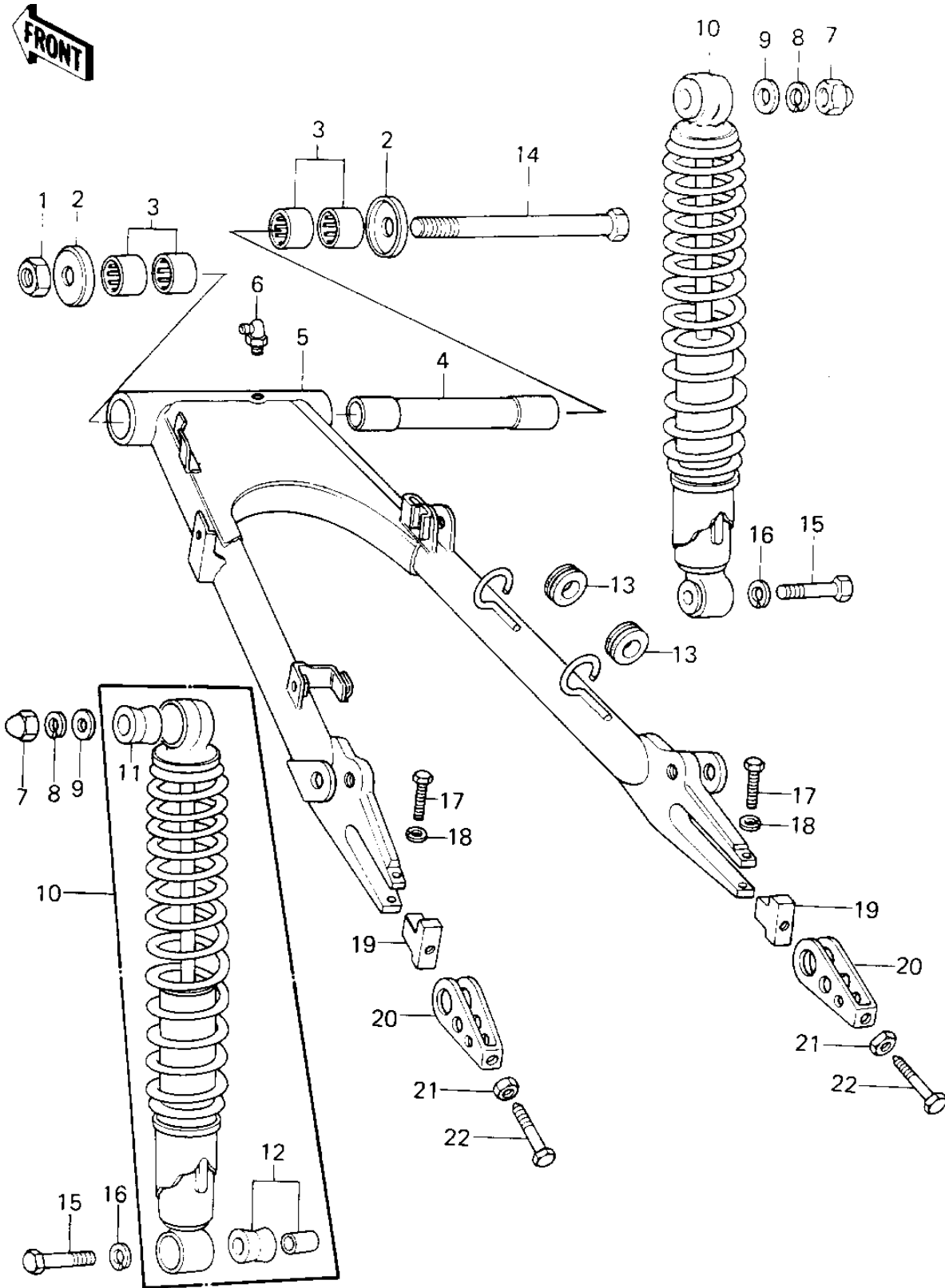

1980 Z1R PARTS LIST

SWING ARM/SHOCK ABSORBERS ('80 D3)

ITEM NAME	PART NUMBER	QUANTITY
NUT-SELF LOCKING (Ref # 1)	92019-012	1
CAP,SWING ARM (Ref # 2)	33035-009	1
BEARING-NEEDLE,HK221 (Ref # 3)	92046-1115	1
SLEEVE,SWING ARM (Ref # 4)	42036-1011	1
ARM-COMP-SWING (Ref # 5)	33001-1079	1
GREASE NIPPLE (Ref # 6)	92005-002	1
NUT 12MM (Ref # 7)	92020-014	1
WASHER SPRING 12MM (Ref # 8)	461F1200	1
WASHER PLAIN 12MM (Ref # 9)	410B1200	1
SHOCK ABSBR RR (Ref # 10)	45014-1043	1
BUSHING,SHOCK ABSORB (Ref # 11)	45017-020	1
BUSHING,SHOCK ABSORB (Ref # 12)	45017-019	1
DAMPER RUBBER (Ref # 13)	43064-007	1
SHAFT,SWING ARM PIVO (Ref # 14)	33032-036	1
BOLT HEX HEAD 10X35 (Ref # 15)	113N1035	1
WASHER SPRING 10MM (Ref # 16)	461F1000	1
BOLT (Ref # 17)	110G0840	1
WASHER SPRING 8MM (Ref # 18)	461F0800	1
STOPPER,CHAIN ADJUST (Ref # 19)	33044-001	1
ADJUSTER,CHAIN (Ref # 20)	33040-066	1
NUT 10MM (Ref # 21)	315B1000	1
BOLT-CHN ADJUST 10MM (Ref # 22)	92001-143	1