

1981 KZ250 PARTS DIAGRAM

CARBURETOR ('81 D2)

E1610-0002

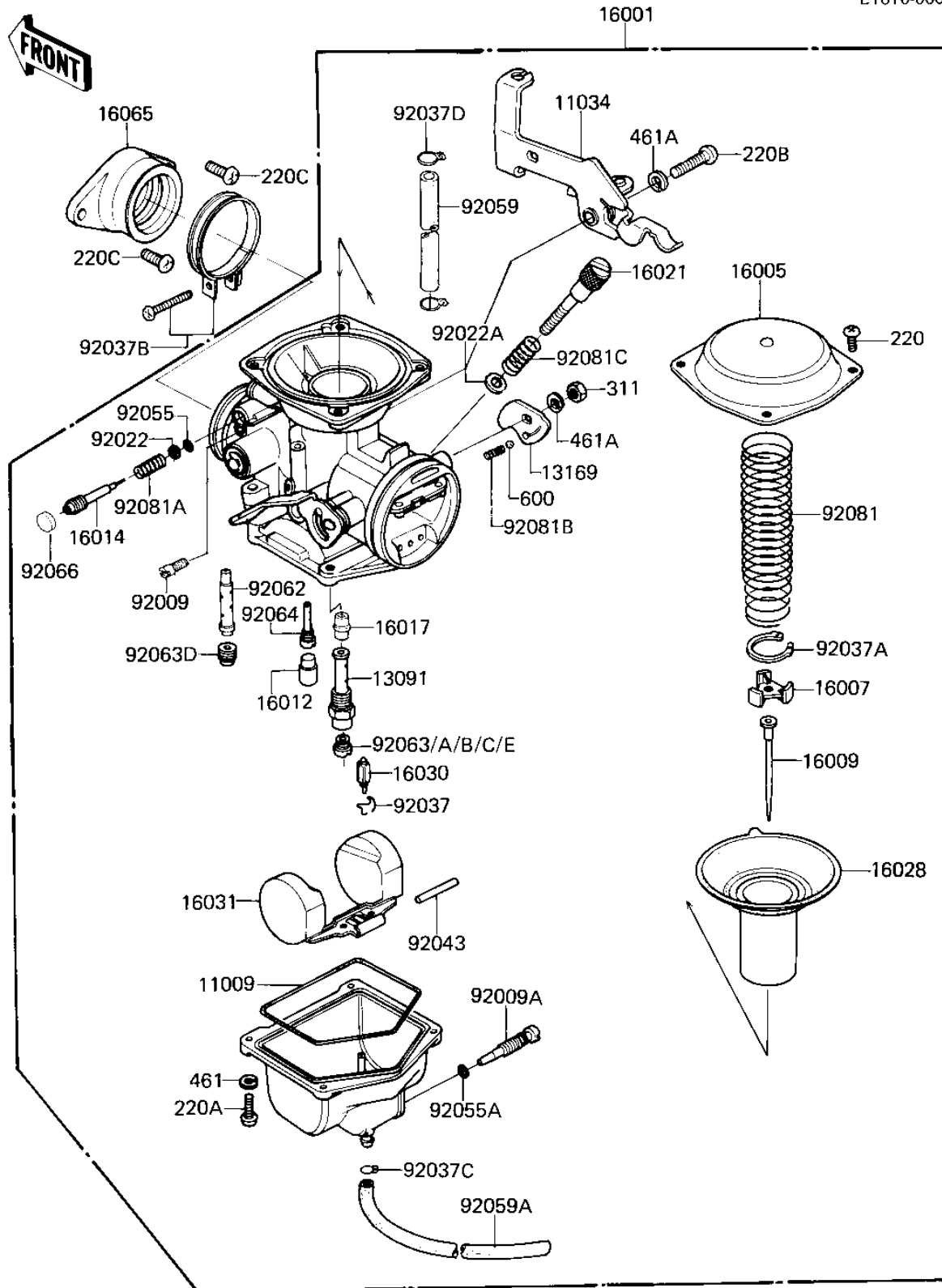

1981 KZ250 PARTS LIST

CARBURETOR ('81 D2)

ITEM NAME	PART NUMBER	QUANTITY
"O" RING,FLOAT BALL (Ref # 11009)	16019-024	1
PLATE,STAY (Ref # 11034)	11034-1826	1
HOLDER,NEEDLE JET (Ref # 13091)	13091-1050	1
CAM,CHOKE LINK (Ref # 13169)	13169-1303	1
CARBURETOR ASSY (Ref # 16001)	16001-1160	1
TOP,MIXING CHAMBER (Ref # 16005)	16005-1001	1
COLLAR (Ref # 16007)	16007-1001	1
JET NEEDLE,N05A (Ref # 16009)	16009-1054	1
CAP,RUBBER (Ref # 16012)	16012-1001	1
SCREW,PILOT ADJUST (Ref # 16014)	16014-1029	1
NEEDLE JET (Ref # 16017)	16017-1052	1
SCREW,THROTTLE STOP (Ref # 16021)	16021-1031	1
VACUUM,VALVE (Ref # 16028)	16126-1042	1
FLOAT VALVE (Ref # 16030)	16030-1007	1
FLOAT (Ref # 16031)	16031-1001	1
HOLDER,CARBURETOR (Ref # 16065)	16065-1028	1
SCREW,PLUG (Ref # 92009)	92009-1004	1
SCREW,DRAIN (Ref # 92009A)	92009-1095	1
WASHER,PLAIN (Ref # 92022)	92022-1003	1
WASHER,PLAIN (Ref # 92022A)	92022-1209	1
CLIP,FLOAT VALVE (Ref # 92037)	16044-007	1
CIRCLIP (Ref # 92037A)	92037-1005	1
CLAMP,CARBURETOR (Ref # 92037B)	92037-1021	1
CLAMP,TUBE,OVERFLOW (Ref # 92037C)	92037-1142	1
CLAMP,TUBE (Ref # 92037D)	92037-1682	1
FLOAT PIN (Ref # 92043)	92043-1002	1
O RING,PILOT ADJ (Ref # 92055)	92055-1002	1
"O" RING,DRAIN SCREW (Ref # 92055A)	92055-1053	1
HOSE,FUEL INLET (Ref # 92059)	92059-1001	1

1981 KZ250 PARTS LIST

CARBURETOR ('81 D2)

ITEM NAME	PART NUMBER	QUANTITY
HOSE,FUEL OVERFLOW (Ref # 92059A)	92059-1046	1
NOZZLE,MAIN (Ref # 92062)	92062-1001	1
MAIN JET,2ND,#95 (Ref # 92063)	92063-1001	1
MAIN JET,#92,2ND (Ref # 92063A)	92063-1004	1
MAIN JET,#2ND,#98 (Ref # 92063B)	92063-1005	1
MAIN JET,#100 (Ref # 92063C)	92063-1008	1
MAIN JET,PRI,#68 (Ref # 92063D)	92063-1050	1
MAIN JET,2ND,#102 (Ref # 92063E)	92063-1090	1
PILOT JET,#35 (Ref # 92064)	92064-1001	1
PLUG,PILOT SCREW (Ref # 92066)	92066-1051	1
SPRING (Ref # 92081)	92081-1001	1
SPRING,PIROT ADJ SCRW (Ref # 92081A)	92081-1002	1
SPRING (Ref # 92081B)	92081-1004	1
SPRING,STOP SCREW (Ref # 92081C)	92081-1062	1
SCREW PAN HEAD 4X8 (Ref # 220)	220B0408	1
SCREW-PAN-CRROSS,4X12 (Ref # 220A)	220B0412	1
SCREW PAN HEAD 5X20 (Ref # 220B)	220B0520	1
SCREW PAN HEAD 6X14 (Ref # 220C)	220B0614	1
NUT,5MM (Ref # 311)	311B0500	1
WASHER SPRING 4MM (Ref # 461)	461F0400	1
WASHER SPRING 5MM (Ref # 461A)	461F0500	1
BALL,STEEL,1/8" (Ref # 600)	600A0400	1