

1976 KE125 PARTS DIAGRAM

CHASSIS ELECTRICAL EQUIPMENT ('76-'79)

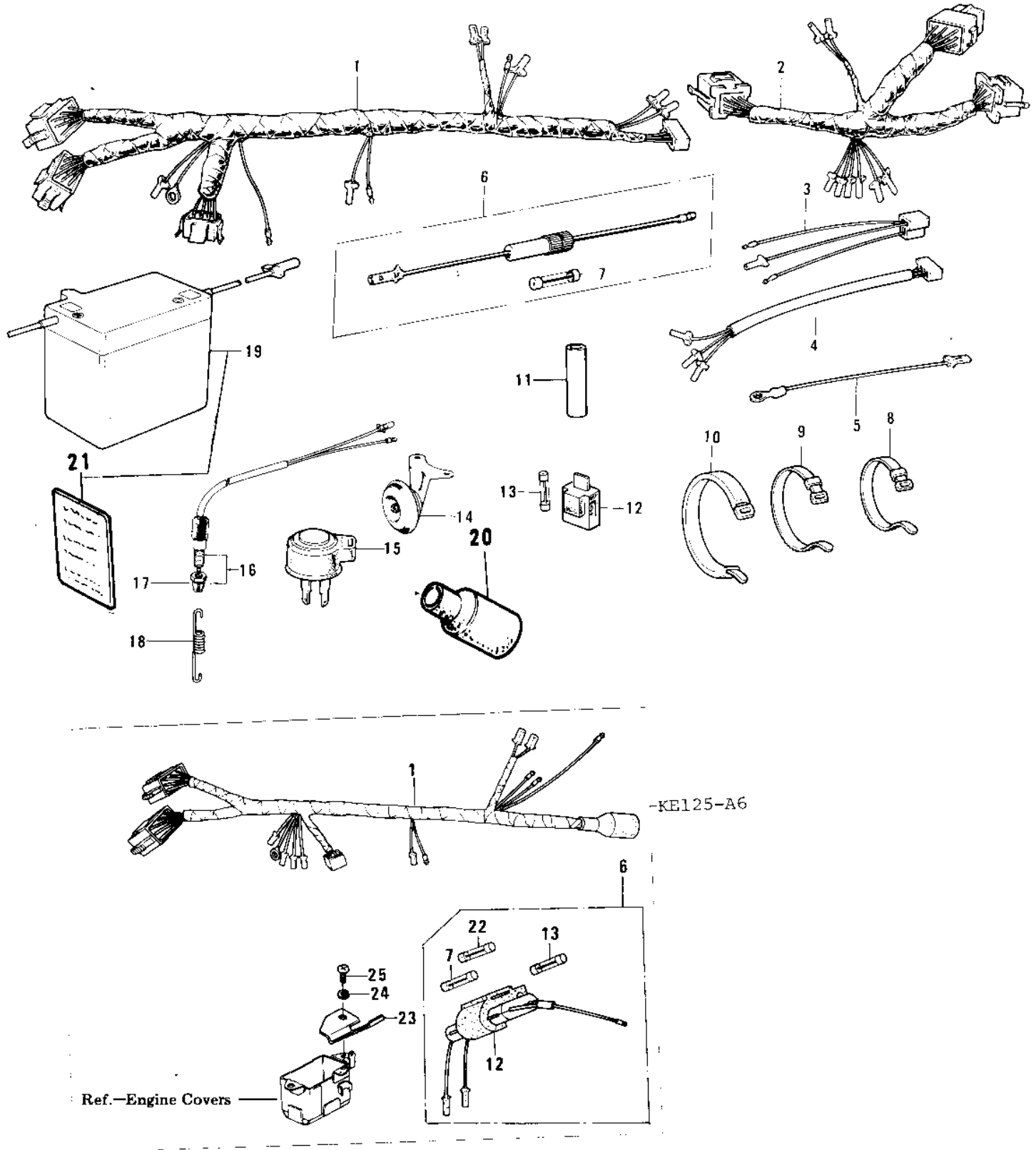

1976 KE125 PARTS LIST

CHASSIS ELECTRICAL EQUIPMENT ('76-'79)

ITEM NAME	PART NUMBER	QUANTITY
WIRING HARNESS,MAIN (Ref # 1)	26001-108	1
WIRING HARNESS,MAIN (Ref # 1)	26001-1070	1
WIRING HARNESS,HDLMP (Ref # 2)	26002-045	1
WIRE,RECTIFIER LEAD (Ref # 3)	26011-072	1
WIRING HARNESS,TL LMP (Ref # 4)	26002-046	1
WIRE,LEAD (Ref # 5)	26011-093	1
FUSE ASSY (Ref # 6)	26004-025	1
FUSE ASSY (Ref # 6)	26004-1010	1
FUSE 15A (Ref # 7)	26006-007	2
FUSE,10A-R (Ref # 7)	26006-1007	1
BAND,SHORT (Ref # 8)	92072-030	1
BAND,LONG (Ref # 9)	92072-032	1
BAND,WIRING HARNESS (Ref # 10)	92072-068	1
DAMPER RUBBER,HARNESS (Ref # 11)	92075-250	1
HOLDER-SPARE FUSE (Ref # 12)	26016-004	1
DAMPER RUBBER (Ref # 12)	92075-1044	1
FUSE,15A,L=30M/M (Ref # 13)	26006-1003	1
HORN (Ref # 14)	27003-044	1
RELAY-TURN SIGNAL (Ref # 15)	27002-013	1
SWITCH,BRAKE LIGHT (Ref # 16)	27010-025	1
NUT,BRAKE LAMP SWITCH (Ref # 17)	27037-001	1
SPRING BRAKE LAMP SW (Ref # 18)	27011-006	1
YUA BAT 6N6-1D-2 (Ref # 19)	K26012-034	2
COVER,WIRING HARNESS (Ref # 20)	26009-008	1
LABEL-WARNING,BATTERY (Ref # 21)	56040-1036	1
FUSE,10A,L=30M/M (Ref # 22)	26006-1002	1
BRACKET,FUSE (Ref # 23)	11034-1368	1
WASHER SPRING 5MM (Ref # 24)	461F0500	1
SCREW PAN HEAD 5X10 (Ref # 25)	220B0510	1