

1972 PARTS DIAGRAM

SWING ARM/SHOCK ABSORBERS ('76-'80)

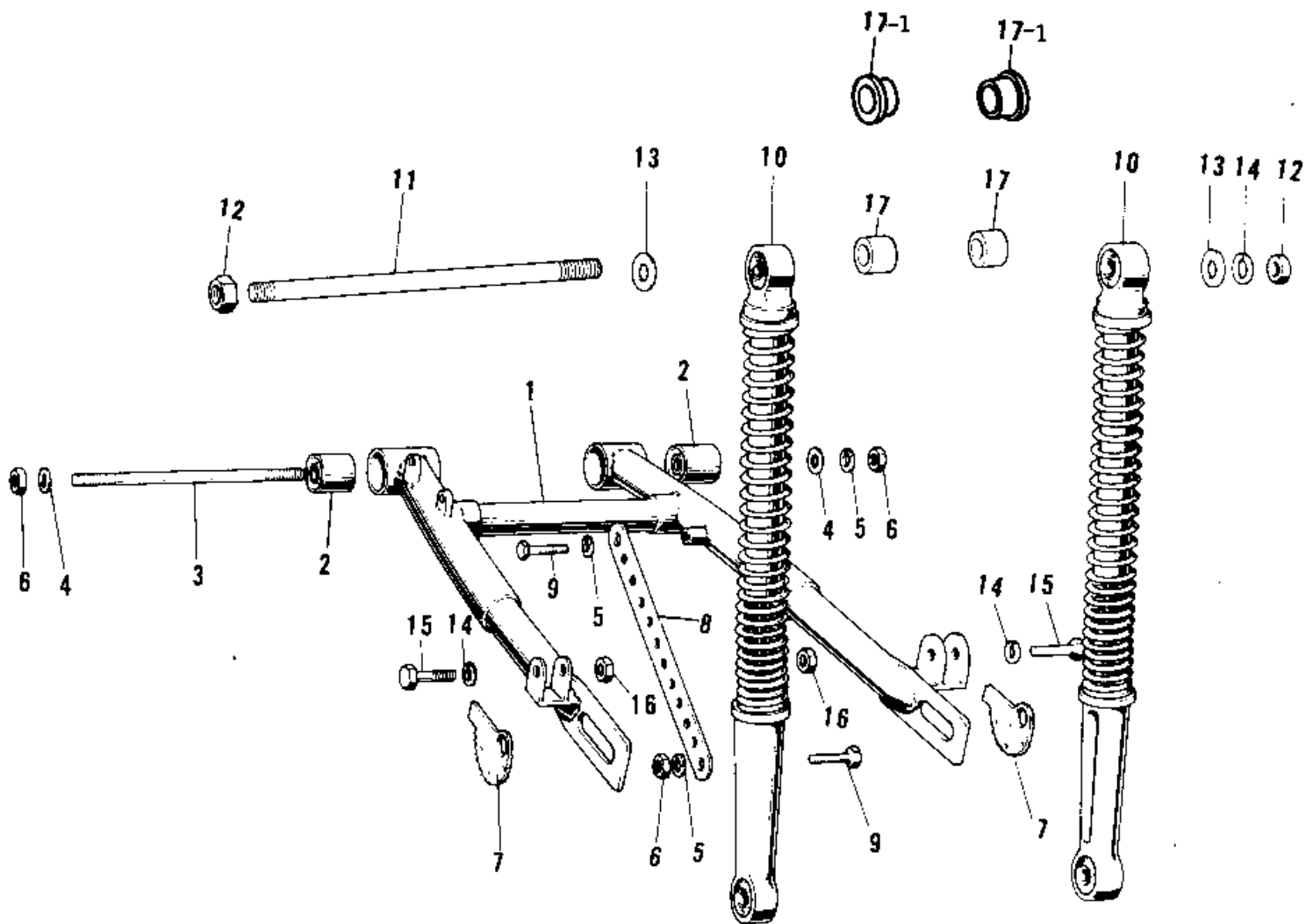

1972 PARTS LIST

SWING ARM/SHOCK ABSORBERS ('76-'80)

| ITEM NAME | PART NUMBER | QUANTITY |
|---------------------------------|-------------|----------|
| ARM-SWING (Ref # 1) | 33001-037 | 1 |
| BUSH SWING ARM SHAFT (Ref # 2) | 92092-006 | 1 |
| SHAFT SWING ARM PIVOT (Ref # 3) | 33032-008 | 1 |
| WASHER PLAIN 10MM (Ref # 4) | 410B1000 | 1 |
| WASHER SPRING 10MM (Ref # 5) | 461F1000 | 1 |
| NUT,10MM (Ref # 6) | 314B1000 | 1 |
| ADJUSTER-CHAIN (Ref # 7) | 33040-042 | 1 |
| TORQUE LINK-REAR BRK (Ref # 8) | 43007-025 | 1 |
| BOLT,HEX HEAD,10X18 (Ref # 9) | 113G1018 | 1 |
| SHOCK ABSBR RR (Ref # 10) | 45014-065 | 1 |
| SHOCK ABSBR RR (Ref # 10) | 45014-1014 | 1 |
| STUD,12MM (Ref # 11) | 92006-006 | 1 |
| NUT-HEX-FINE (Ref # 12) | 314B1200 | 2 |
| WASHER PLAIN 12MM (Ref # 13) | 411B1200 | 1 |
| WASHER SPRING 12MM (Ref # 14) | 461F1200 | 1 |
| BOLT-HEX HEAD,12X36 (Ref # 15) | 113B1236A | 1 |
| NUT-HEX-FINE,12MM (Ref # 16) | 315B1200 | 1 |
| COLLAR (Ref # 17) | 92027-257 | 1 |
| COLLAR,REAR SHOCK (Ref # 17-1) | 92027-1050 | 1 |