

1980 Invader 340 PARTS DIAGRAM

CONTROLS & SWITCHES

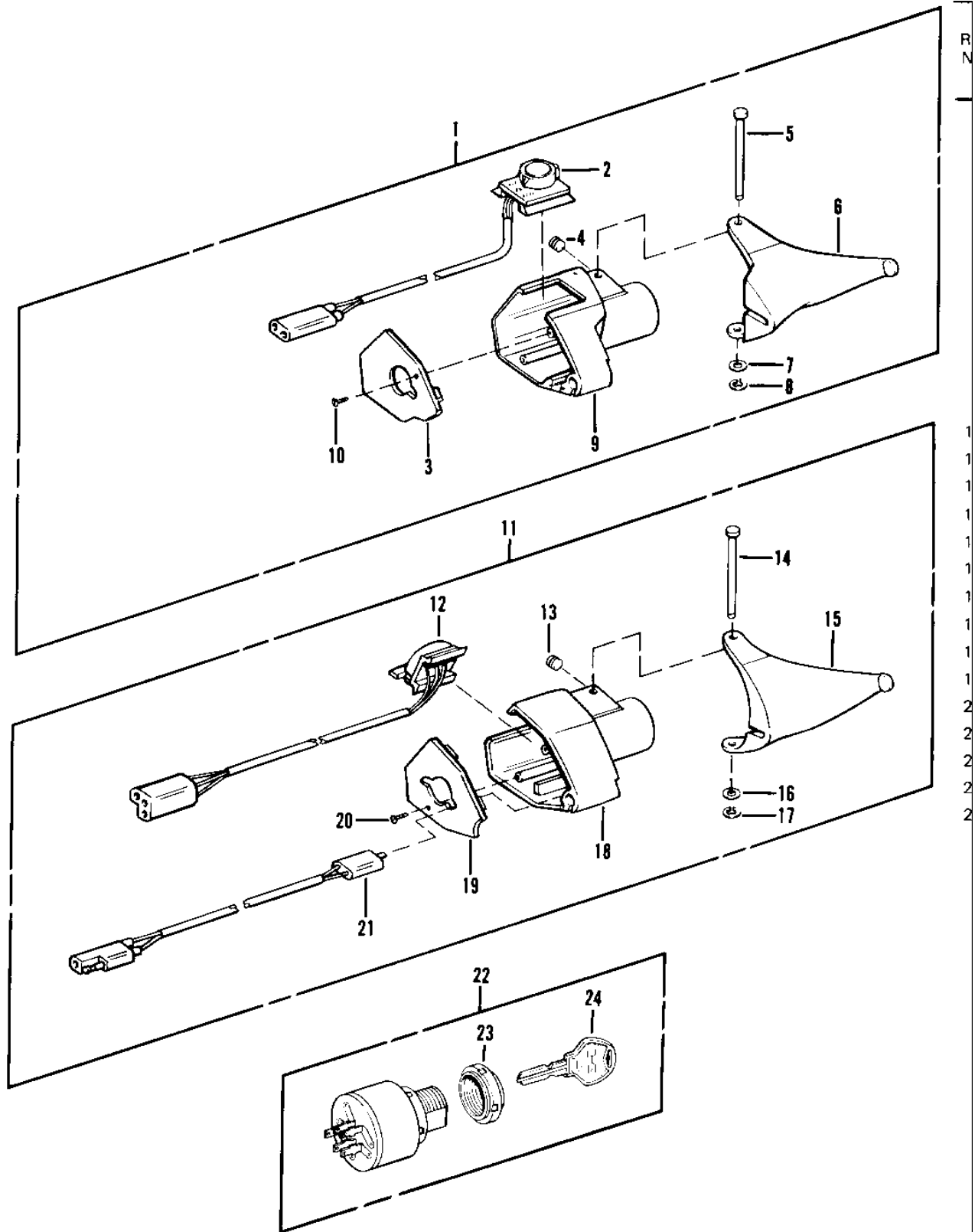

1980 Invader 340 PARTS LIST

CONTROLS & SWITCHES

ITEM NAME	PART NUMBER	QUANTITY
LEVER-ASSY-THROTTLE (Ref # 1)	39074-3505	1
.SWITCH-EMERG STOP (Ref # 2)	27010-3507	1
.PLATE-THROTTLE CASE (Ref # 3)	13169-3510	1
.SCREW (Ref # 4)	92009-3520	2
.PIN-BRAKE LEVER (Ref # 5)	92043-3526	2
.LEVER-THROTTLE (Ref # 6)	39075-3506	1
.WASHER (Ref # 7)	92022-3517	2
.RING-SNAP (Ref # 8)	92033-3505	2
.CASE-THROTTLE (Ref # 9)	32099-3502	1
.SCREW (Ref # 10)	92009-3524	2
LEVER-ASSY-BRAKE (Ref # 11)	43077-3502	1
.SWITCH-DIMMER (Ref # 12)	27010-3508	1
.LEVER-BRAKE (Ref # 15)	43001-3501	1
.CASE-BRAKE (Ref # 18)	32099-3501	1
.PLATE-BRAKE CASE (Ref # 19)	13169-3509	1
.SWITCH-BRAKE LIGHT (Ref # 21)	27010-3505	1
SWITCH-ASSY-KEY (Ref # 22)	27005-3501	1
.NUT (Ref # 23)	92015-3509	1
.KEY NO. (Ref # 24)		1
..KEY SET #20 SET OF 2 (Ref # 24)	27008-3501	1
..KEY SET #21 SET OF 2 (Ref # 24)	27008-3502	1
..KEY SET #22 SET OF 2 (Ref # 24)	27008-3503	1
..KEY SET #23 SET OF 2 (Ref # 24)	27008-3504	1
..KEY SET #24 SET OF 2 (Ref # 24)	27008-3505	1
..KEY SET #25 SET OF 2 (Ref # 24)	27008-3506	1
..KEY SET #26 SET OF 2 (Ref # 24)	27008-3507	1
..KEY SET #27 SET OF 2 (Ref # 24)	27008-3508	1
..KEY SET #28 SET OF 2 (Ref # 24)	27008-3509	1
..KEY SET #29 SET OF 2 (Ref # 24)	27008-3510	1

1980 Invader 340 PARTS LIST

CONTROLS & SWITCHES

ITEM NAME	PART NUMBER	QUANTITY
..KEY SET #30 SET OF 2 (Ref # 24)	27008-3511	1
..KEY SET #31 SET OF 2 (Ref # 24)	27008-3512	1