

## 1979 Drifter 340 PARTS DIAGRAM

STEERING

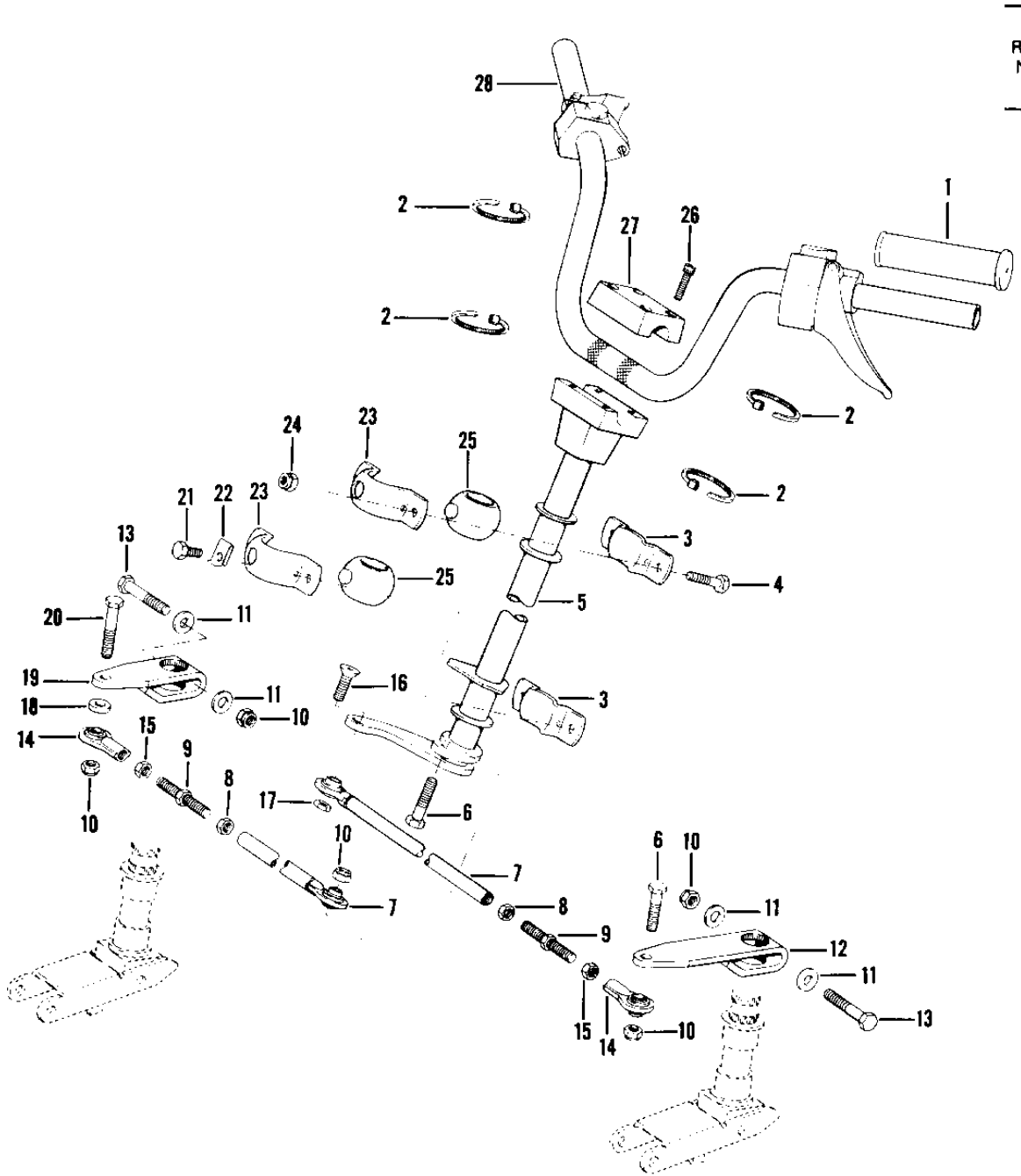

SA340-A3/SB440-A3

## 1979 Drifter 340 PARTS LIST

### STEERING

| ITEM NAME                        | PART NUMBER | QUANTITY |
|----------------------------------|-------------|----------|
| GRIP-HANDLE BAR (Ref # 1)        | 46075-3501  | 1        |
| BAND (Ref # 2)                   | 92072-3505  | 1        |
| BRACKET-STEERING-LOW (Ref # 3)   | 11034-3523  | 1        |
| BOLT (Ref # 4)                   | 118BA1012   | 1        |
| POLE-STEERING \$\$ (Ref # 5)     | 090725      | 1        |
| BOLT (Ref # 6)                   | 119BA1224   | 1        |
| ROD-TIE-COMP (Ref # 7)           | 39111-3510  | 1        |
| NUT (Ref # 8)                    | 344BA1200   | 1        |
| STUD (Ref # 9)                   | 92004-3502  | 1        |
| NUT (Ref # 10)                   | 350BA1200   | 1        |
| WASHER (Ref # 11)                | 412EA1200   | 1        |
| ARM-STEERING LH (Ref # 12)       | 39006-3508  | 1        |
| BOLT (Ref # 13)                  | 119BA1236   | 1        |
| ROD-TIE-END LH FEMALE (Ref # 14) | 39112-3506  | 1        |
| NUT (Ref # 15)                   | 92015-3510  | 1        |
| SCREW (Ref # 16)                 | 92009-3539  | 1        |
| NUT (Ref # 17)                   | 92015-3527  | 1        |
| SPACER (Ref # 18)                | 92026-3537  | 1        |
| ARM-STEERING RH (Ref # 19)       | 39006-3509  | 1        |
| BOLT (Ref # 20)                  | 119BA1222   | 1        |
| BOLT (Ref # 21)                  | 92001-3517  | 1        |
| WASHER (Ref # 22)                | 92022-3514  | 1        |
| BRACKET-STEERING-UPS (Ref # 23)  | 11034-3524  | 1        |
| NUT (Ref # 24)                   | 351BA1000   | 1        |
| DAMPER-STEERING (Ref # 25)       | 090700      | 1        |
| SCREW (Ref # 26)                 | 92009-3510  | 1        |
| HOLDER-HANDLE (Ref # 27)         | 46012-3504  | 1        |
| HANDLE-BAR (Ref # 28)            | 090708      | 1        |