

## 1986 KX™250 PARTS DIAGRAM

CRANKCASE

E1411-0145

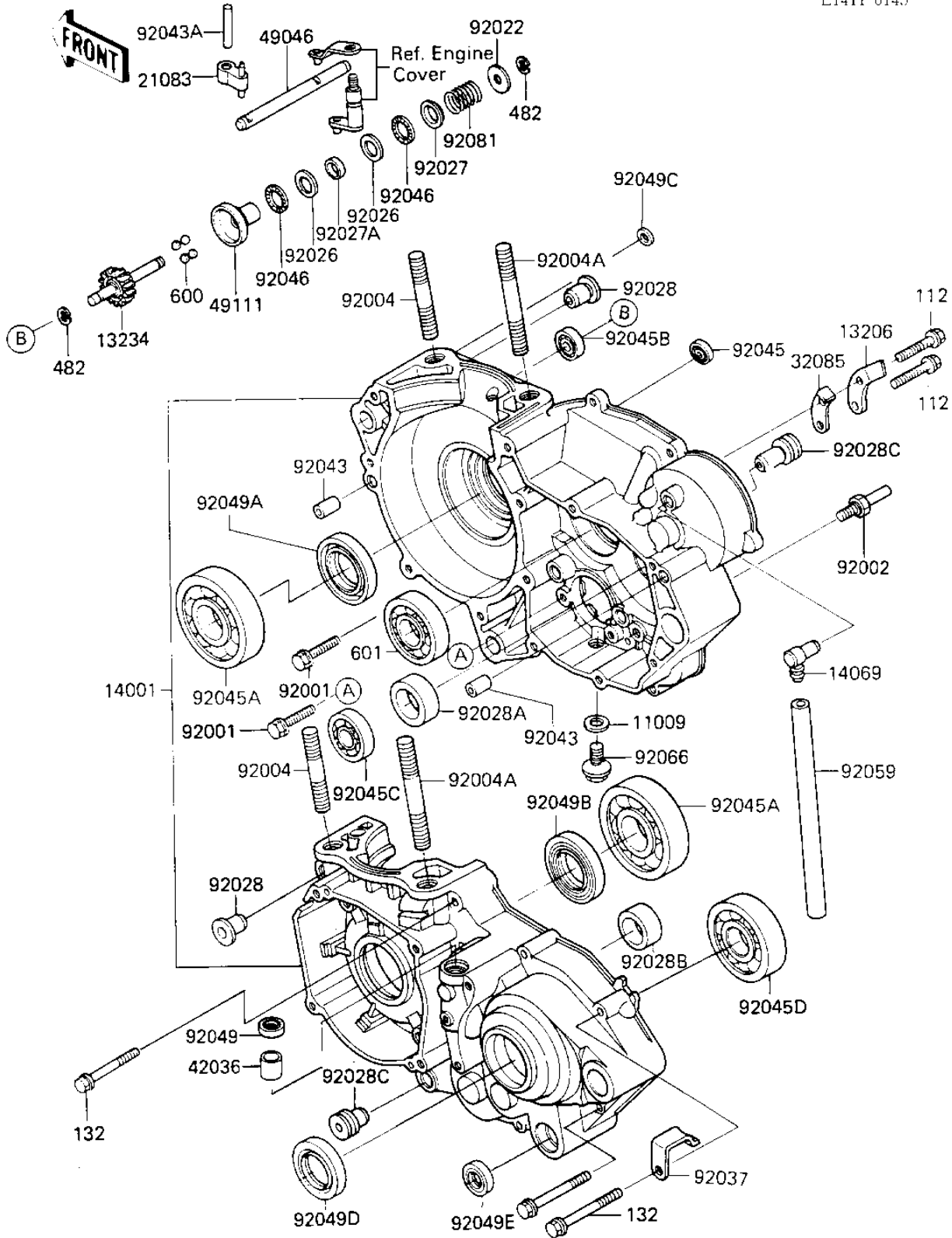

## 1986 KX™250 PARTS LIST

### CRANKCASE

ITEM NAME	PART NUMBER	QUANTITY
GASKET CHECK VALVE (Ref # 11009)	92065-058	1
GUIDE-KICK (Ref # 13206)	13206-1052	1
SHAFT-COMP,GOVERNOR (Ref # 13234)	13234-1061	1
SET-CRANKCASE (Ref # 14001)	14001-5206	1
BREATHER (Ref # 14069)	14069-003	1
ARM (Ref # 21083)	21083-1058	1
STOPPER,KICKSTARTER (Ref # 32085)	32085-1016	1
SLEEVE (Ref # 42036)	42036-1177	1
ROD-GOVERNOR (Ref # 49046)	49046-1055	1
HOLDER-GOVERNOR WEIG (Ref # 49111)	49111-1051	1
BOLT,W/WASHER,6X14 (Ref # 92001)	92001-1829	1
BOLT,8X15 (Ref # 92002)	92002-1601	1
STUD,10X35 (Ref # 92004)	92004-1063	1
STUD,10X45 (Ref # 92004A)	92004-1065	1
WASHER,8.3X28X1.6 (Ref # 92022)	92022-1634	1
SPACER,15X28X1 (Ref # 92026)	92026-1238	1
COLLAR (Ref # 92027)	92027-1838	1
COLLAR,15.2X17X4 (Ref # 92027A)	92027-1839	1
BUSHING,CRANKCASE (Ref # 92028)	92028-1133	1
BUSHING (Ref # 92028A)	92028-131	1
BUSHING (Ref # 92028B)	92028-132	1
BUSHING (Ref # 92028C)	92028-1366	1
CLAMP,HARNESS (Ref # 92037)	92037-1318	1
PIN-DOWEL (Ref # 92043)	92042-007	1
PIN,4X32 (Ref # 92043A)	92043-1258	1
BEARING-BALL (Ref # 92045)	92045-1211	1
BEARING,BALL,#6305SH (Ref # 92045A)	92045-1024	1
BEARING-BALL (Ref # 92045B)	92045-1212	1
BEARING-BALL,6905Z (Ref # 92045C)	92045-1058	1

## 1986 KX™250 PARTS LIST

### CRANKCASE

ITEM NAME	PART NUMBER	QUANTITY
BEARING-BALL,6205 (Ref # 92045D)	92045-1115	1
BEARING-NEEDLE,AXK11 (Ref # 92046)	92046-1052	1
OIL SEAL SB12205 (Ref # 92049)	92049-004	1
OIL SEAL,TCJ25457 (Ref # 92049A)	92049-1051	1
OIL SEAL,TCJ20407 (Ref # 92049B)	92049-1052	1
SEAL-OIL,SD08144 (Ref # 92049C)	92049-1207	1
OIL SEAL TB3040 (Ref # 92049D)	92050-033	1
OIL SEAL,TB13225.5 (Ref # 92049E)	92051-005	1
PIPE-BREATHER (Ref # 92059)	92059-061	1
PLUG (Ref # 92066)	92066-1241	1
SPRING,GOVERNOR (Ref # 92081)	92081-1934	1
BOLT-UPSET (Ref # 112)	112G0618	1
BOLT-FLANGED-SMALL (Ref # 132)	132G0640	1
CIRCLIP 6MM (Ref # 482)	482J6000	1
BALL STEEL 5/16" (Ref # 600)	600A1000	1
BEARING BALL #6204 (Ref # 601)	601B6204	1