

## 1986 KX™125 PARTS DIAGRAM

CLUTCH

E1350-0106

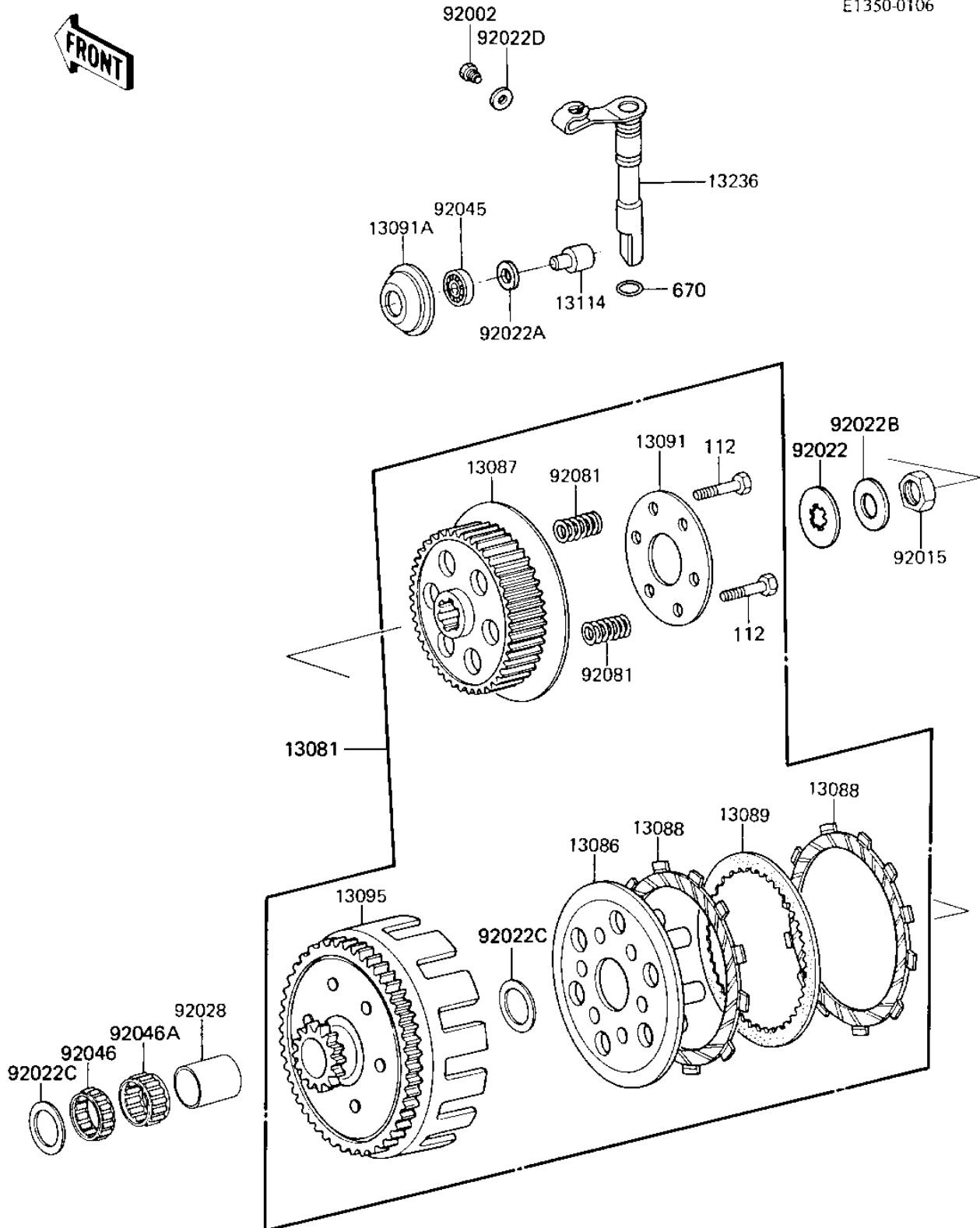

## 1986 KX™125 PARTS LIST

### CLUTCH

ITEM NAME	PART NUMBER	QUANTITY
CLUTCH-ASSY (Ref # 13081)	13081-1187	1
WHEEL-CLUTCH (Ref # 13086)	13086-1056	1
HUB-CLUTCH (Ref # 13087)	13087-1060	1
PLATE-FRICTION (Ref # 13088)	13088-1058	1
PLATE-CLUTCH (Ref # 13089)	13089-1063	1
HOLDER,CLUTCH (Ref # 13091)	13091-1011	1
HOLDER,CLUTCH PUSHER (Ref # 13091A)	13091-1134	1
HOUSING-COMP-CLUTCH (Ref # 13095)	13095-1117	1
PUSHER,CLUTCH (Ref # 13114)	13114-1008	1
LEVER-COMP,CLUTCH RE (Ref # 13236)	13236-1121	1
BOLT (Ref # 92002)	92002-1706	1
NUT,16MM (Ref # 92015)	92015-1549	1
WASHER,LOCK (Ref # 92022)	92022-1124	1
WASHER,7X12.5X0.8 (Ref # 92022A)	92022-1290	1
WASHER,16.3X29X1.75 (Ref # 92022B)	92022-1356	1
WASHER,17.3X30X1.4 (Ref # 92022C)	92022-1761	1
WASHER,PLAIN (Ref # 92022D)	92022-304	1
BUSHING,17X22X24.7 (Ref # 92028)	92028-1325	1
BEARING,BALL #627 (Ref # 92045)	92045-026	1
BEARING-NEEDLE,K22X2 (Ref # 92046)	92046-1129	1
BEARING-NEEDLE,K22X2 (Ref # 92046A)	92046-1130	1
SPRING,CLUTCH (Ref # 92081)	92081-1637	1
BOLT (Ref # 112)	110G0520	1
"O" RING,9MM (Ref # 670)	670B1509	1