

## 1983 KDX™250 PARTS DIAGRAM

TRANSMISSION

E1361-0134

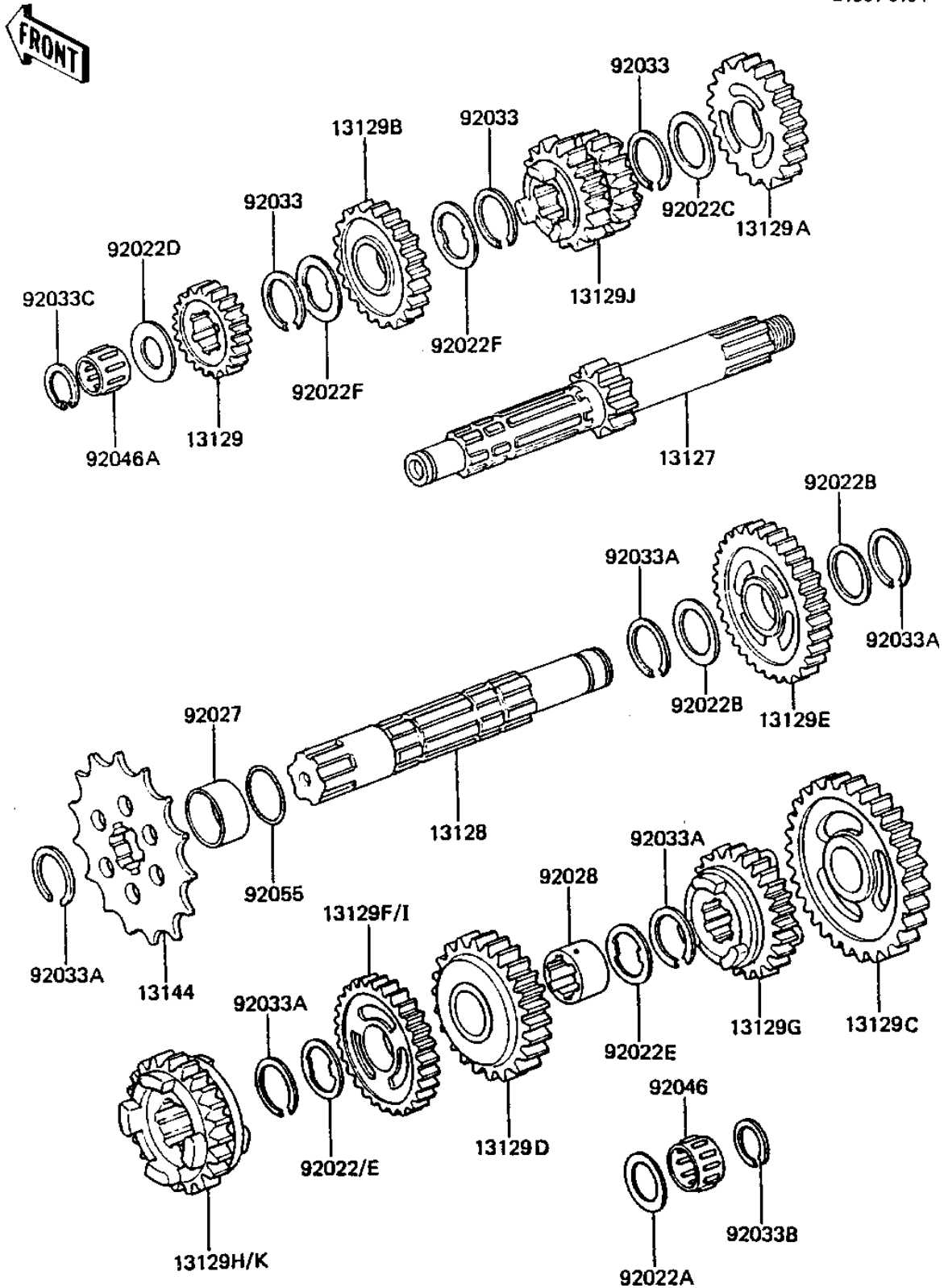

## 1983 KDX™250 PARTS LIST

### TRANSMISSION

ITEM NAME	PART NUMBER	QUANTITY
SHAFT-TRANSMISSION IN (Ref # 13127)	13127-1065	1
OUTPUT SHAFT (Ref # 13128)	13128-1029	1
GEAR,4TH (Ref # 13129)	13129-1226	1
GEAR,5TH (Ref # 13129A)	13129-1227	1
GEAR,TOP (Ref # 13129B)	13129-1228	1
GEAR,LOW (Ref # 13129C)	13129-1229	1
GEAR,2ND (Ref # 13129D)	13129-1230	1
GEAR,4TH (Ref # 13129E)	13129-1232	1
GEAR,OUTPUT 3RD (Ref # 13129F)	13129-5001	1
GEAR,OUTPUT 57H,20T (Ref # 13129G)	13129-1352	1
GEAR,OUTPUT TOP (Ref # 13129H)	13129-5002	1
GEAR,INPUT 2ND&3RD (Ref # 13129J)	13129-1599	1
ENGINE SPROCKET,14T (Ref # 13144)	13144-1006	1
WASHER,LOCK,30X1.0T (Ref # 92022)	92022-1072	1
WASHER THRUST (Ref # 92022A)	92022-112	1
WASHER-PLAIN 25MM (Ref # 92022B)	92022-159	1
WASHER-PLAIN (Ref # 92022C)	92022-198	1
WASHER,PLAIN (Ref # 92022D)	92022-281	1
WASHER-LOCK (Ref # 92022E)	92024-038	1
WASHER-LOCK (Ref # 92022F)	92024-039	1
COLLAR-ENG SPROKET (Ref # 92027)	92027-163	1
BUSHING,OUTPUT GEAR (Ref # 92028)	92028-1268	1
CIRCLIP,25MM (Ref # 92033)	92033-025	1
CIRCLIP (Ref # 92033A)	92033-026	1
CIRCLIP,18MM (Ref # 92033B)	92033-029	1
CIRCLIP,16MM (Ref # 92033C)	92033-032	1
BEARING-NEEDLE,KT2026 (Ref # 92046)	92046-1170	1
BEARING-NEEDLE (Ref # 92046A)	92046-1184	1
"O" RING (Ref # 92055)	92055-035	1